

**Amendment No. 89/051**  
**Bylaw No. 83Z89**  
**Council Approval: 17 July 1989**

**SCHEDULE B**

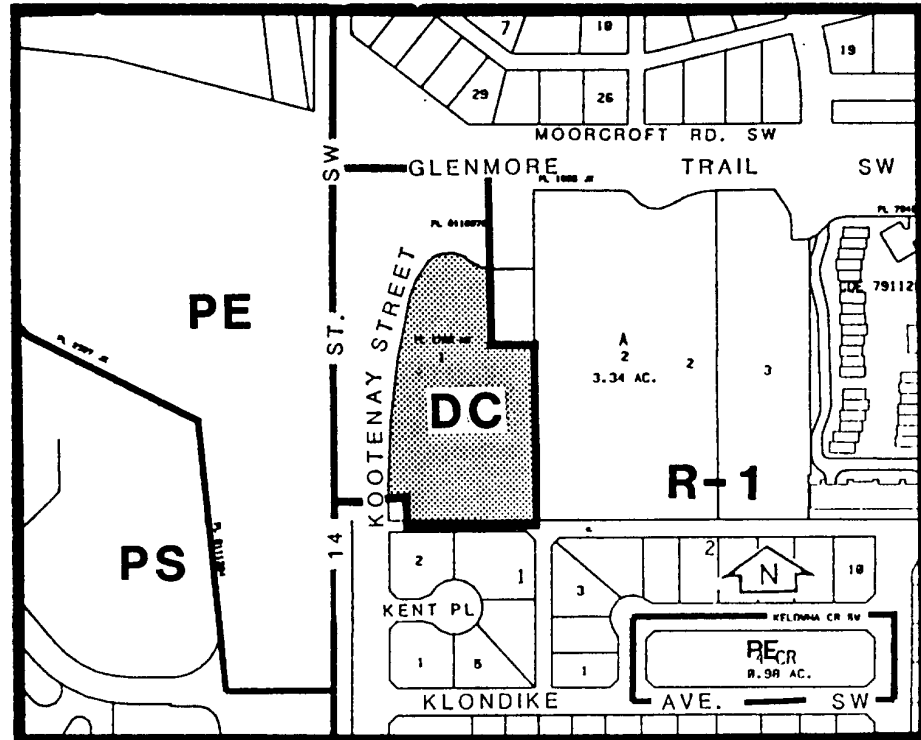

1. Land Use

The land use shall be for eight comprehensively designed semi-detached dwellings.

2. Development Guidelines

The General Rules for Residential Districts contained in Section 20 of By-law 2P80 and the Permitted and Discretionary Use Rules of the RM-1 District shall apply unless otherwise noted below:

a) Density

A maximum of 16 dwelling units.

b) Development Plans

Approval of this application does not constitute approval of a development permit. Comprehensive plans, including building design, site layout, exterior finishes and colour, landscaping, parking and accesses shall subsequently be submitted to the

Approving Authorities as part of a development permit application. In considering such an application, the Approving Authorities shall ensure the building appearance, site layout and density conform substantially to the plans and renderings submitted to City Council during their consideration of the By-law.