

Amendment No. 91/050
Bylaw No. 52Z91
Council Approval: 09 September 1991

SCHEDULE B

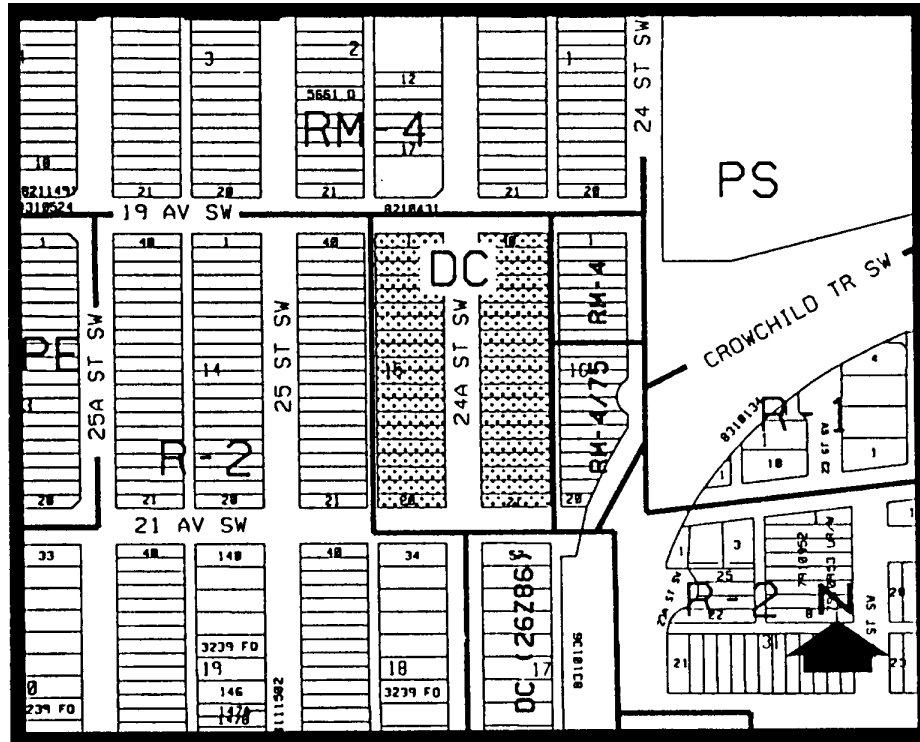

1. Land Use

The Permitted and Discretionary uses of the R-2 (Residential Low Density District) shall be permitted and discretionary uses respectively.

2. Development Guidelines

a. The General Rules for Residential Districts contained in Section 20 of By-law 2P80 and the Permitted and Discretionary Use Rules of the R-2 (Residential Low Density District) shall apply unless otherwise noted below:

i. Lot Width - Single-detached

A minimum width of 11 metres except a minimum width of 7.5 metres where the lot forms part of a plan of subdivision approved by the Calgary Planning Commission prior to the date of approval of this by-law.

ii. Lot Area - Single-detached

A minimum lot area of 348 square metres except a minimum lot area of 233 square metres where the lot forms part of a subdivision approved by the Calgary Planning Commission prior to the date of approval of this by-law.

b. Development Plans

Comprehensive plans, including building design, site layout, exterior finishes and colour, landscaping, parking and accesses shall subsequently be submitted to the Approving Authorities as part of the development permit application.