

Amendment No. 94/089
Bylaw No. 40Z95
Council Approval: 26 June 1995

SCHEDULE B

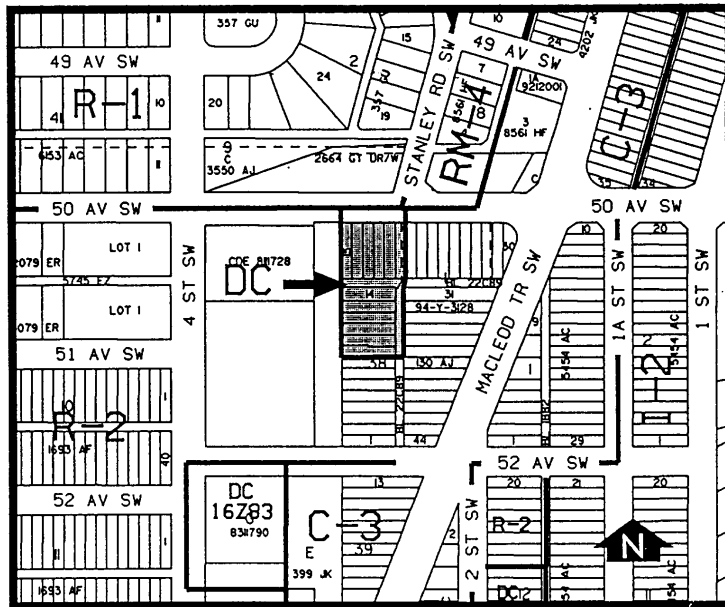

1. Land Use

The Permitted and Discretionary Uses of the C-2(12) General Commercial District shall be the permitted and discretionary uses respectively.

2. Development Guidelines

The General Rules for Commercial Districts contained in Section 33 of By-law 2P80 and the Permitted and Discretionary Use Rules of the C-2(12) District shall apply unless otherwise noted below.

a. Vehicular Access and Egress

No direct vehicular access or egress shall be permitted to or from 50 Avenue S.W.

b. Development Plans

Approval of this application does not constitute approval of a development permit. Comprehensive plans shall be submitted to the Approving Authority as part of a development permit application.