

**Amendment No. 96/068**  
**Bylaw No. 94Z96**  
**Council Approval: 15 October 1996**

**SCHEDULE B**

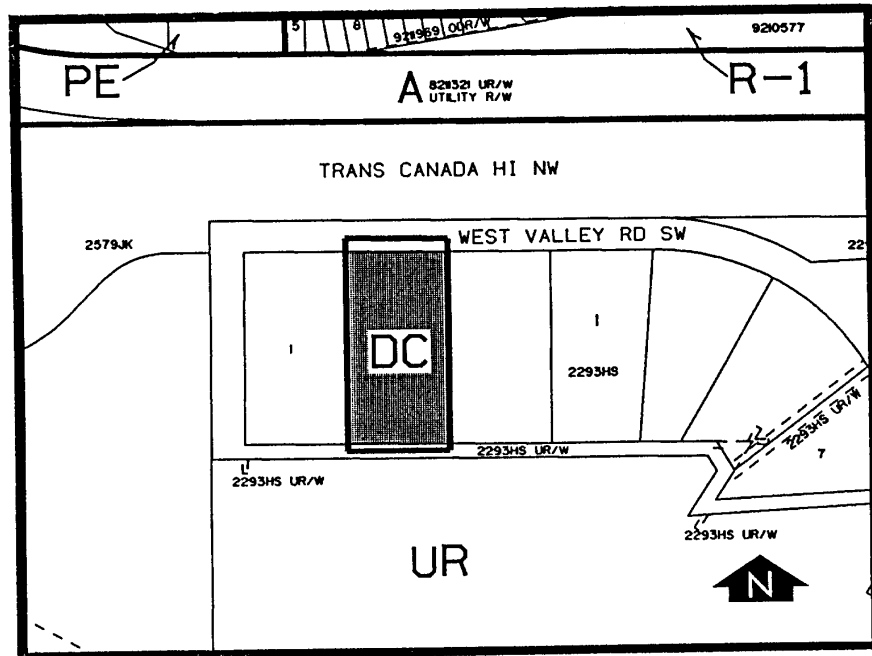

1. Land Use

The discretionary land use shall be for a comprehensively designed wedding and reception facility only.

2. Development Guidelines

The General Rules for commercial districts contained in Section 33 of Bylaw 2P80 and the permitted and discretionary use rules of the C-6 Highway Commercial District shall apply unless otherwise noted below:

a. Density/Site Coverage

Building site coverage shall be not more than 7.5% of the site area.

b. Parking

A minimum of 84 parking stalls shall be provided on site.

c. Landscaping

A minimum of 31.25% of the site area shall be landscaped. All soft landscaped areas shall be irrigated. All landscaped and parking and driving areas shall be separated with concrete curb.

d. Signage

Only one, architecturally compatible with the building, freestanding sign facing Trans Canada Highway shall be allowed on the site. Such sign shall be no higher than 4.5 metres.

e. Development Plans

Approval of this application does not constitute an approval of a development permit. Comprehensive plans including a detailed landscape plan and details of freestanding and building signage, shall be submitted to the Approving Authority as part of a development permit application. In considering such application, the Approving Authority shall ensure that the development plans and renderings are the same or substantially similar to the plans and renderings submitted to City Council during its consideration of the Bylaw.