

Amendment No. 98/038
Bylaw No. 69Z98
Council Approval: 20 July 1998

SCHEDULE B

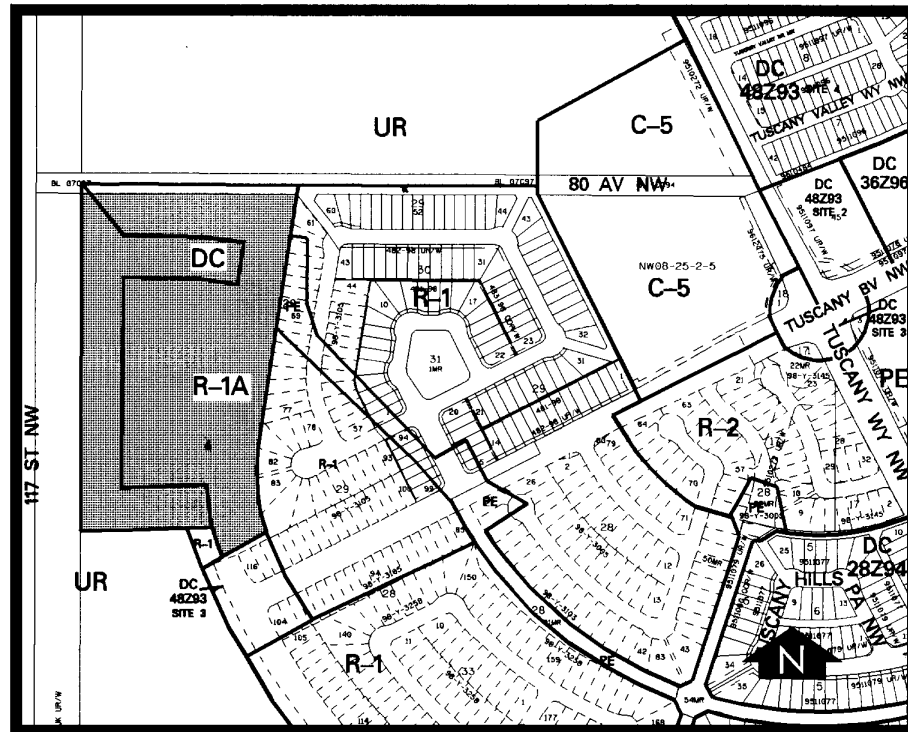

DC DIRECT CONTROL DISTRICT

(1) Land Use

The Permitted and Discretionary Uses of the R1-A Residential Narrow Lot Single-Detached District shall be the Permitted and Discretionary Uses respectively.

(2) Development Guidelines

The General Rules for Residential Districts contained in Section 20 of Bylaw 2P80 and the Permitted and Discretionary Use Rules of the R-1A Residential Narrow Lot Single-Detached District shall apply unless otherwise noted below:

(a) Building Height

A maximum of 10 metres

(b) Development Plans

Development permit requirements for the Permitted and Discretionary Uses of this district shall be subject to Section 8 of Bylaw 2P80.