

**Amendment No. 2000/034**  
**Bylaw No. 130Z2000**  
**Council Approval: 06 November 2000**

**SCHEDULE B**

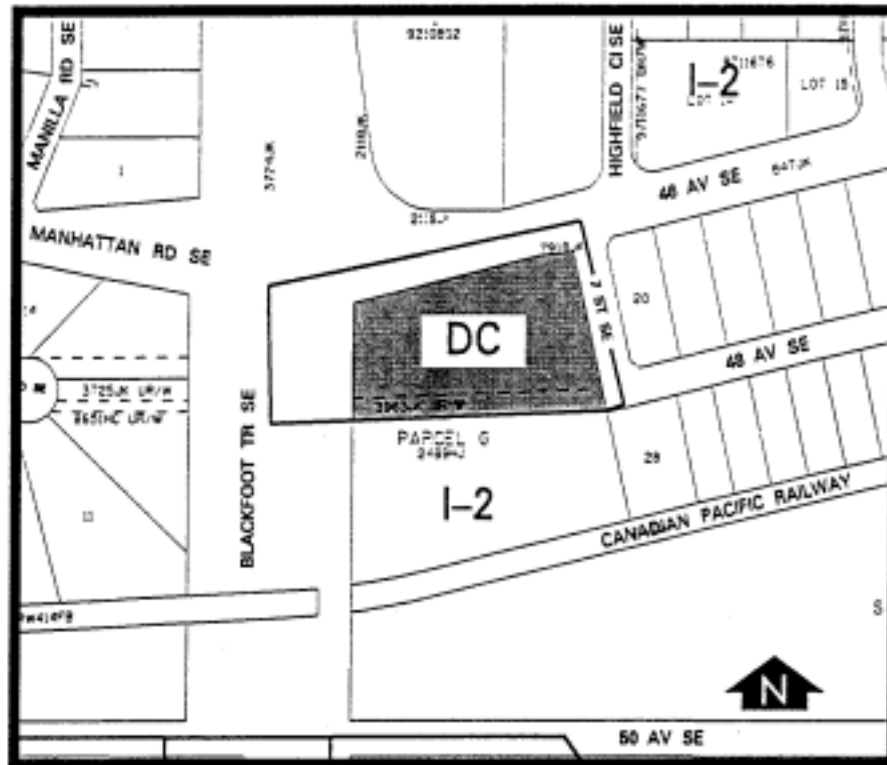

1. Land Use

The Permitted and Discretionary Uses of the C-1A Local Commercial District of Bylaw 2P80 shall be the Permitted and Discretionary Uses respectively.

2. Development Guidelines

The General Rules for Commercial Districts contained in Section 33 of Bylaw 2P80 and the Permitted and Discretionary Use Rules of the C-1A Local Commercial District shall apply unless otherwise noted below:

(a) Landscaping

A minimum of 6.0 metres of landscaping shall be provided adjacent to Blackfoot Trail SE, 46 Avenue SE and 7 Street SE.

(b) Restaurant/Drinking Establishments and Restaurant-Food Service Only

(i) The maximum total gross floor area of all restaurants on the site shall be 640 square metres.

(ii) The maximum gross floor area of any single restaurant on the site shall be 360 square metres.

(c) Access

No direct vehicular access is permitted to or from Blackfoot Trail SE.

(d) Development Plans

Approval of this application does not constitute approval of a Development Permit. Comprehensive plans, including building design, site layout, exterior finishes and colour, landscaping, parking, and accesses, shall be subsequently submitted to the Approving Authority as part of a development permit application.