

Amendment No. 99/094
Bylaw No. 16Z2000
Council Approval: 17 January 2000

SCHEDULE B

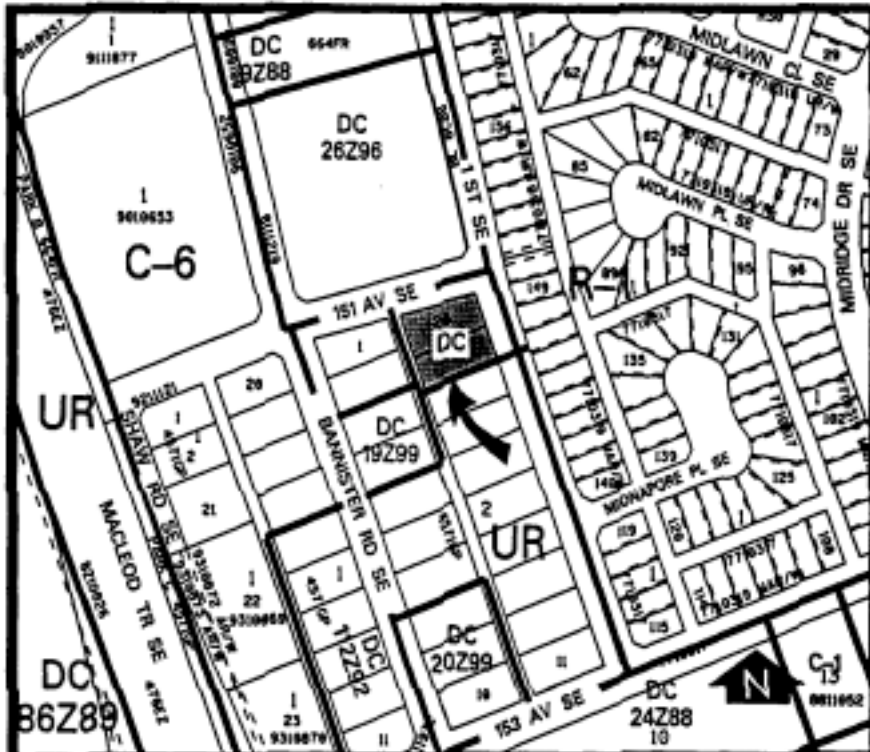

- 1) LAND USE
The Permitted Use shall be an apartment building only.
- 2) DEVELOPMENT GUIDELINES
The General Rules for Residential Districts contained in Section 20 of Bylaw 2P80 and the Permitted and Discretionary Use Rules of the RM-4 Residential Medium Density Multi-Dwelling District shall apply unless otherwise noted below.
 - a) Density
A maximum of 21 dwelling units.
 - b) Parking
The minimum required parking shall be 1.25 stalls per unit for resident parking and 0.15 stalls per unit for visitor parking.

c) Landscaping

A minimum of 50 percent of the site plus all adjoining City boulevards shall be landscaped. A detailed landscaping plan including an inventory of all existing trees and vegetation on site shall be submitted to the Approving Authority as part of a development permit application.

d) Development Plans

Approval of this application does not constitute approval of a development permit. Comprehensive plans shall be submitted to the Approving Authority as part of a development permit application. In considering such an application, the Approving Authority shall ensure the building design and site layout are the same or substantially similar with the plans and renderings submitted to City Council during their consideration of this Bylaw.