

Amendment No. 99/108
Bylaw No. 9Z2000
Council Approval: 23 February 2000

SCHEDULE B

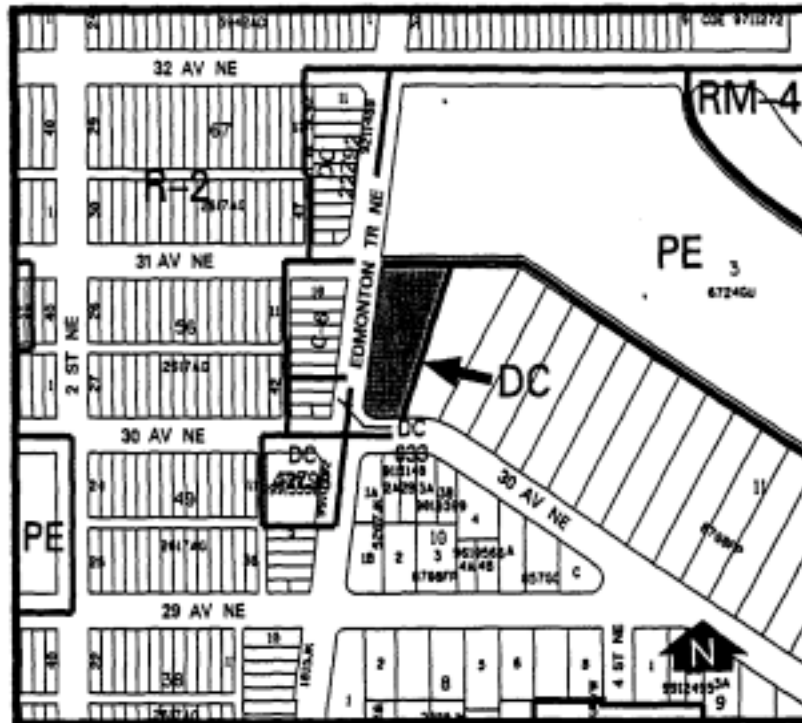

1. Land Use

The Permitted and Discretionary Uses of the RM-4 Residential Medium Density Multi-Dwelling District shall be the Permitted and Discretionary Uses respectively.

2. Development Guidelines

The General Rules for Residential Districts contained in Section 20 of Bylaw 2P80 and the Permitted and Discretionary Use Rules of the RM-4 Residential Medium Density Multi-Dwelling District shall apply unless otherwise noted below.

a) Density

The maximum density shall be 18 units.

b) Parking

Resident parking to a minimum of 30 stalls shall be provided underground and visitor parking shall be provided in a manner satisfactory to the Development Authority,

which obscures parking areas from the view of adjacent residential properties and Edmonton Trail N.E.

c) Development Plans

Approval of this application does not constitute approval of a development permit. Comprehensive plans shall be submitted to the Development Authority as part of a development permit application.