

**Amendment #2001/089  
Bylaw # 120Z2001  
Council Approval: 2001 November 21**

**SCHEDULE B**

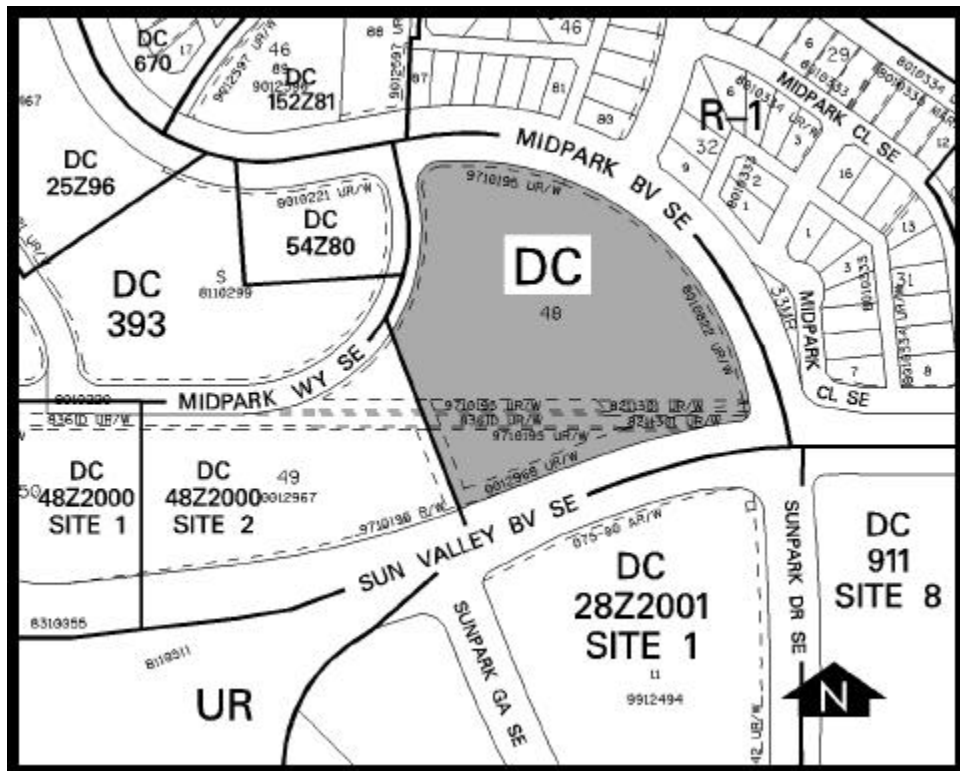

**DC DIRECT CONTROL DISTRICT**

1. Land Uses

The Discretionary uses shall be as follows:

- Assisted living accommodation
- Child care facilities
- Laboratories
- Light manufacturing of materials, goods or products

Mechanical reproduction and printing establishments  
Medical clinics  
Offices  
Parks and playgrounds  
Radio and television studios  
Special care facilities  
Signs - Class 1  
Signs - Class 2 - freestanding identification only  
Utilities

For the purposes of this Bylaw, “assisted living accommodation” means a building which provides for the care of one or more individuals and provides dwelling units that are modified in terms of kitchen and living space as a result of the provision of such facilities and services as communal dining, social/recreational activities and housekeeping within the complex.

2) Development Guidelines

- (a) The General Rules for Residential Districts contained in Section 20 of Bylaw 2P80 and the Permitted and Discretionary Use Rules of the RM-5 Residential Medium Density Multi-Dwelling District shall apply to special care facilities and assisted living accommodation.
- (b) The General Rules for Industrial Districts contained in Section 43 of Bylaw 2P80 and the Permitted and Discretionary Use Rules of the I-2 General Light Industrial District shall apply to all uses except a special care facility or assisted living accommodation unless otherwise noted below:
  - (i) Floor Area Ratio  
A maximum of 3 times the site area.
  - (ii) Site Access  
Vehicular access shall be prohibited to or from Sun Valley Boulevard SE.
  - (iii) Landscaping Screening  
Landscaped berms with trees and/or shrubs shall be provided for the screening of parking areas and outdoor areas of the site from surrounding roads, to the satisfaction of the Approving Authority.
  - (iv) Outside Storage  
Outside storage of materials, goods or products shall be prohibited.
  - (v) Roof Top Mechanical Screening  
All roof top mechanical equipment shall be screened to the satisfaction of the Approving Authority.
  - (vi) Minimum Site Size  
Unless approved by the Calgary Planning Commission, no subdivision less than 0.809 hectares (2 acres) shall be permitted.