

**Amendment # LOC2002-0043
Bylaw # 94Z2002**

Council Approval: 2002 November 04

SCHEDULE B

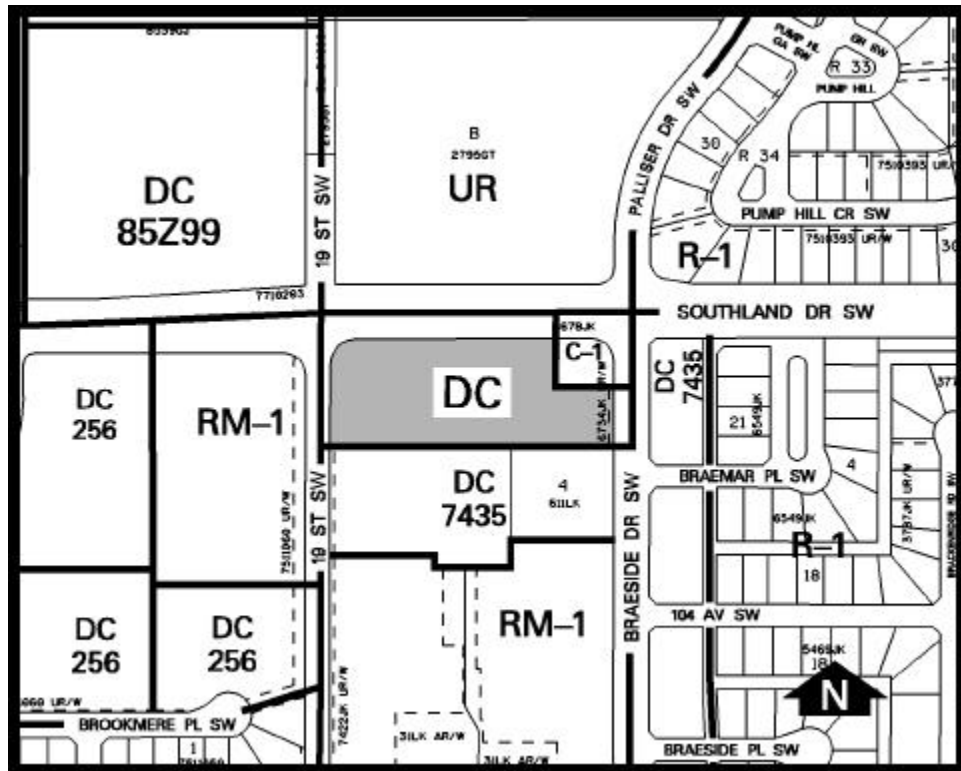

DC DIRECT CONTROL DISTRICT

1. Land Use

The Permitted and Discretionary Uses of the C-1A Local Commercial District of Bylaw 2P80 shall be the Permitted and Discretionary Uses respectively.

2. Development Guidelines

The General Rules for Commercial Districts contained in Section 33 of Bylaw 2P80 and the Permitted and Discretionary Use Rules of the C-1A Local Commercial Districts shall apply unless otherwise noted below:

(a) Floor Area

Notwithstanding Section 35(5)(b.2) (iii), one restaurant/drinking establishment may be allowed to a maximum net floor area of 233 square metres, excluding kitchen area.

(b) Parking

A minimum of 189 parking stalls shall be provided on-site.