

Amendment # LOC2003-0094
Bylaw # 92Z2003
Council Approval: September 15, 2003

SCHEDULE B

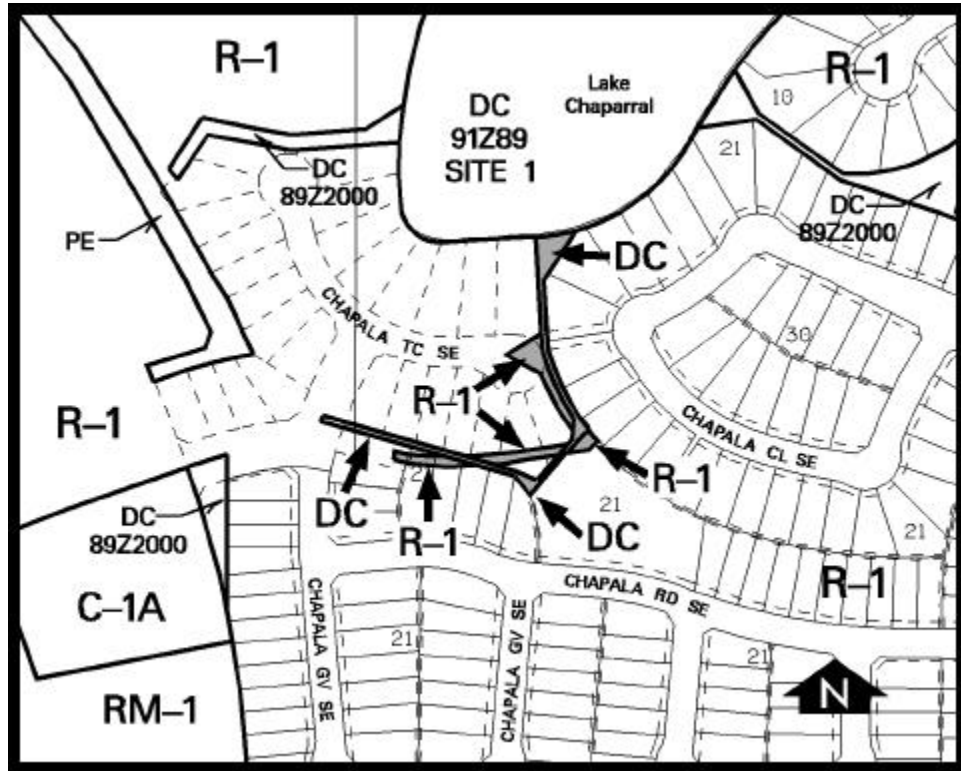

DC DIRECT CONTROL DISTRICT

1. Land Use

The land use shall be for privately owned and maintained ornamental entrance parks, walkways and community identification signage only.

2. Development Guidelines

The General Rules for Special Districts contained in Section 48 of Bylaw 2P80 and the Permitted and Discretionary Use Rules of the A Agricultural and Open Space District shall apply.