

Amendment # LOC2003-0105
Bylaw # 31Z2004
Council Approval: 2004 May 31

SCHEDULE B

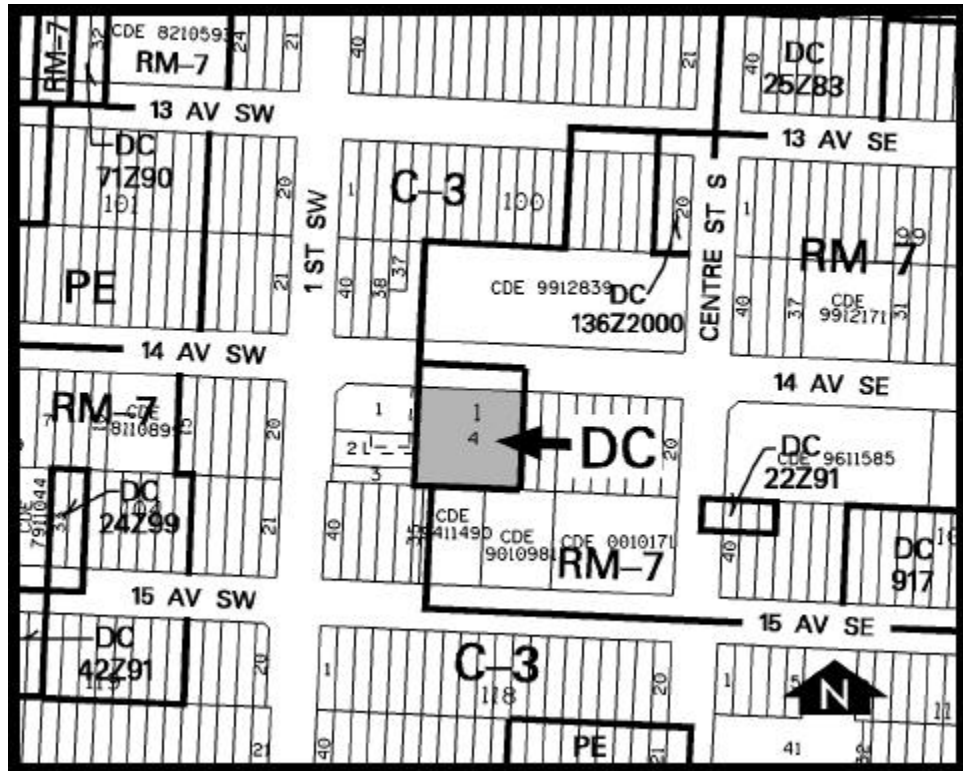

DC DIRECT CONTROL DISTRICT

1. Land Use

The Permitted and Discretionary Uses of the RM-7 Residential High Density Multi-Dwelling District of Bylaw 2P80 shall be the Permitted and Discretionary Uses respectively with the additional Discretionary Use of parking areas (at grade) for office or retail uses or to supplement residential requirements of multi-dwelling buildings in the area.

2. Development Guidelines

The General Rules for Residential Districts contained in Section 20 of Bylaw 2P80 and the Permitted and Discretionary Use Rules of the RM-7 Residential High Density Multi-Dwelling District shall apply unless otherwise noted below:

(a) At Grade Parking

- (i) The Development Permit issued for at grade parking shall be for one term of four years.
- (ii) All at grade parking shall be related to uses located within 120 meters of the site.