

100 ST SE (GARDEN ROAD)- NB PROFILE

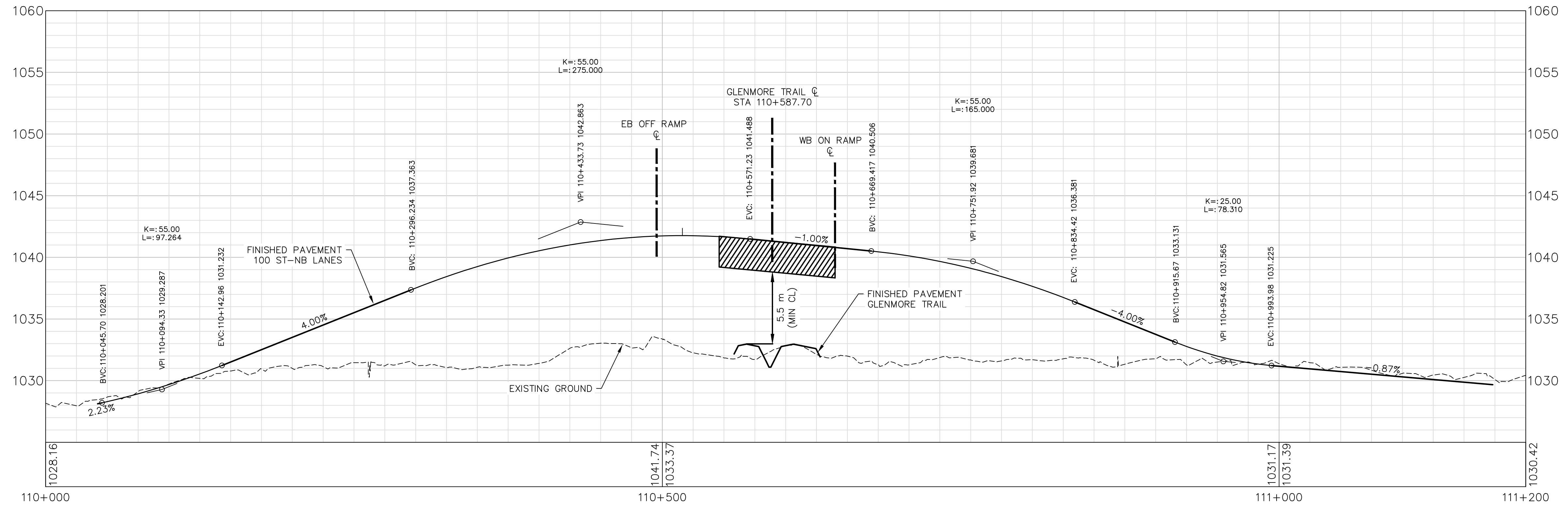

100 ST SE (GARDEN ROAD)- SB PROFILE

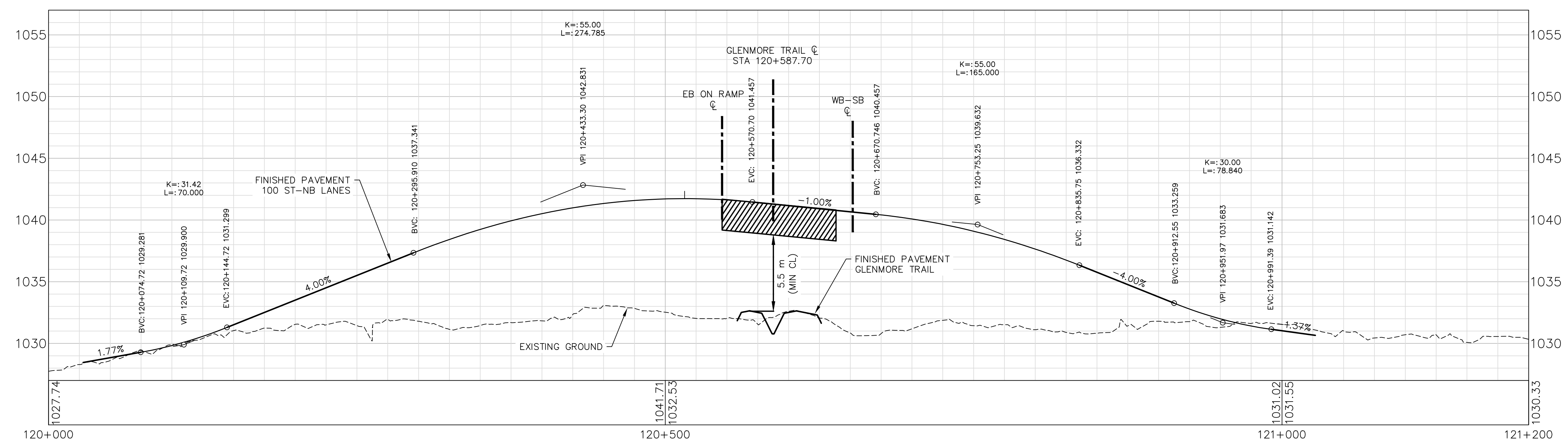

LEGEND

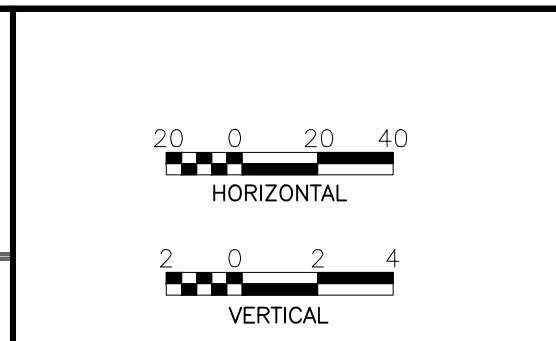
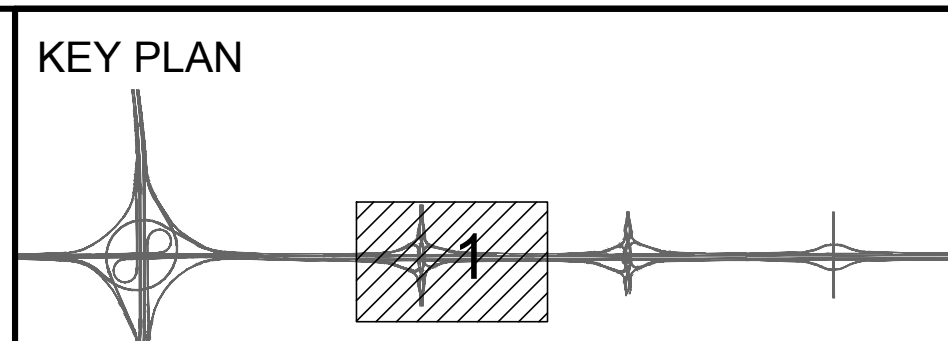

FUNCTIONAL PLANNING STUDY
 GLENMORE TRAIL EAST - STONEY TR TO RAINBOW RD (RANGE ROAD 283)
 100 ST SE (GARDEN ROAD) INTERCHANGE PROFILES
 100 ST NB AND SB (GARDEN ROAD)



JOB No.	PHOTOGRAPHY DATE	HIGHWAY 560.02	DATE	SHEET 2 OF 4	PLAN PR1
---------	------------------	-------------------	------	-----------------	-------------

FILE: J:\C:\62534 - Glenmore Trail East\4000 - Project Data\700 Drawings\50 Working Drawings\3D\07 - Recommended Design\Drawing Sheets\PI - PR1 - PR3.dwg DATE: 7/19/2017 12:37 PM BY: Cui, Jon



CONSULTANT
PARSONS
ISL Engineering and Land Services

LEGEND	
	EXISTING R/W
	ROAD CLOSURE
	PROPOSED GRADING LIMIT
	PROPOSED R/W
	PROPOSED PATHWAY
	PROPOSED DITCH RIGHT
	EDGE OF PAVEMENT
	PAVEMENT MARKINGS
	GEOMETRIC POINT MARKER
	UTIL & TRANSP CORRIDOR

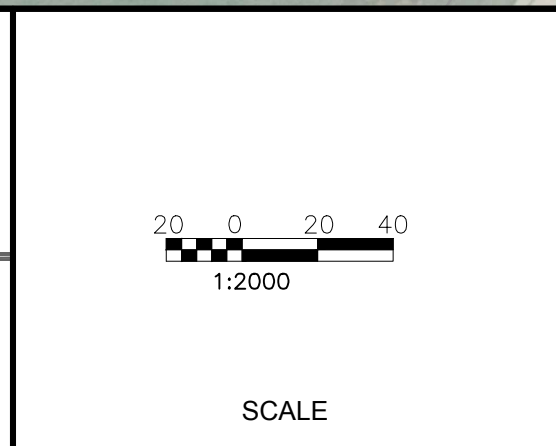
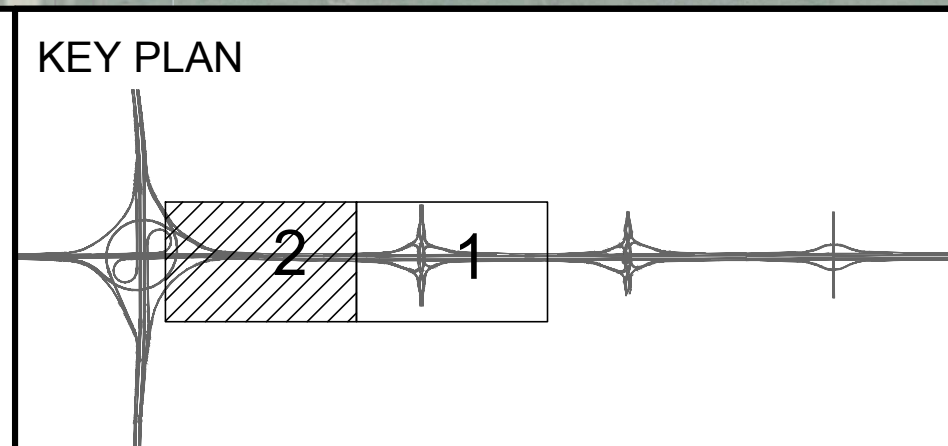

FUNCTIONAL PLANNING STUDY
GLENMORE TRAIL EAST - STONEY TR TO RAINBOW RD (RANGE ROAD 283)
100 ST SE (GARDEN ROAD) INTERCHANGE PLAN
BASKET WEAVE OPTION

PHOTOGRAPHY DATE	HIGHWAY 560.02	DATE	SHEET 2 OF 4	PLAN RP2
------------------	----------------	------	--------------	----------

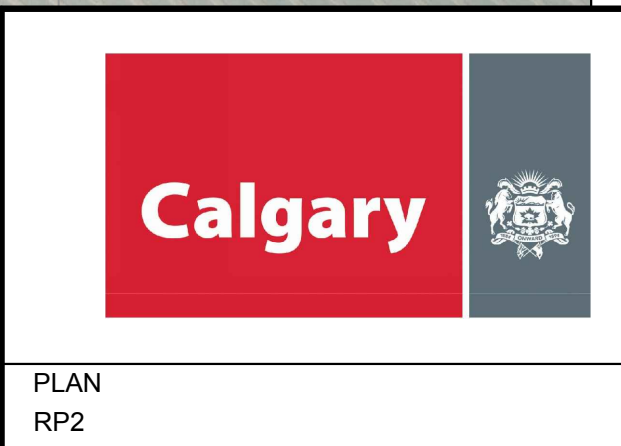

MATCHLINE - STA 0+950 RP1

FILE: J:\C\602534 - Glenmore Trail - East\4000 - Project Data\700 - Drawings\50 - Working Drawings\CS0\07 - Recommended Design\Drawings\Sheets\RP - RP2 - RP3 - RP4 - RP5 - RP6 - RP7 - RP8 - RP9 - RP10 - RP11 - RP12 - RP13 - RP14 - RP15 - RP16 - RP17 - RP18 - RP19 - RP20 - RP21 - RP22 - RP23 - RP24 - RP25 - RP26 - RP27 - RP28 - RP29 - RP30 - RP31 - RP32 - RP33 - RP34 - RP35 - RP36 - RP37 - RP38 - RP39 - RP40 - RP41 - RP42 - RP43 - RP44 - RP45 - RP46 - RP47 - RP48 - RP49 - RP50 - RP51 - RP52 - RP53 - RP54 - RP55 - RP56 - RP57 - RP58 - RP59 - RP60 - RP61 - RP62 - RP63 - RP64 - RP65 - RP66 - RP67 - RP68 - RP69 - RP70 - RP71 - RP72 - RP73 - RP74 - RP75 - RP76 - RP77 - RP78 - RP79 - RP80 - RP81 - RP82 - RP83 - RP84 - RP85 - RP86 - RP87 - RP88 - RP89 - RP90 - RP91 - RP92 - RP93 - RP94 - RP95 - RP96 - RP97 - RP98 - RP99 - RP100 - RP101 - RP102 - RP103 - RP104 - RP105 - RP106 - RP107 - RP108 - RP109 - RP110 - RP111 - RP112 - RP113 - RP114 - RP115 - RP116 - RP117 - RP118 - RP119 - RP120 - RP121 - RP122 - RP123 - RP124 - RP125 - RP126 - RP127 - RP128 - RP129 - RP130 - RP131 - RP132 - RP133 - RP134 - RP135 - RP136 - RP137 - RP138 - RP139 - RP140 - RP141 - RP142 - RP143 - RP144 - RP145 - RP146 - RP147 - RP148 - RP149 - RP150 - RP151 - RP152 - RP153 - RP154 - RP155 - RP156 - RP157 - RP158 - RP159 - RP160 - RP161 - RP162 - RP163 - RP164 - RP165 - RP166 - RP167 - RP168 - RP169 - RP170 - RP171 - RP172 - RP173 - RP174 - RP175 - RP176 - RP177 - RP178 - RP179 - RP180 - RP181 - RP182 - RP183 - RP184 - RP185 - RP186 - RP187 - RP188 - RP189 - RP190 - RP191 - RP192 - RP193 - RP194 - RP195 - RP196 - RP197 - RP198 - RP199 - RP200 - RP201 - RP202 - RP203 - RP204 - RP205 - RP206 - RP207 - RP208 - RP209 - RP210 - RP211 - RP212 - RP213 - RP214 - RP215 - RP216 - RP217 - RP218 - RP219 - RP220 - RP221 - RP222 - RP223 - RP224 - RP225 - RP226 - RP227 - RP228 - RP229 - RP230 - RP231 - RP232 - RP233 - RP234 - RP235 - RP236 - RP237 - RP238 - RP239 - RP240 - RP241 - RP242 - RP243 - RP244 - RP245 - RP246 - RP247 - RP248 - RP249 - RP250 - RP251 - RP252 - RP253 - RP254 - RP255 - RP256 - RP257 - RP258 - RP259 - RP260 - RP261 - RP262 - RP263 - RP264 - RP265 - RP266 - RP267 - RP268 - RP269 - RP270 - RP271 - RP272 - RP273 - RP274 - RP275 - RP276 - RP277 - RP278 - RP279 - RP280 - RP281 - RP282 - RP283 - RP284 - RP285 - RP286 - RP287 - RP288 - RP289 - RP290 - RP291 - RP292 - RP293 - RP294 - RP295 - RP296 - RP297 - RP298 - RP299 - RP300 - RP301 - RP302 - RP303 - RP304 - RP305 - RP306 - RP307 - RP308 - RP309 - RP310 - RP311 - RP312 - RP313 - RP314 - RP315 - RP316 - RP317 - RP318 - RP319 - RP320 - RP321 - RP322 - RP323 - RP324 - RP325 - RP326 - RP327 - RP328 - RP329 - RP330 - RP331 - RP332 - RP333 - RP334 - RP335 - RP336 - RP337 - RP338 - RP339 - RP340 - RP341 - RP342 - RP343 - RP344 - RP345 - RP346 - RP347 - RP348 - RP349 - RP350 - RP351 - RP352 - RP353 - RP354 - RP355 - RP356 - RP357 - RP358 - RP359 - RP360 - RP361 - RP362 - RP363 - RP364 - RP365 - RP366 - RP367 - RP368 - RP369 - RP370 - RP371 - RP372 - RP373 - RP374 - RP375 - RP376 - RP377 - RP378 - RP379 - RP380 - RP381 - RP382 - RP383 - RP384 - RP385 - RP386 - RP387 - RP388 - RP389 - RP390 - RP391 - RP392 - RP393 - RP394 - RP395 - RP396 - RP397 - RP398 - RP399 - RP400 - RP401 - RP402 - RP403 - RP404 - RP405 - RP406 - RP407 - RP408 - RP409 - RP410 - RP411 - RP412 - RP413 - RP414 - RP415 - RP416 - RP417 - RP418 - RP419 - RP420 - RP421 - RP422 - RP423 - RP424 - RP425 - RP426 - RP427 - RP428 - RP429 - RP430 - RP431 - RP432 - RP433 - RP434 - RP435 - RP436 - RP437 - RP438 - RP439 - RP440 - RP441 - RP442 - RP443 - RP444 - RP445 - RP446 - RP447 - RP448 - RP449 - RP450 - RP451 - RP452 - RP453 - RP454 - RP455 - RP456 - RP457 - RP458 - RP459 - RP460 - RP461 - RP462 - RP463 - RP464 - RP465 - RP466 - RP467 - RP468 - RP469 - RP470 - RP471 - RP472 - RP473 - RP474 - RP475 - RP476 - RP477 - RP478 - RP479 - RP480 - RP481 - RP482 - RP483 - RP484 - RP485 - RP486 - RP487 - RP488 - RP489 - RP490 - RP491 - RP492 - RP493 - RP494 - RP495 - RP496 - RP497 - RP498 - RP499 - RP500 - RP501 - RP502 - RP503 - RP504 - RP505 - RP506 - RP507 - RP508 - RP509 - RP510 - RP511 - RP512 - RP513 - RP514 - RP515 - RP516 - RP517 - RP518 - RP519 - RP520 - RP521 - RP522 - RP523 - RP524 - RP525 - RP526 - RP527 - RP528 - RP529 - RP530 - RP531 - RP532 - RP533 - RP534 - RP535 - RP536 - RP537 - RP538 - RP539 - RP540 - RP541 - RP542 - RP543 - RP544 - RP545 - RP546 - RP547 - RP548 - RP549 - RP550 - RP551 - RP552 - RP553 - RP554 - RP555 - RP556 - RP557 - RP558 - RP559 - RP560 - RP561 - RP562 - RP563 - RP564 - RP565 - RP566 - RP567 - RP568 - RP569 - RP570 - RP571 - RP572 - RP573 - RP574 - RP575 - RP576 - RP577 - RP578 - RP579 - RP580 - RP581 - RP582 - RP583 - RP584 - RP585 - RP586 - RP587 - RP588 - RP589 - RP590 - RP591 - RP592 - RP593 - RP594 - RP595 - RP596 - RP597 - RP598 - RP599 - RP600 - RP601 - RP602 - RP603 - RP604 - RP605 - RP606 - RP607 - RP608 - RP609 - RP610 - RP611 - RP612 - RP613 - RP614 - RP615 - RP616 - RP617 - RP618 - RP619 - RP620 - RP621 - RP622 - RP623 - RP624 - RP625 - RP626 - RP627 - RP628 - RP629 - RP630 - RP631 - RP632 - RP633 - RP634 - RP635 - RP636 - RP637 - RP638 - RP639 - RP640 - RP641 - RP642 - RP643 - RP644 - RP645 - RP646 - RP647 - RP648 - RP649 - RP650 - RP651 - RP652 - RP653 - RP654 - RP655 - RP656 - RP657 - RP658 - RP659 - RP660 - RP661 - RP662 - RP663 - RP664 - RP665 - RP666 - RP667 - RP668 - RP669 - RP670 - RP671 - RP672 - RP673 - RP674 - RP675 - RP676 - RP677 - RP678 - RP679 - RP680 - RP681 - RP682 - RP683 - RP684 - RP685 - RP686 - RP687 - RP688 - RP689 - RP690 - RP691 - RP692 - RP693 - RP694 - RP695 - RP696 - RP697 - RP698 - RP699 - RP700 - RP701 - RP702 - RP703 - RP704 - RP705 - RP706 - RP707 - RP708 - RP709 - RP710 - RP711 - RP712 - RP713 - RP714 - RP715 - RP716 - RP717 - RP718 - RP719 - RP720 - RP721 - RP722 - RP723 - RP724 - RP725 - RP726 - RP727 - RP728 - RP729 - RP730 - RP731 - RP732 - RP733 - RP734 - RP735 - RP736 - RP737 - RP738 - RP739 - RP740 - RP741 - RP742 - RP743 - RP744 - RP745 - RP746 - RP747 - RP748 - RP749 - RP750 - RP751 - RP752 - RP753 - RP754 - RP755 - RP756 - RP757 - RP758 - RP759 - RP760 - RP761 - RP762 - RP763 - RP764 - RP765 - RP766 - RP767 - RP768 - RP769 - RP770 - RP771 - RP772 - RP773 - RP774 - RP775 - RP776 - RP777 - RP778 - RP779 - RP780 - RP781 - RP782 - RP783 - RP784 - RP785 - RP786 - RP787 - RP788 - RP789 - RP790 - RP791 - RP792 - RP793 - RP794 - RP795 - RP796 - RP797 - RP798 - RP799 - RP800 - RP801 - RP802 - RP803 - RP804 - RP805 - RP806 - RP807 - RP808 - RP809 - RP810 - RP811 - RP812 - RP813 - RP814 - RP815 - RP816 - RP817 - RP818 - RP819 - RP820 - RP821 - RP822 - RP823 - RP824 - RP825 - RP826 - RP827 - RP828 - RP829 - RP830 - RP831 - RP832 - RP833 - RP834 - RP835 - RP836 - RP837 - RP838 - RP839 - RP840 - RP841 - RP842 - RP843 - RP844 - RP845 - RP846 - RP847 - RP848 - RP849 - RP850 - RP851 - RP852 - RP853 - RP854 - RP855 - RP856 - RP857 - RP858 - RP859 - RP860 - RP861 - RP862 - RP863 - RP864 - RP865 - RP866 - RP867 - RP868 - RP869 - RP870 - RP871 - RP872 - RP873 - RP874 - RP875 - RP876 - RP877 - RP878 - RP879 - RP880 - RP881 - RP882 - RP883 - RP884 - RP885 - RP886 - RP887 - RP888 - RP889 - RP890 - RP891 - RP892 - RP893 - RP894 - RP895 - RP896 - RP897 - RP898 - RP899 - RP900 - RP901 - RP902 - RP903 - RP904 - RP905 - RP906 - RP907 - RP908 - RP909 - RP910 - RP911 - RP912 - RP913 - RP914 - RP915 - RP916 - RP917 - RP918 - RP919 - RP920 - RP921 - RP922 - RP923 - RP924 - RP925 - RP926 - RP927 - RP928 - RP929 - RP930 - RP931 - RP932 - RP933 - RP934 - RP935 - RP936 - RP937 - RP938 - RP939 - RP940 - RP941 - RP942 - RP943 - RP944 - RP945 - RP946 - RP947 - RP948 - RP949 - RP950 - RP951 - RP952 - RP953 - RP954 - RP955 - RP956 - RP957 - RP958 - RP959 - RP960 - RP961 - RP962 - RP963 - RP964 - RP965 - RP966 - RP967 - RP968 - RP969 - RP970 - RP971 - RP972 - RP973 - RP974 - RP975 - RP976 - RP977 - RP978 - RP979 - RP980 - RP981 - RP982 - RP983 - RP984 - RP985 - RP986 - RP987 - RP988 - RP989 - RP990 - RP991 - RP992 - RP993 - RP994 - RP995 - RP996 - RP997 - RP998 - RP999 - RP1000

EB OFF RAMP

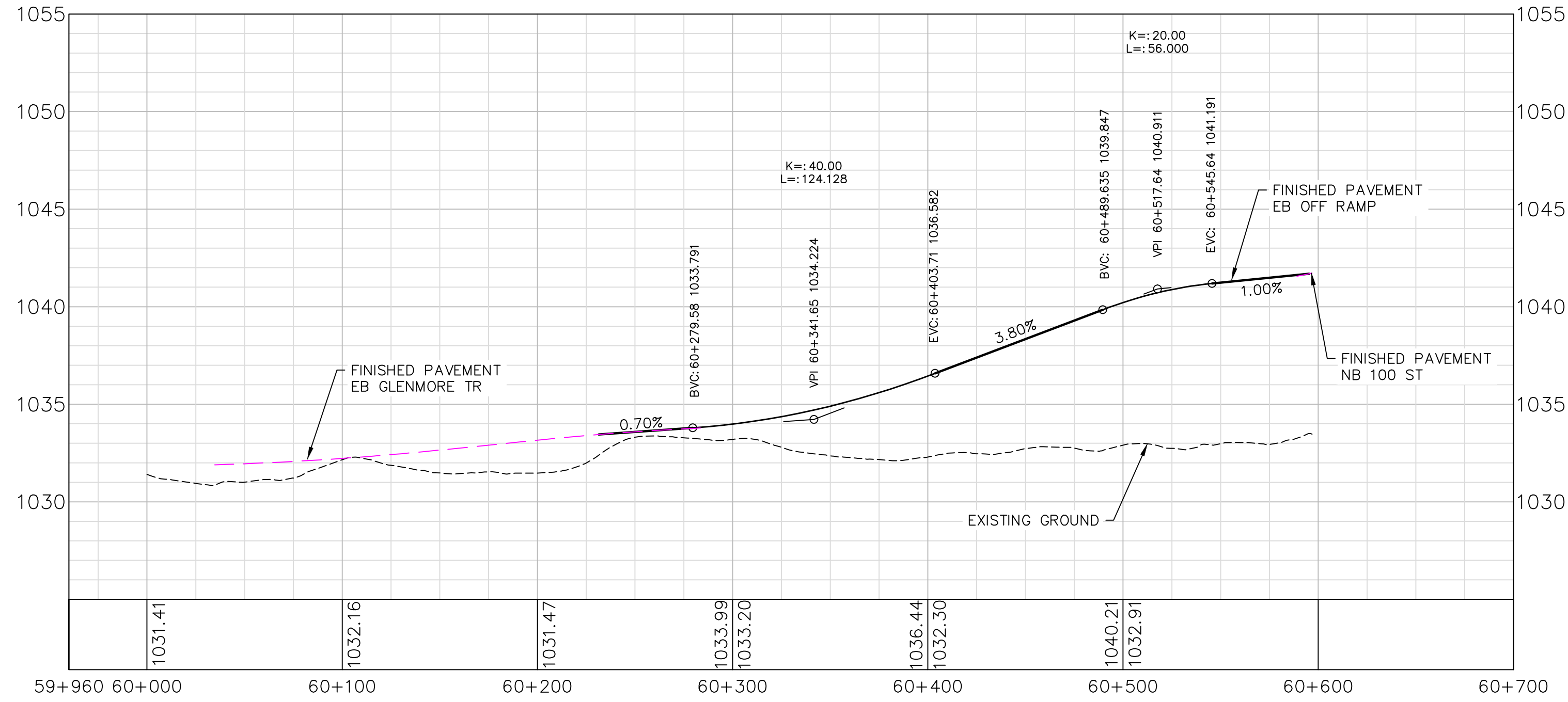

NB-EB

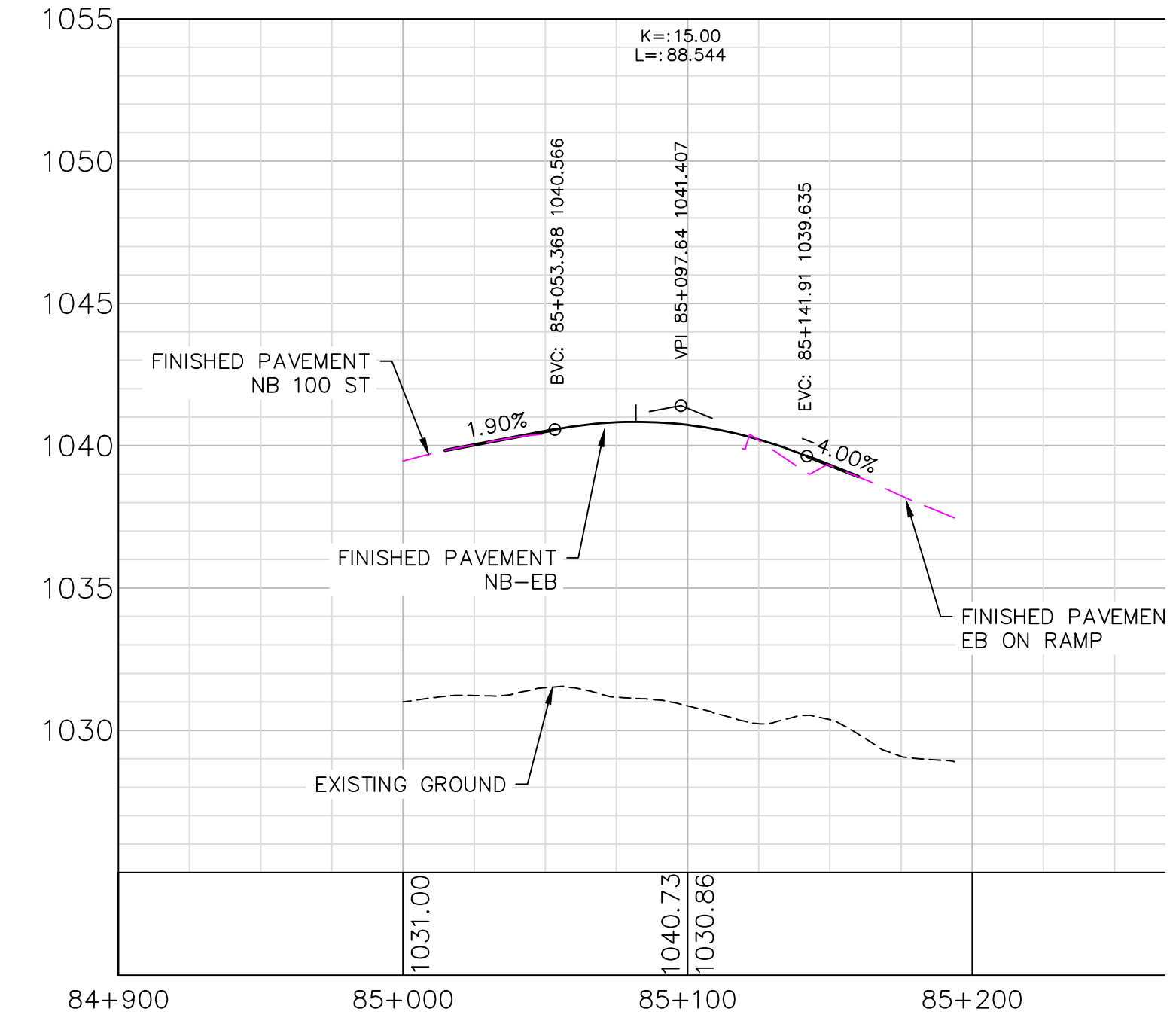

EB ON RAMP

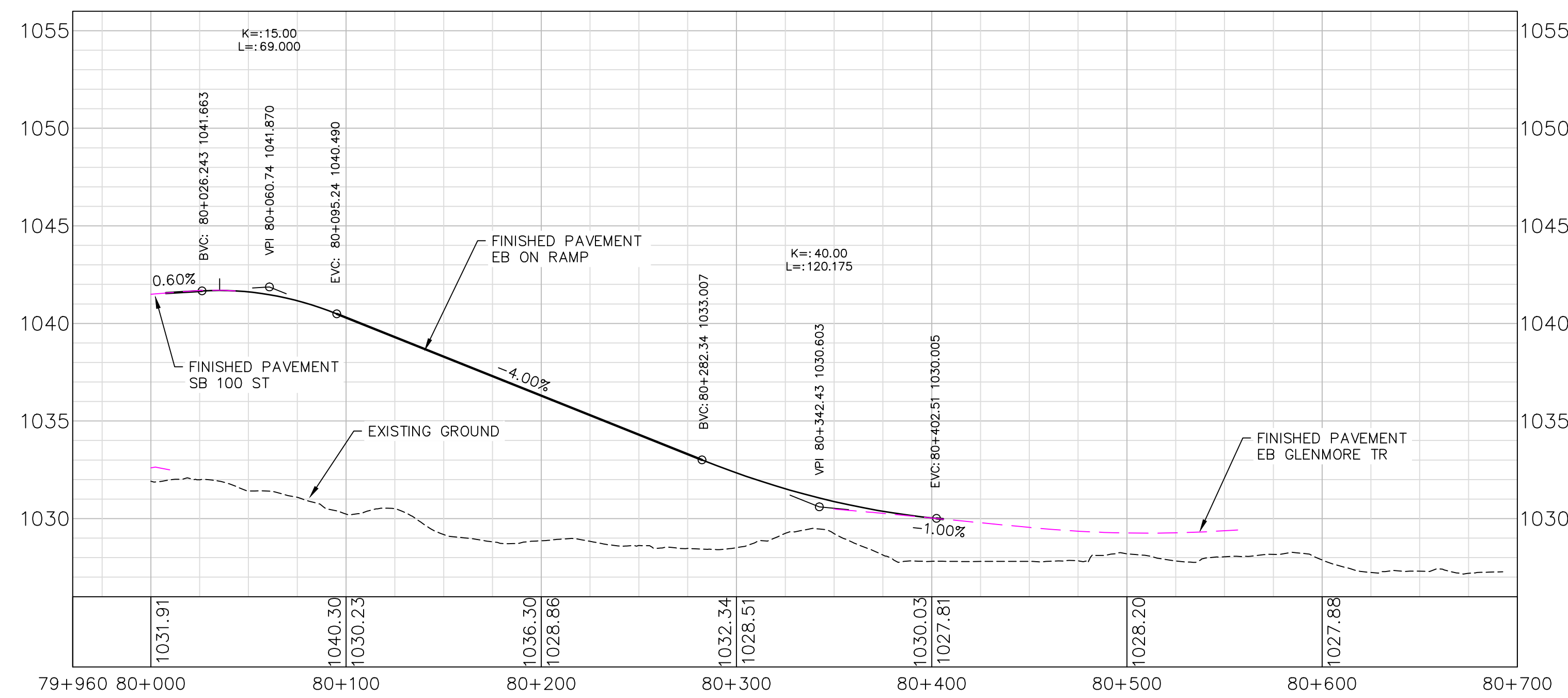

EB-SB

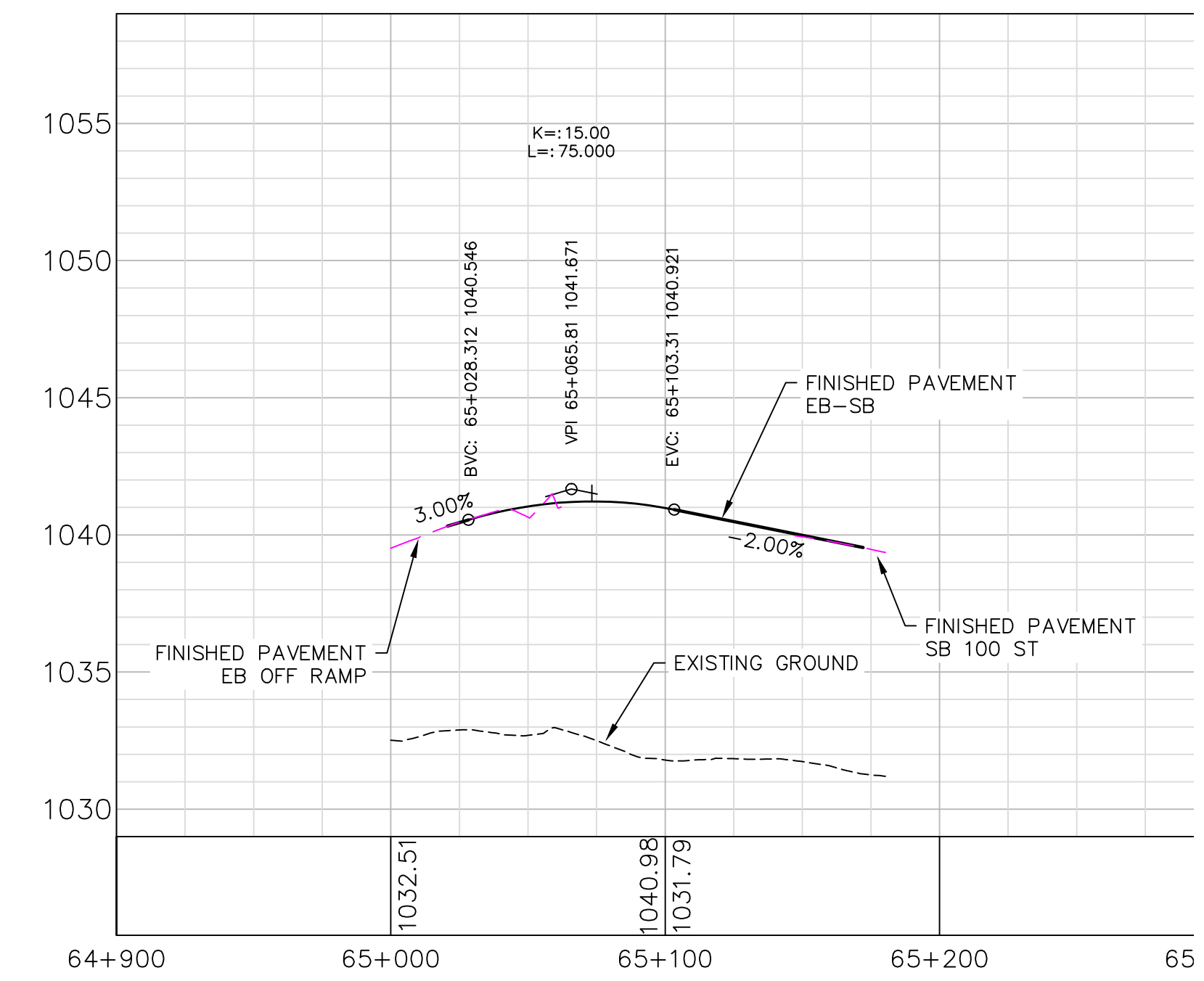

LEGEND

[Symbol]	Finished Pavement
[Symbol]	Existing Ground

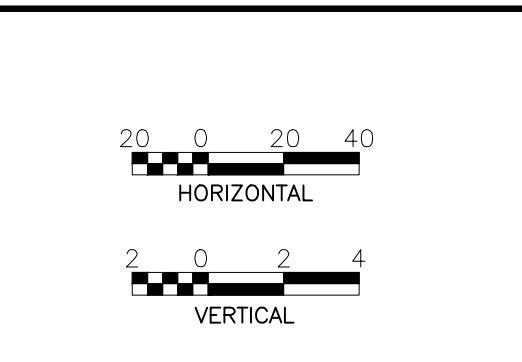
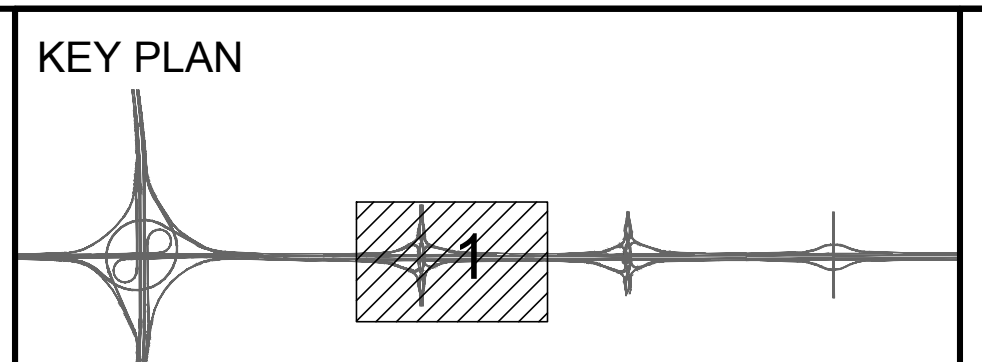

FUNCTIONAL PLANNING STUDY
GLENMORE TRAIL EAST - STONEY TR TO RAINBOW RD (RANGE ROAD 283)
100 STREET SE (GARDEN ROAD) INTERCHANGE PROFILES
EB OFF RAMP, NB-EB, EB ON RAMP, AND EB-SB



JOB No.

PHOTOGRAPHY DATE	HIGHWAY 560.02	DATE	SHEET 4 OF 4
------------------	-------------------	------	-----------------

PLAN
PR3

FILE: J:\C\602534 - Glenmore Trail East\4000 - Project Data\700 Drawings\50 Working Drawings\500 - Recommended Design\Drawings\Sheet\1_P1-PR3.dwg DATE: 7/19/2017 12:54 PM BY: Cui, Jun

WB OFF RAMP BASKET WEAVE

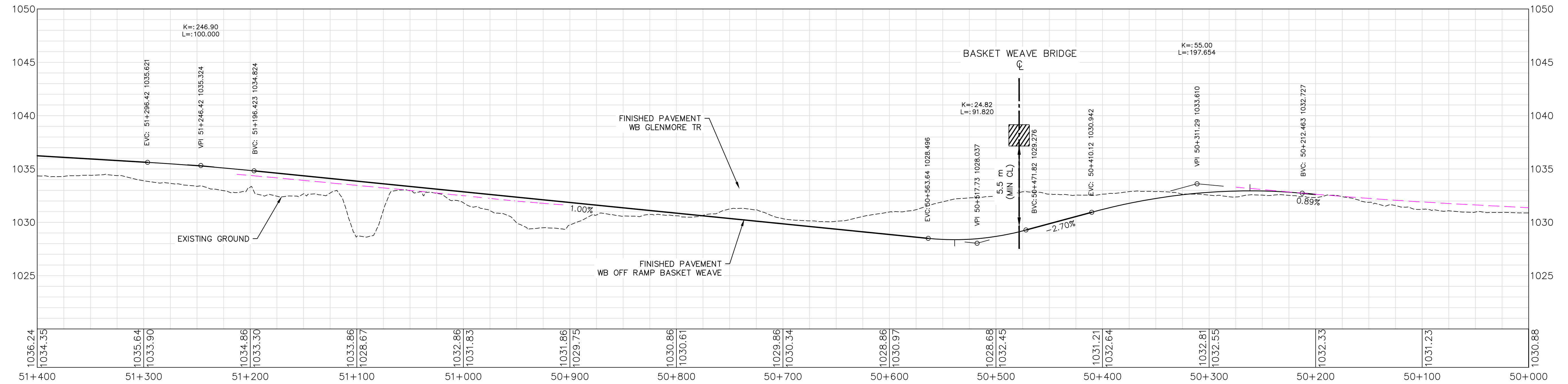

WB OFF RAMP BASKET WEAVE

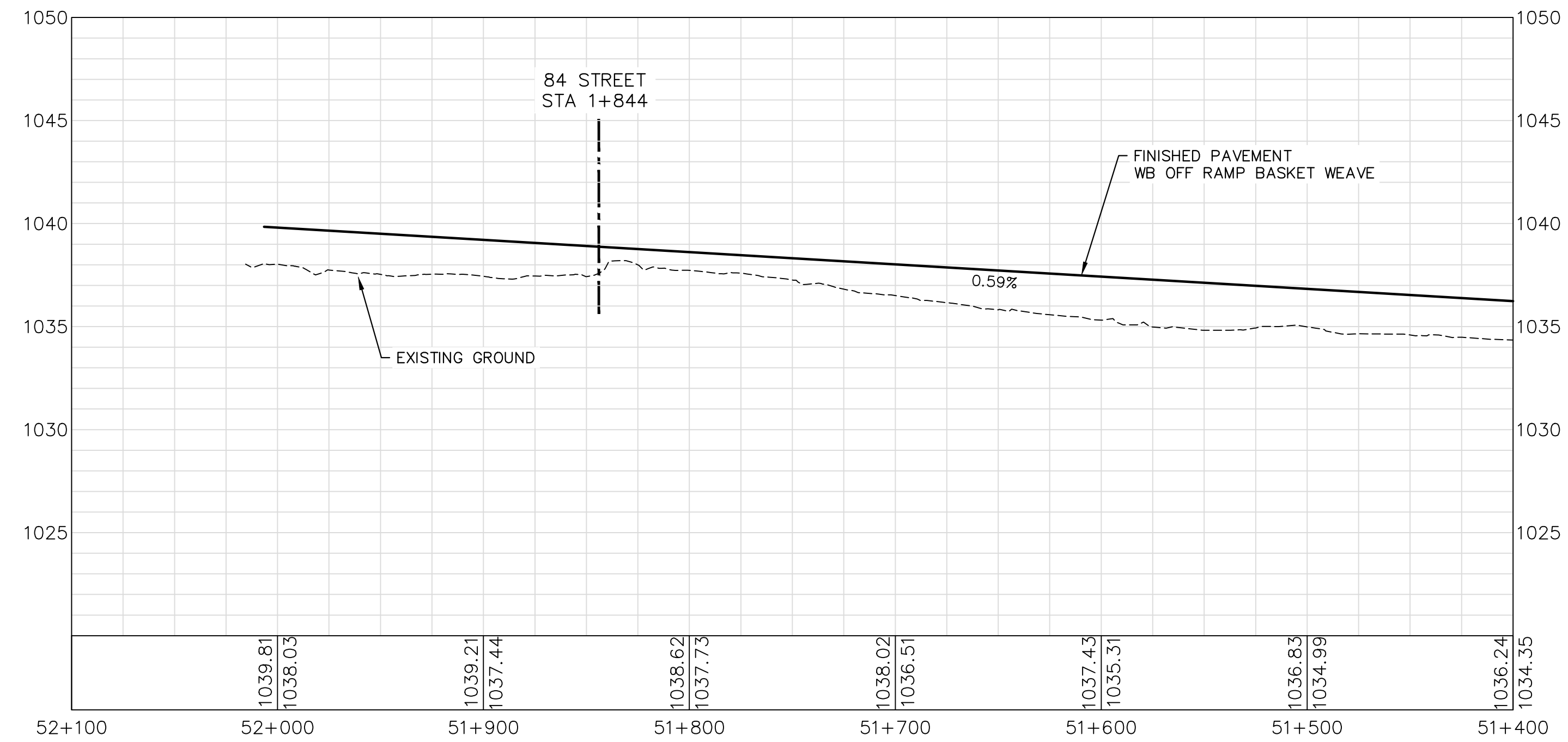

LEGEND

KEY PLAN

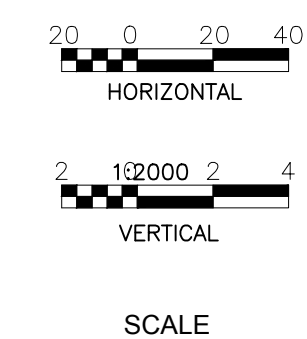
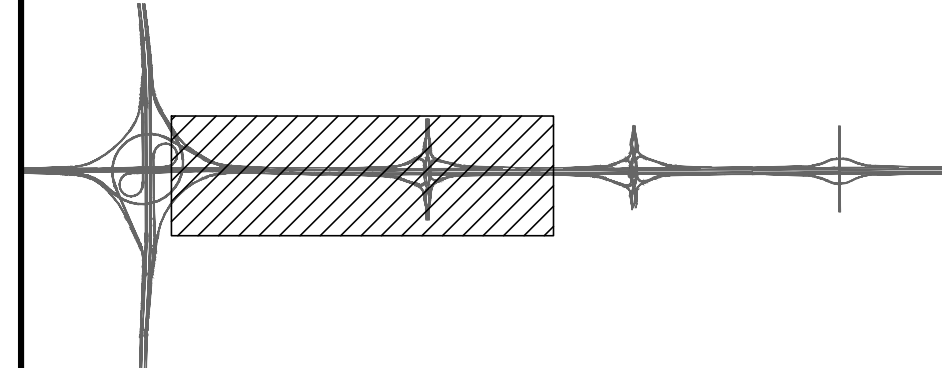

FUNCTIONAL PLANNING STUDY
GLENMORE TRAIL EAST - STONEY TR TO RAINBOW RD (RANGE ROAD 283)
100 ST SE (GARDEN ROAD) BASKETWEAVE OPTION
WB OFF RAMP BASKET WEAVE PROFILE



JOB No.

PHOTOGRAPHY DATE

HIGHWAY
560.02

DATE

SHEET
3 OF 4

PLAN
PR4

SBWB BASKET WEAVE

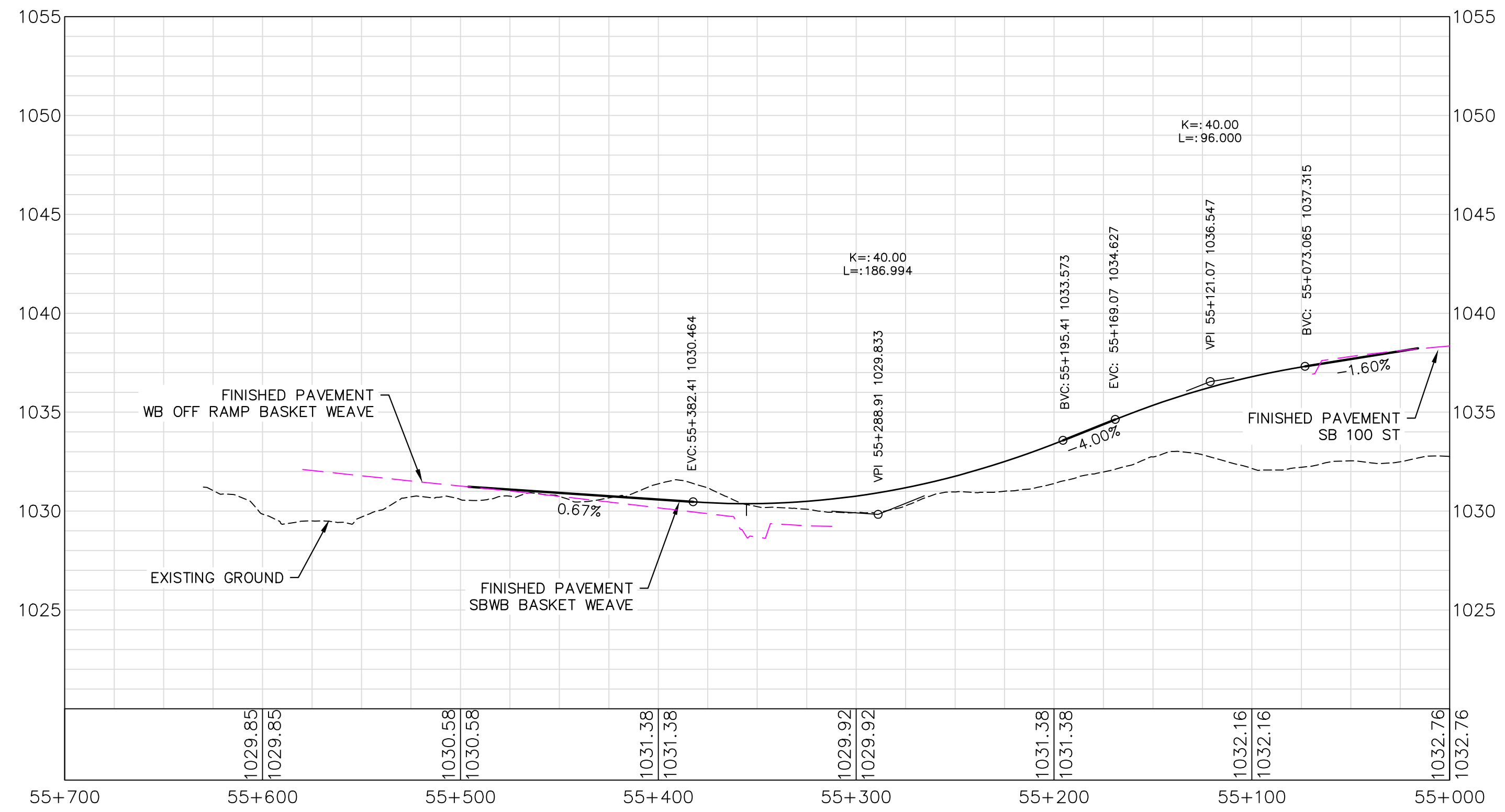

WB ON RAMP BASKET WEAVE

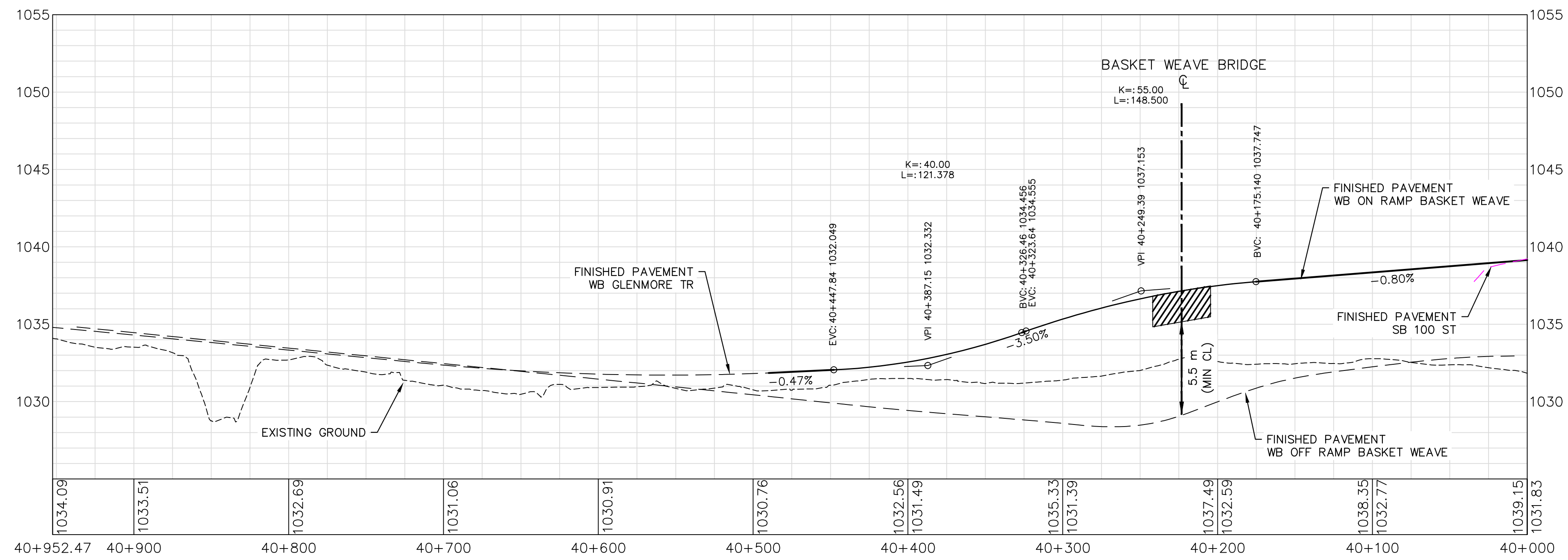

LEGEND

KEY PLAN

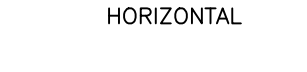
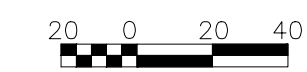
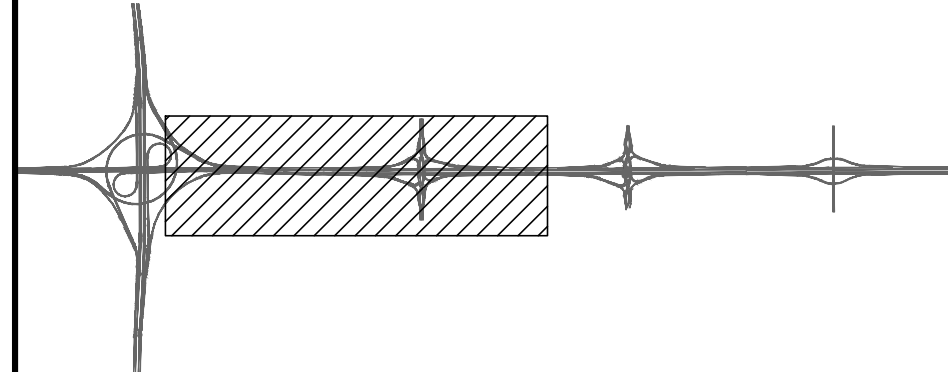

SCALE

FUNCTIONAL PLANNING STUDY
GLENMORE TRAIL EAST - STONEY TR TO RAINBOW RD (RANGE ROAD 283)
100 ST SE (GARDEN ROAD) BASKETWEAVE OPTION
SBWB BASKET WEAVE AND WB ON RAMP BASKET WEAVE PROFILES



JOB No.

PHOTOGRAPHY DATE

HIGHWAY
560.02

DATE

SHEET
4 OF 4

PLAN
PR5

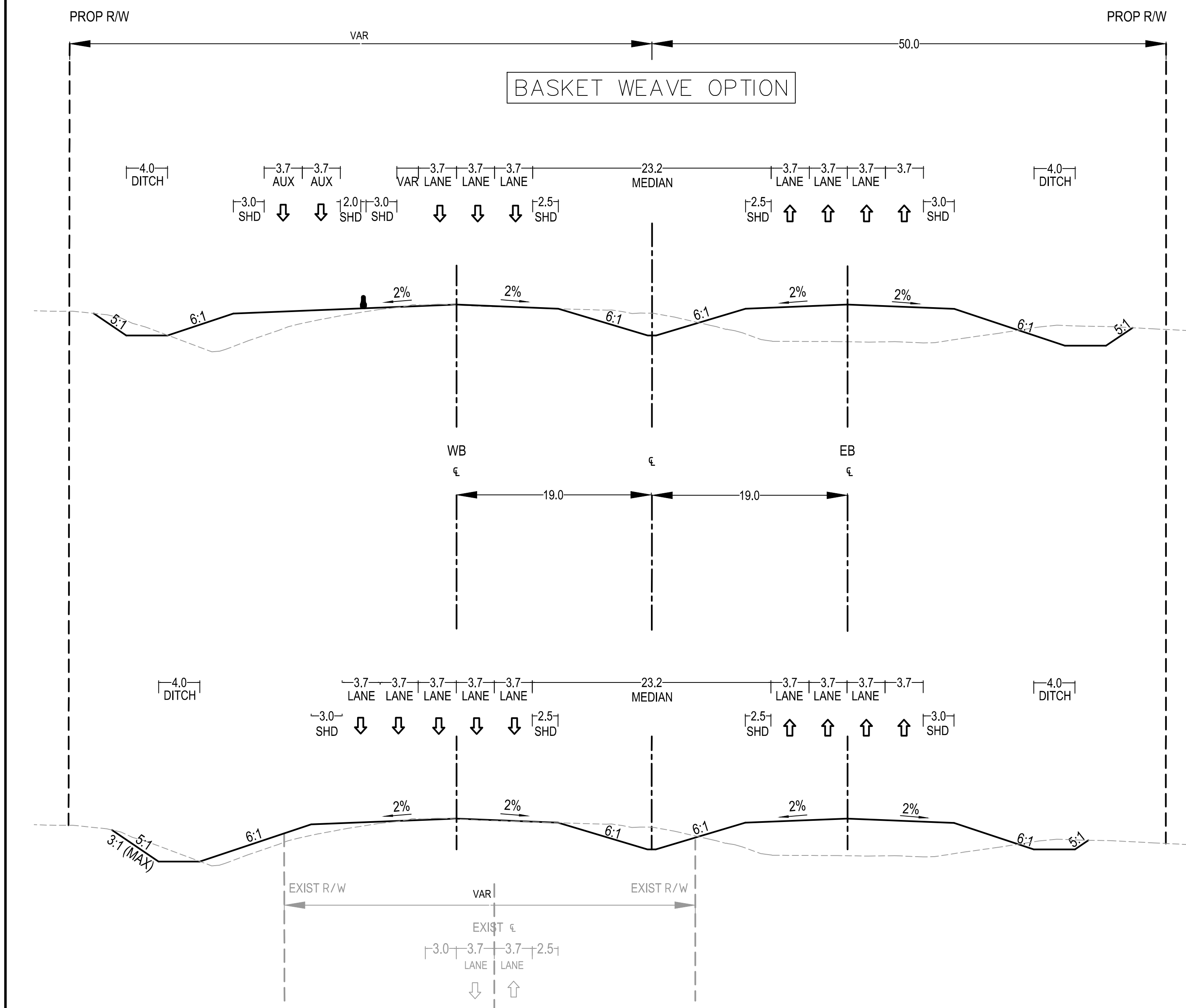

SECTION A
GLENMORE TRAIL - STONEY TRAIL TO 100 ST SE (GARDEN ROAD)

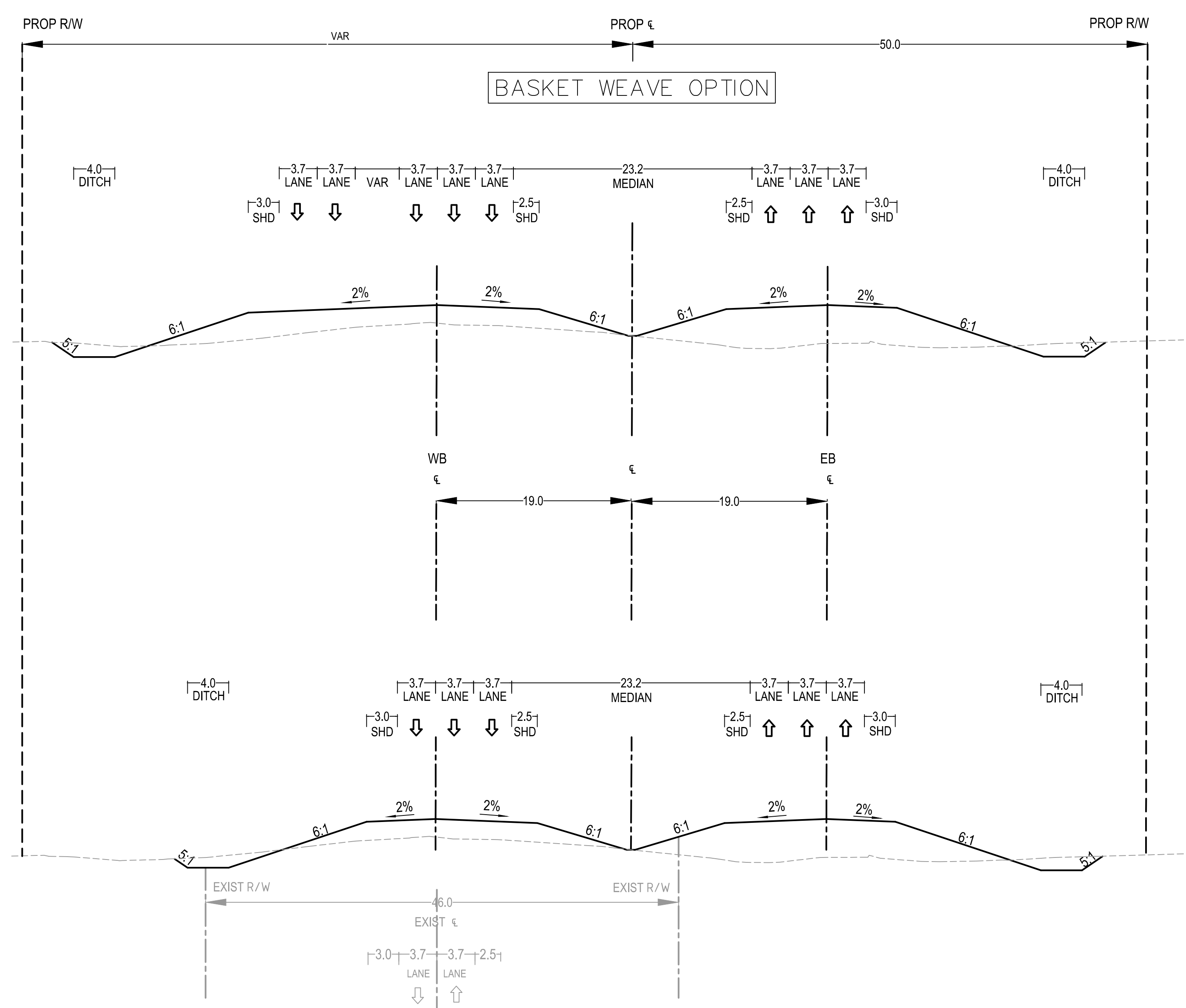

SECTION B
GLENMORE TRAIL - AT 100 ST SE (GARDEN ROAD)



LEGEND

KEY PLAN

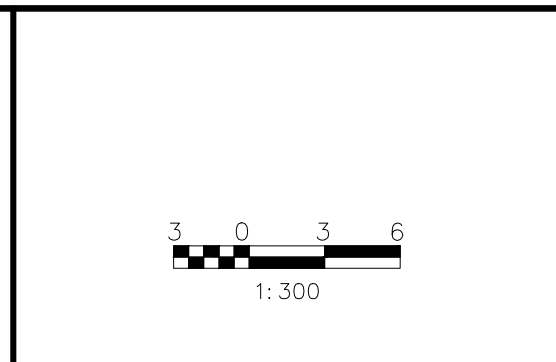

FUNCTIONAL PLANNING STUDY
GLENMORE TRAIL EAST - STONEY TR TO RAINBOW RD (RANGE ROAD 283)
100 ST SE (GARDEN ROAD) INTERCHANGE
TYPICAL SECTIONS

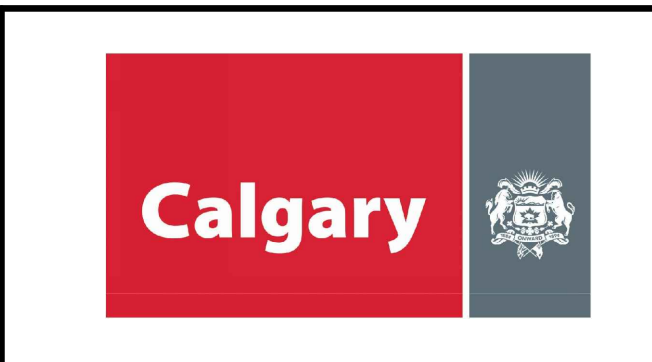

JOB No.		PHOTOGRAPHY DATE	HIGHWAY 560:02	DATE	SHEET 1 OF 3	DRAWING NO. TS1
---------	--	------------------	-------------------	------	-----------------	--------------------

FILE: J:\C:\62534 - Glenmore Trail East\4000 - Project Data\700 - Drawings\50 - Working Drawings\30 - Recommended Design\Drawings Sheets\151 - 152.dwg DATE: 6/26/2017 6:11 PM BY: Cui, Jun

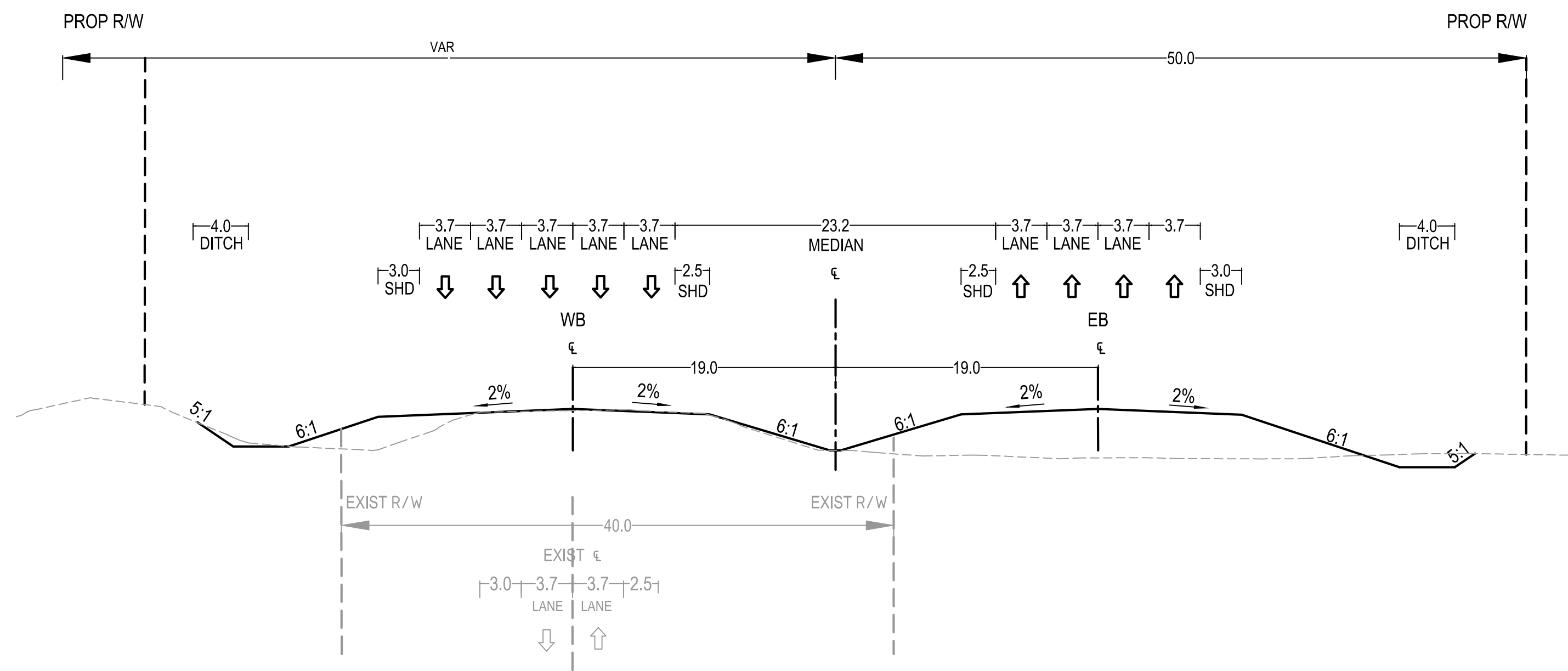

SECTION C
GLENMORE TRAIL - 100 ST SE (GARDEN ROAD) TO 16 ST SE (CONRICH ROAD)

SECTION D
GLENMORE TRAIL - 16 ST SE (CONRICH ROAD) TO RAINBOW ROAD (RANGE ROAD 283)



LEGEND

KEY PLAN

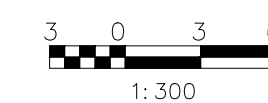

SCALE

FUNCTIONAL PLANNING STUDY
GLENMORE TRAIL EAST - STONEY TR TO RAINBOW RD (RANGE ROAD 283)
100 ST SE (GARDEN ROAD) INTERCHANGE
TYPICAL SECTIONS



PHOTOGRAPHY DATE

HIGHWAY
560:02

DATE

SHEET
2 OF 3

DRAWING NO.
TS2

JOB No.

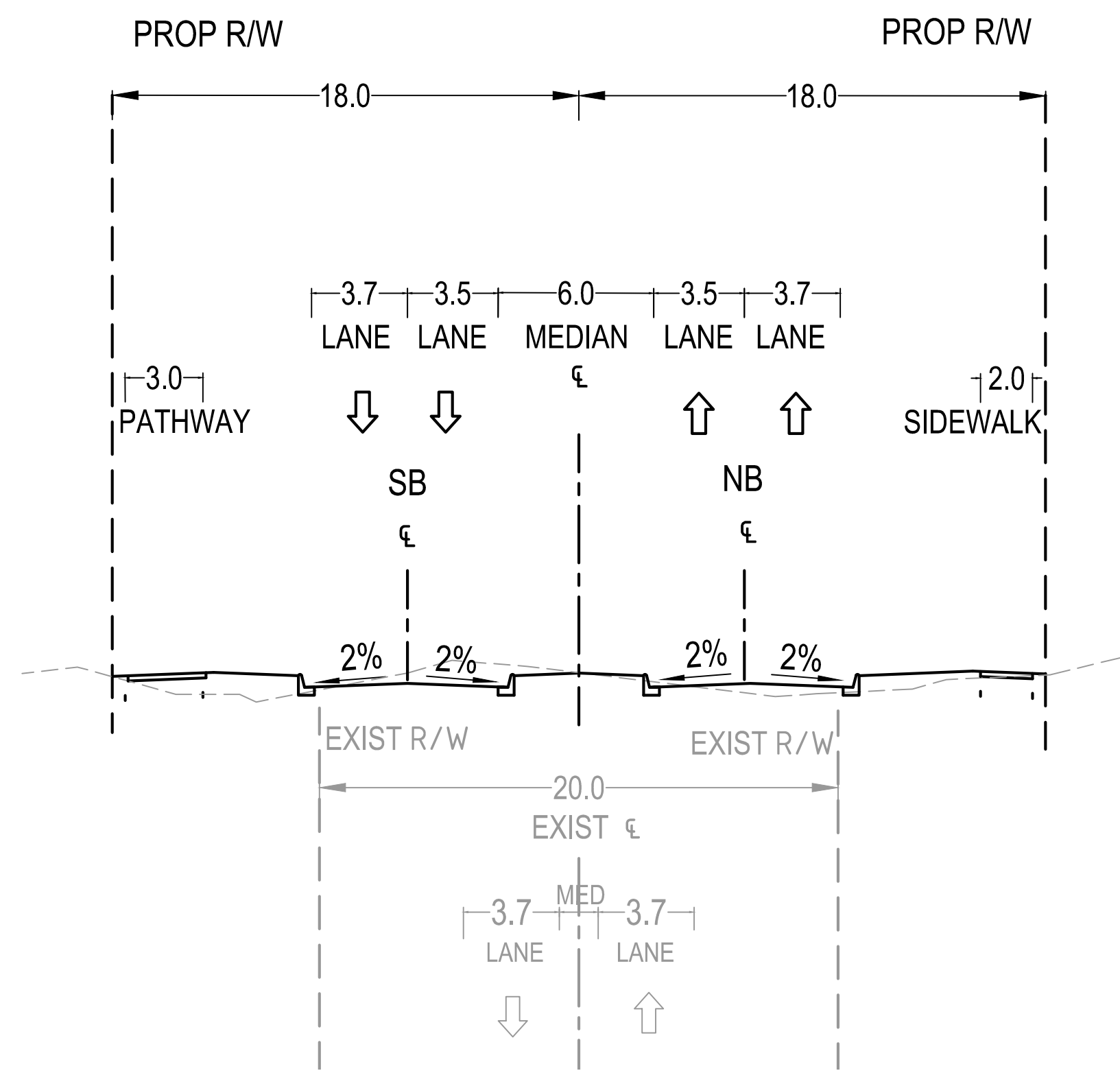

SECTION E
100 ST SE (GARDEN ROAD) - NORTH & SOUTH PROJECT LIMIT

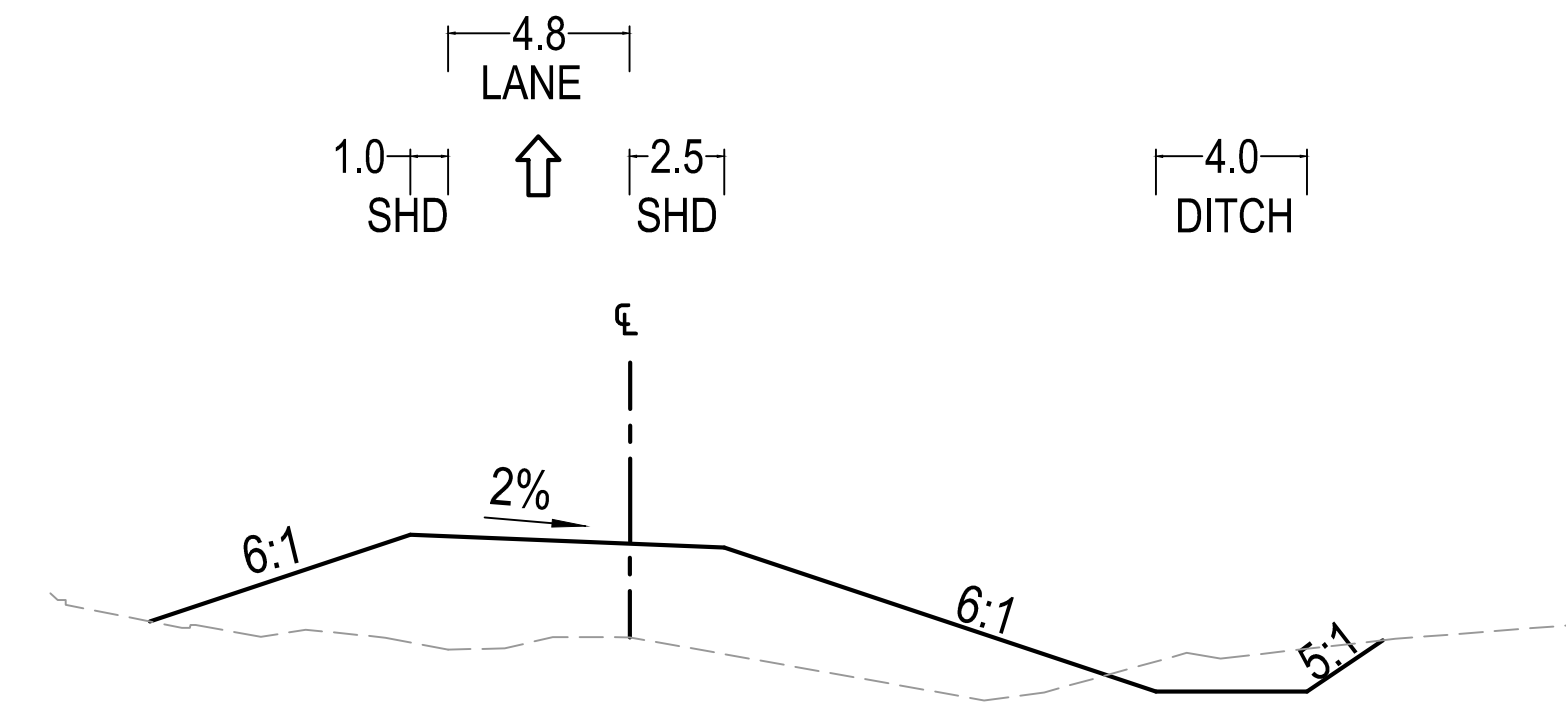

SECTION G
SINGLE LANE RAMP

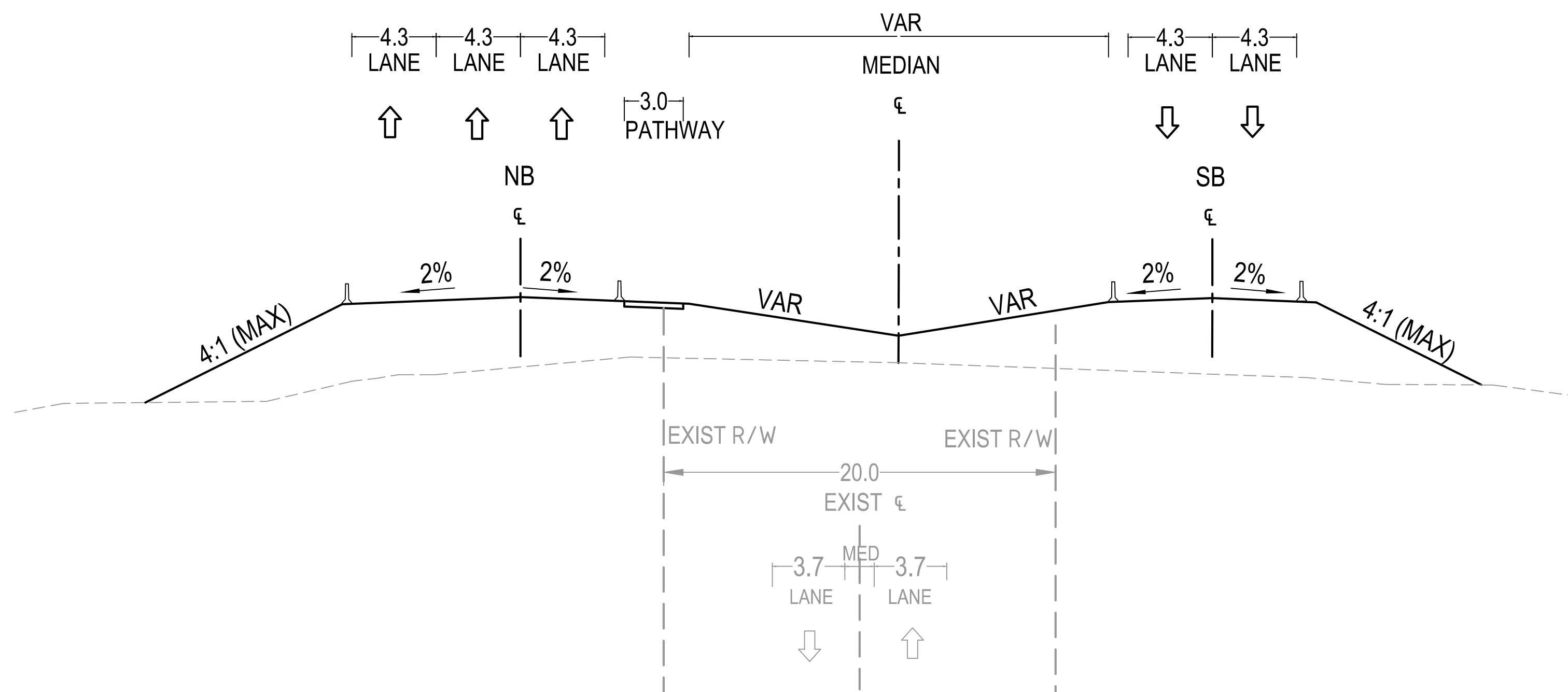

SECTION F
100 ST SE (GARDEN ROAD) - BETWEEN CROSSOVERS

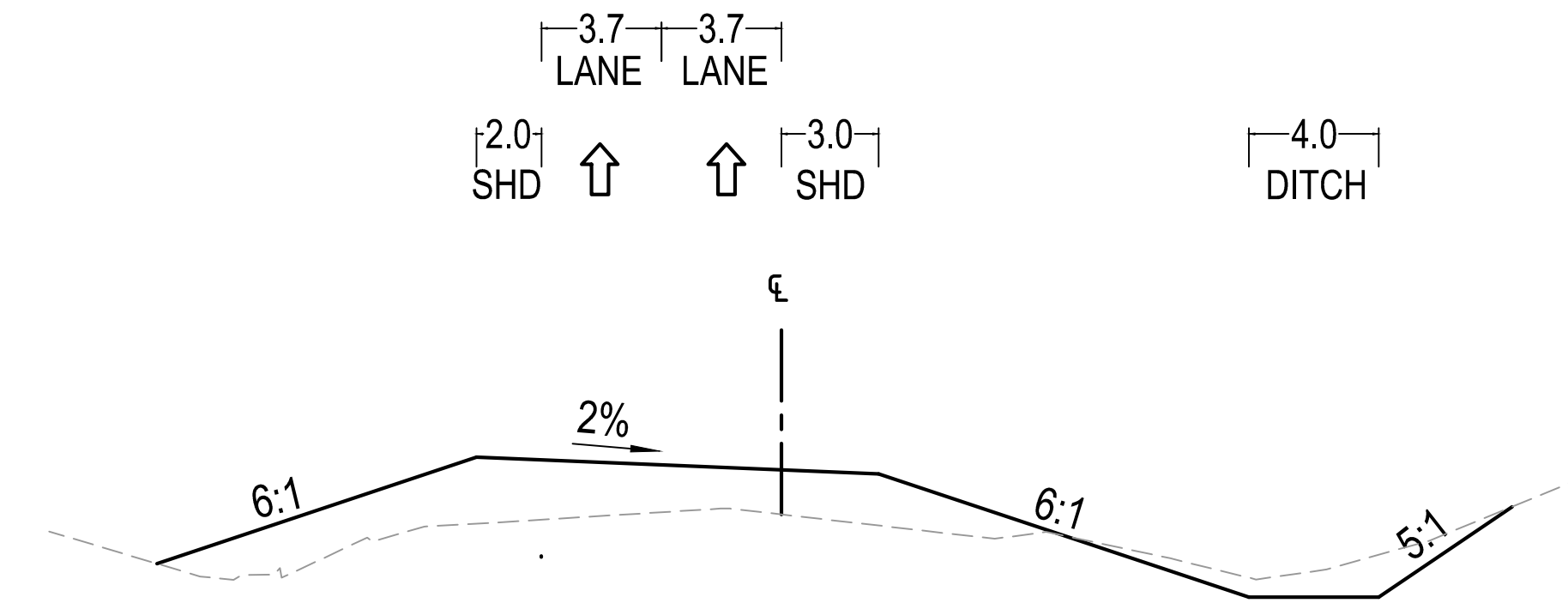

SECTION H
DOUBLE LANE RAMP



LEGEND

KEY PLAN

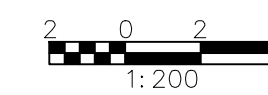

SCALE

FUNCTIONAL PLANNING STUDY
GLENMORE TRAIL EAST - STONEY TR TO RAINBOW RD (RANGE ROAD 283)
100 ST SE (GARDEN ROAD) INTERCHANGE
TYPICAL SECTIONS



JOB No.

PHOTOGRAPHY DATE

HIGHWAY
560.02

DATE

SHEET
3 OF 3

DRAWING NO.
TS3