

FILE: Z:\SPEC\ALT.CONTRACT\_SEED\_DIRECTORIES\CONSTRUCTION DRAFTING STANDARDS AND TEMPLATES\US\PL\PRODUCT\12345678C-102.DWG | DATE: Thursday, December 05, 2019 11:22:49 AM

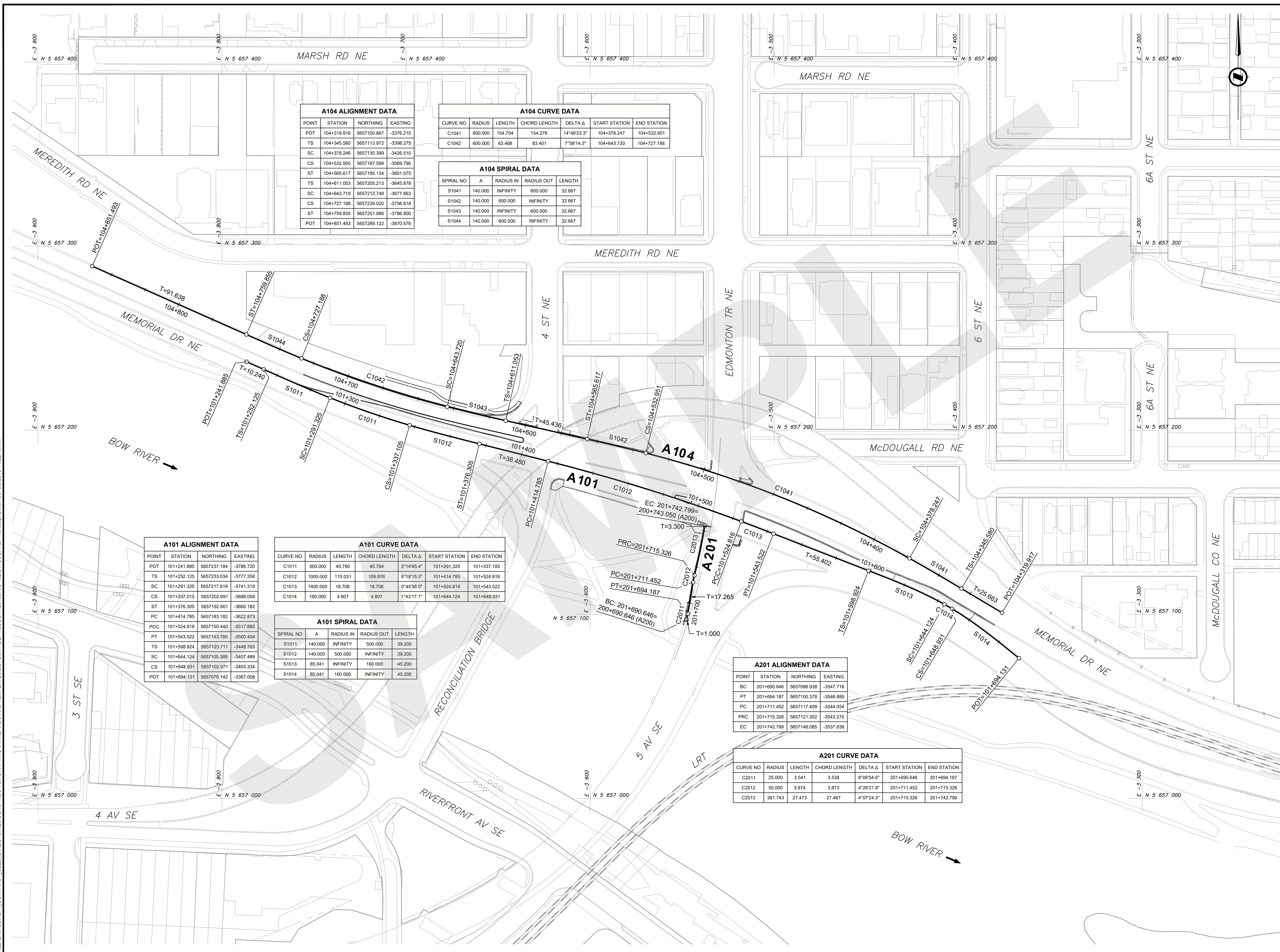

**A104 ALIGNMENT DATA**

POINT	STATION	NORTHING	EASTING
POT	104+319.916	5657100.867	-3376.210
TS	104+345.580	5657113.972	-3398.275
SC	104+378.246	5657130.399	-3426.510
CS	104+532.950	5657187.599	-3569.790
ST	104+565.617	5657195.134	-3601.675
TS	104+611.053	5657205.213	-3645.878
SC	104+643.719	5657212.748	-3677.663
CS	104+727.188	5657239.020	-3756.818
ST	104+759.855	5657251.986	-3786.800
POT	104+851.493	5657289.122	-3870.576

**A104 CURVE DATA**

CURVE NO	RADIUS	LENGTH	CHORD LENGTH	DELTA Δ	START STATION	END STATION
C1041	600.000	154.704	154.276	14°46'23.3"	104+378.247	104+532.951
C1042	600.000	83.468	83.401	7°56'14.3"	104+643.720	104+727.188

**A104 SPIRAL DATA**

SPIRAL NO	A	RADIUS IN	RADIUS OUT	LENGTH
S1041	140.000	INFINITY	600.000	32.667
S1042	140.000	600.000	INFINITY	32.667
S1043	140.000	INFINITY	600.000	32.667
S1044	140.000	600.000	INFINITY	32.667

**A101 ALIGNMENT DATA**

POINT	STATION	NORTHING	EASTING
POT	101+241.885	5657237.184	-3786.720
TS	101+252.125	5657233.034	-3777.358
SC	101+291.325	5657217.619	-3741.319
CS	101+337.015	5657202.691	-3698.059
ST	101+376.305	5657192.601	-3660.182
PC	101+414.785	5657183.182	-3622.873
PCC	101+524.816	5657150.440	-3517.885
PT	101+543.522	5657143.780	-3500.404
TS	101+598.924	5657123.711	-3448.765
SC	101+644.124	5657105.389	-3407.489
CS	101+648.931	5657102.971	-3403.334
POT	101+694.131	5657076.142	-3367.008

**A101 CURVE DATA**

CURVE NO	RADIUS	LENGTH	CHORD LENGTH	DELTA Δ	START STATION	END STATION
C1011	500.000	45.780	45.764	5°14'45.4"	101+291.325	101+337.015
C1012	1000.000	110.031	109.976	6°18'15.5"	101+414.785	101+524.816
C1013	1400.000	18.706	18.706	0°45'56.0"	101+524.816	101+543.522
C1014	160.000	4.807	4.807	1°43'17.1"	101+644.124	101+648.931

**A101 SPIRAL DATA**

SPIRAL NO	A	RADIUS IN	RADIUS OUT	LENGTH
S1011	140.000	INFINITY	500.000	39.200
S1012	140.000	500.000	INFINITY	39.200
S1013	85.041	INFINITY	160.000	45.200
S1014	85.041	160.000	INFINITY	45.200

**A201 ALIGNMENT DATA**

POINT	STATION	NORTHING	EASTING
BC	201+690.646	5657096.938	-3547.716
PT	201+694.187	5657100.378	-3546.889
PC	201+711.452	5657117.409	-3544.054
PRC	201+715.326	5657121.202	-3543.270
EC	201+742.799	5657148.085	-3537.638

**A201 CURVE DATA**

CURVE NO	RADIUS	LENGTH	CHORD LENGTH	DELTA Δ	START STATION	END STATION
C2011	25.000	3.541	3.538	8°06'54.6"	201+690.646	201+694.187
C2012	50.000	3.874	3.873	4°26'21.9"	201+711.452	201+715.326
C2013	381.743	27.473	27.467	4°07'24.3"	201+715.326	201+742.799

**NOTES**

- ALL PIPE SIZES ARE IN MILLIMETRES AND ALL DIMENSIONS ARE IN METRES UNLESS OTHERWISE NOTED.
- ALL COORDINATES AND DISTANCES ARE BASED ON 3TM COORDINATE SYSTEM (NAD 83).

**ALBERTA ONECALL** **NAD 83 COORDINATES**

**ISSUED FOR REVIEW**

NO.	DESCRIPTION	DATE	BY	APPD
A	ISSUED FOR REVIEW	2019-01-13	DEF	GHI

PERMIT: \_\_\_\_\_ SEAL: \_\_\_\_\_

DESIGNED	BY	DATE
ABC	ABC	2019-01-13
DRAWN	BY	DATE
DEF	DEF	2019-01-13
CHECKED	BY	DATE
GHI	GHI	2019-01-13

SCALE: 1:1000

**Calgary** CONSULTANT'S LOGO

PROJECT: **THE CITY OF CALGARY CONSTRUCTION DRAFTING STANDARDS AND TEMPLATES**  
SEC: 14, 15, 22 - TWP: 24 - RGE: 1 - W 5th M

SHEET TITLE: **CONTRACT SET ALIGNMENT SAMPLE SHEET**

FILE NO.	ENG DWG NO.		
12345678C-102.dwg	012.3456.005		
SHEET ID.	SHEET NO.		
<b>C-102</b>	<b>005</b>		
DRAWN	BY	DATE	PROFILE NO.

ISC: \_\_\_\_\_ SHEET SIZE ANSI D 25 mm

THIS DRAWING SAMPLE IS INTENDED TO ILLUSTRATE THE NEW CAD STANDARDS AND ARE FOR REFERENCE PURPOSES ONLY. PLEASE CONFIRM WITH YOUR APPROPRIATE CITY OF CALGARY CONTACT FOR SPECIFIC CONTENT REQUIREMENTS.