

FILE: Z:\SPECIALTY\CONTRACT_SEED_DIRECTORY\CONSTRUCTION DRAFTING STANDARDS AND TEMPLATES\DEV\SMPL-EXP-UPRODUCT\12345678C-104.DWG | DATE: Monday, November 21, 2022 1:34:27 PM

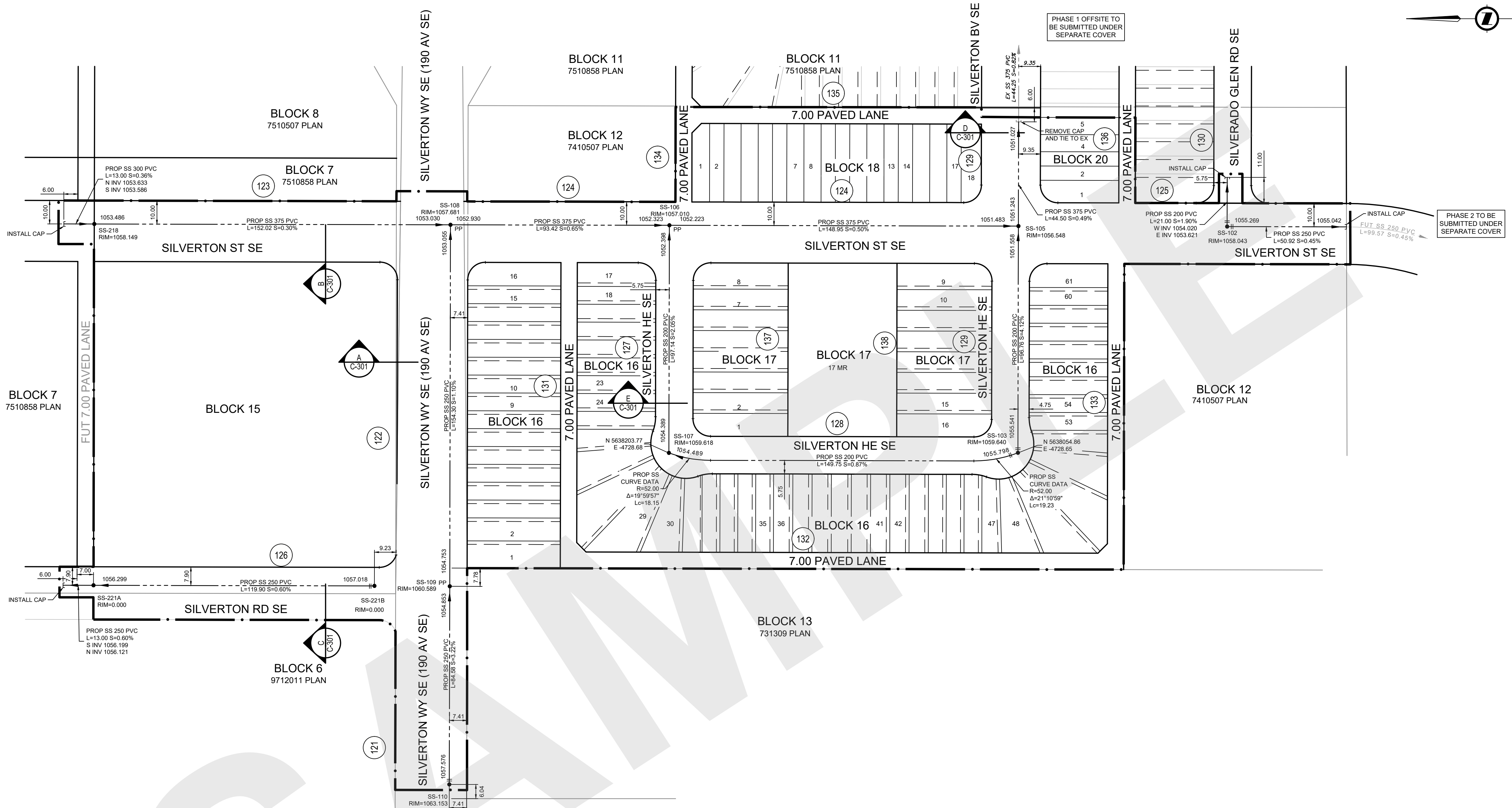

- LEGEND:**
- (X) BLOCK PROFILE DRAWING NUMBER
 - (PH 1 XXX) BLOCK PROFILE DRAWING NUMBER (DIFFERENT PHASE)
 - CONSTRUCTION BOUNDARY
 - PROP SS 200 PVC SANITARY SEWER
 - EX SS 200 PVC EXISTING SANITARY SEWER
 - FUT SS 200 PVC FUTURE SANITARY SEWER
 - TYPE 5A MANHOLE
 - EXISTING TYPE 5A MANHOLE
 - TYPE 1S MANHOLE
 - EXISTING TYPE 1S MANHOLE
 - ∩ CAP
 - SS-100 MANHOLE NUMBER
 - PP PLASTIC PLUG OR ONE-HOLE MANHOLE LID
 - || HIGH POINT

NOTES

- GENERAL NOTES (GN):**
- PIPE SIZES ARE IN MILLIMETRES AND ALL DIMENSIONS ARE IN METRES UNLESS OTHERWISE NOTED.
 - ALL COORDINATES AND DISTANCES ARE BASED ON 3TM COORDINATE SYSTEM (NAD 83).
 - ALL CONSTRUCTION AND MATERIALS TO BE IN ACCORDANCE WITH CURRENT CITY OF CALGARY SPECIFICATIONS.
 - NO CONSTRUCTION SHALL PROCEED UNTIL ALL APPROPRIATE REGULATORY APPROVALS ARE OBTAINED.
 - ALL PLANS SUBJECT TO TERMS OF THE DEVELOPMENT AGREEMENT/PERMIT AND THE CONTRACT DOCUMENTS.
 - ANY ERRORS OR DISCREPANCIES TO BE REPORTED TO THE ENGINEER PRIOR TO COMMENCEMENT OF CONSTRUCTION.
 - ALL FILL MATERIAL SHALL BE PLACED AND COMPACTED TO CITY OF CALGARY SPECIFICATIONS.
 - ALL ELEVATIONS ARE GEODETIC.
 - CONTRACTOR TO BE RESPONSIBLE FOR LOCATION AND ALIGNMENT OF ALL EXISTING UTILITIES.
 - CONTRACTOR TO TAKE CARE WHEN WORKING NEAR EXISTING INFRASTRUCTURE.
 - CONTRACTOR TO COORDINATE ALL CONSTRUCTION WITH ASSOCIATED OWNER(S) WHEN WORKING NEAR EXISTING INFRASTRUCTURE.
 - EXISTING SURFACE FEATURES TO BE REINSTATED TO CONDITIONS PRECEDING CONSTRUCTION WHERE EXISTING CONDITIONS WILL BE MAINTAINED.
 - COMBINED FACTOR APPLIED=0.999736 (1.000264)
 - ALL NORTHING-EASTING COORDINATES ARE AT SEA LEVEL.

- SANITARY SEWER NOTES (SSN):**
- ALL PVC PIPES TO BE DR35 UNLESS OTHERWISE NOTED.
 - ALL CIRCULAR CONCRETE PIPES TO BE CLASS IV UNLESS OTHERWISE NOTED.
 - ALL PIPE BACKFILL SHALL SATISFY A MINIMUM TYPE 2 INSTALLATION SPECIFICATION WITH CLASS 1A BEDDING.
 - CONTRACTOR TO TAKE CARE IN THE PLACEMENT OF MINIMUM AND NEAR MINIMUM SLOPE SEWERS.
 - CONTRACTOR TO ENSURE THAT THE SEALS ON ALL PIPE AND MANHOLE SEGMENTS ARE PROPERLY PLACED TO PREVENT LEAKAGE AND/OR INFILTRATION.
 - EXACT LOCATION OF ALL EXISTING INFRASTRUCTURE (HORIZONTAL AND VERTICAL) TO BE CONFIRMED IN THE FIELD BEFORE CONSTRUCTION BEGINS.
 - ALL EXISTING SANITARY SEWERS ARE OPERATIONAL AND MUST BE MAINTAINED AS SUCH DURING CONSTRUCTION OR SUITABLE ALTERNATE SERVICE CONDITIONS PROVIDED.
 - DETAILED INFORMATION SHOWN FOR EXISTING SEWERS ONLY WHERE TIE-INS TO THE EXISTING SYSTEM WILL BE MADE.



NAD 83 COORDINATES

ISSUED FOR PRELIMINARY APPROVAL

0	ISSUED FOR PRELIMINARY APPROVAL	2018-11-14	RCM	RG
NO.	DESCRIPTION	DATE (YYYY-MM-DD)	BY	APPD

PERMIT	SEAL
--------	------

DESIGNED	BY	DATE (YYYY-MM-DD)
DRAWN	LH	2018-07-09
CHECKED	RG	2018-09-01

SCALE 1:1000 0 20 40 m

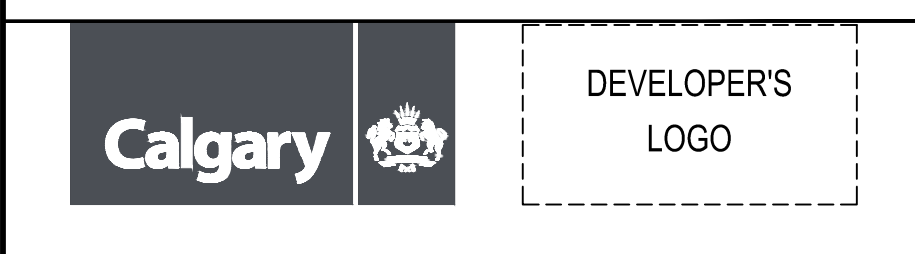

PROJECT
THE CITY OF CALGARY
CONSTRUCTION DRAFTING STANDARDS AND TEMPLATES
 SEC: 22 - TWP: 22 - RGE: 01 - W 5th M

SHEET TITLE
SUBDIVISION
SANITARY SEWERS
SAMPLE SHEET

FILE NO.	12345678C-104.dwg	ENG DWG NO.	
SHEET ID.	C-104	SHEET NO.	006
DRAWN	BY	DATE (YYYY-MM-DD)	PROFILE NO.

THIS DRAWING SAMPLE IS INTENDED TO ILLUSTRATE THE NEW CAD STANDARDS AND ARE FOR REFERENCE PURPOSES ONLY. PLEASE CONFIRM WITH YOUR APPROPRIATE CITY OF CALGARY CONTACT FOR SPECIFIC CONTENT REQUIREMENTS.