

FILE: Z:\SPECIAL\ITC CONTRACT_SEED_DIRECTORIES\CONSTRUCTION DRAFTING STANDARDS AND TEMPLATES\DEV\SNPL-EXP-2\PRODUCT\12345678C-106.DWG | DATE: Thursday, December 05, 2019 11:13:32 AM

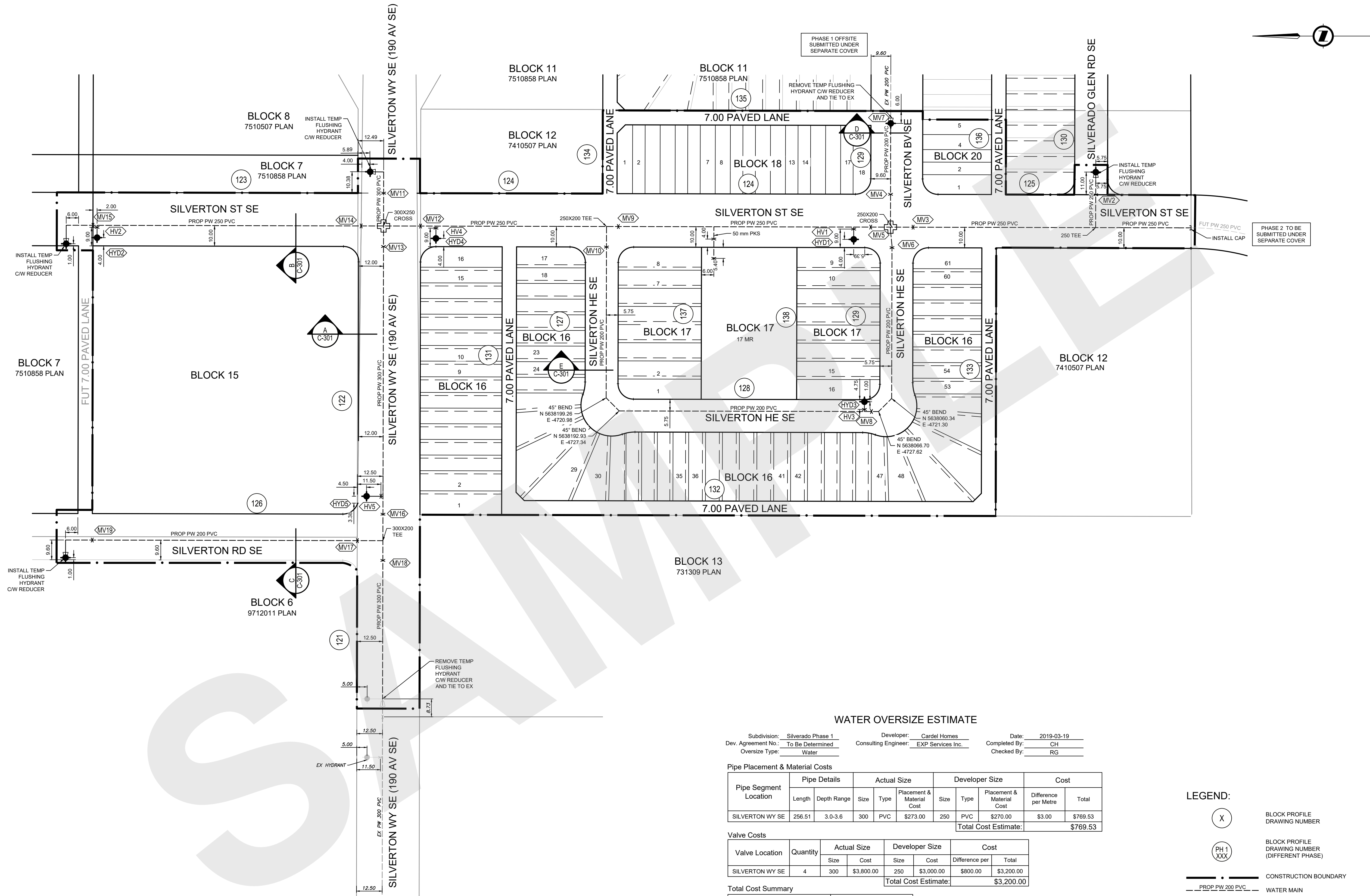

NOTES

- GENERAL NOTES (GN):**
- ALL PIPE SIZES ARE IN MILLIMETRES AND ALL DIMENSIONS ARE IN METRES UNLESS OTHERWISE NOTED.
 - ALL COORDINATES AND DISTANCES ARE BASED ON 3TM COORDINATE SYSTEM (NAD 83).
 - ALL CONSTRUCTION AND MATERIALS TO BE IN ACCORDANCE WITH CURRENT CITY OF CALGARY SPECIFICATIONS.
 - NO CONSTRUCTION SHALL PROCEED UNTIL ALL APPROPRIATE REGULATORY APPROVALS ARE OBTAINED.
 - ALL PLANS SUBJECT TO TERMS OF THE DEVELOPMENT AGREEMENT/PERMIT AND THE CONTRACT DOCUMENTS.
 - ANY ERRORS OR DISCREPANCIES TO BE REPORTED TO THE ENGINEER PRIOR TO COMMENCEMENT OF CONSTRUCTION.
 - ALL FILL MATERIAL SHALL BE PLACED AND COMPACTED TO CITY OF CALGARY SPECIFICATIONS.
 - ALL ELEVATIONS ARE GEODETIC.
 - CONTRACTOR TO BE RESPONSIBLE FOR LOCATION AND ALIGNMENT OF ALL EXISTING UTILITIES.
 - CONTRACTOR TO TAKE CARE WHEN WORKING NEAR EXISTING INFRASTRUCTURE.
 - CONTRACTOR TO COORDINATE ALL CONSTRUCTION WITH ASSOCIATED OWNER(S) WHEN WORKING NEAR EXISTING INFRASTRUCTURE.
 - EXISTING SURFACE FEATURES TO BE REINSTATED TO CONDITIONS PRECEDING CONSTRUCTION WHERE EXISTING CONDITIONS WILL BE MAINTAINED.
 - COMBINED FACTOR APPLIED=0.999736 (1/0.000264).
 - ALL NORTHING-EASTING COORDINATES ARE AT SEA LEVEL.

- WATER MAIN NOTES (WMN):**
- ALL WATER MAIN TO BE PVC DR15 UNLESS OTHERWISE NOTED.
 - ALL PIPE BACKFILL SHALL SATISFY THE MINIMUM WATERWORKS SPECIFICATIONS WITH CLASS 1A BEDDING.
 - MINIMUM DEPTH TO PIPE CROWN SHALL BE 3.00 METRES.
 - ALL WATER MAINS AND APPURTENANCES MUST BE PROPERLY TESTED PRIOR TO UTILIZATION.
 - PRIOR TO COMMENCING AND DURING ANY PRESSURE TESTING, CHLORINATING, OR FLUSHING OF MAINS, A WATER SERVICES INSPECTOR MUST BE ON SITE.
 - NO HYDRANTS ARE TO BE USED FOR CONSTRUCTION WATER UNLESS OTHERWISE AUTHORIZED.
 - EXACT LOCATION OF ALL EXISTING INFRASTRUCTURE (HORIZONTAL AND VERTICAL) TO BE CONFIRMED IN THE FIELD BEFORE CONSTRUCTION BEGINS.
 - WATER INFRASTRUCTURE TO MAINTAIN A MINIMUM 3.00 SEPARATION FROM TREES, STREET LIGHTS, AND CATCH BASINS.
 - ALL EXISTING WATER MAINS ARE OPERATIONAL AND MUST BE MAINTAINED AS SUCH DURING CONSTRUCTION OR SUITABLE ALTERNATE SERVICE CONDITIONS PROVIDED.
 - ALL EXISTING WATER MAINS SHOWN ARE PART OF OTHER SCOPES OF DEVELOPMENT AND INCLUDED IN SEPARATE DRAWING SUBMISSION SETS.
 - FOR COLLECTOR ROAD TRAFFIC VOLUMES & GREATER, INSTALL DEEP VALVE BOX LIDS AS PER CITY OF CALGARY STANDARD SPECIFICATIONS: WATERWORKS CONSTRUCTION SPEC 453.1006.006p2.



ISSUED FOR PRELIMINARY APPROVAL

0	ISSUED FOR PRELIMINARY APPROVAL	2019-11-14	RCM	RG
---	---------------------------------	------------	-----	----

NO.	DESCRIPTION	DATE (YYYY-MM-DD)	BY	APPD
PERMIT	SEAL			

DESIGNED	BY	DATE (YYYY-MM-DD)
	RCM	2018-07-09
DRAWN	BY	DATE (YYYY-MM-DD)
	LH	2018-07-09
CHECKED	BY	DATE (YYYY-MM-DD)
	RG	2018-09-01

SCALE 1:1000 0 20 40m

PROJECT
THE CITY OF CALGARY
CONSTRUCTION DRAFTING STANDARDS AND TEMPLATES
 SEC: 22 - TWP: 22 - RGE: 01 - W 5th M

SHEET TITLE
SUBDIVISION WATER MAINS SAMPLE SHEET

FILE NO. 12345678C-106.dwg	ENG DWG NO.	
SHEET ID. C-106	SHEET NO. 008	
BY	DATE (YYYY-MM-DD)	PROFILE NO.

WATER OVERSIZE ESTIMATE

Subdivision: Silverado Phase 1 Developer: Cardel Homes Date: 2019-03-19
 Dev. Agreement No.: To Be Determined Consulting Engineer: EXP Services Inc. Completed By: CH
 Oversize Type: Water Checked By: RG

Pipe Placement & Material Costs

Pipe Segment Location	Pipe Details		Actual Size		Developer Size		Cost			
	Length	Depth Range	Size	Type	Placement & Material Cost	Size	Type	Placement & Material Cost	Difference per Metre	Total
SILVERTON WY SE	256.51	3.0-3.6	300	PVC	\$273.00	250	PVC	\$270.00	\$3.00	\$769.53
Total Cost Estimate:									\$769.53	

Valve Costs

Valve Location	Quantity	Actual Size		Developer Size		Cost	
		Size	Cost	Size	Cost	Difference per	Total
SILVERTON WY SE	4	300	\$3,800.00	250	\$3,000.00	\$800.00	\$3,200.00
Total Cost Estimate:							\$3,200.00

Total Cost Summary

Description	Cost
Total Pipe Placement & Material Costs	\$769.53
Total Valve Costs	\$3,200.00
Subtotal	\$3,969.53
Administration (11.0%)	\$436.65
Total Estimated Claim:	\$4,406.18

NOTES:
 1. Calculations are based on the 2018 City of Calgary Development Agreement Rates

- LEGEND:**
- (X) BLOCK PROFILE DRAWING NUMBER
 - (PH 1 XXX) BLOCK PROFILE DRAWING NUMBER (DIFFERENT PHASE)
 - PROP PW 200 PVC --- WATER MAIN
 - EX PW 200 PVC --- EXISTING WATER MAIN
 - FUT PW 200 PVC --- FUTURE WATER MAIN
 - ◆ VALVE
 - ◆ HYDRANT w/ VALVE
 - ◆ EXISTING HYDRANT w/ VALVE
 - CAP
 - REDUCER
 - ◁ MV ▷ WATER MAIN VALVE NUMBER
 - ◁ HYD ▷ HYDRANT NUMBER