

Guidelines for all fire lanes and access to fire fighting infrastructure (hydrants, stand pipes, siamese connections)
Provide 3 meters of clear space from front of object, this includes what exists above head as per example below.

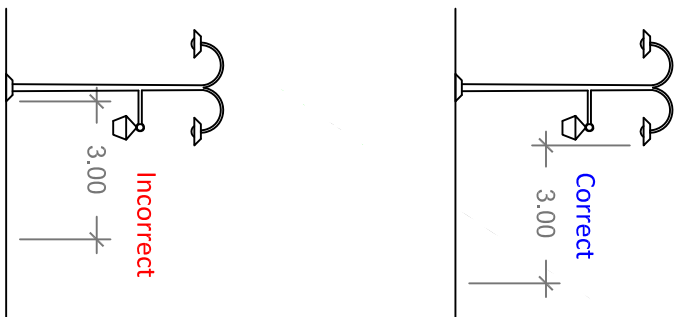

Guidelines for all fire hook-up types:
Provide 2 meters of clear space from front of hydrant [side with largest port] and 1.5 meters on both sides adjacent to largest port [3m total].

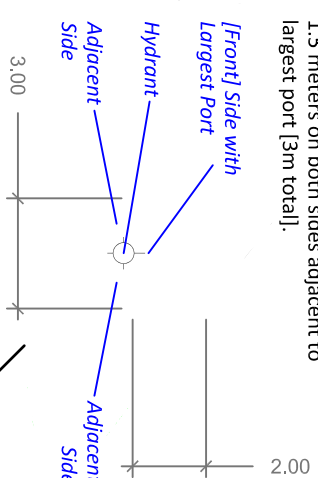

Definition of a Fire Lane Road: 6m of clear driving access free of obstructions including what is above, such as tree branches, light standards, signage etc.

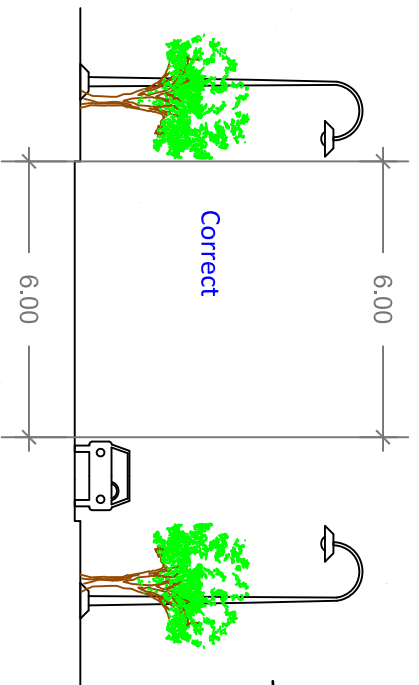

Parks preferred location for roll off garbage bins or dumpsters.

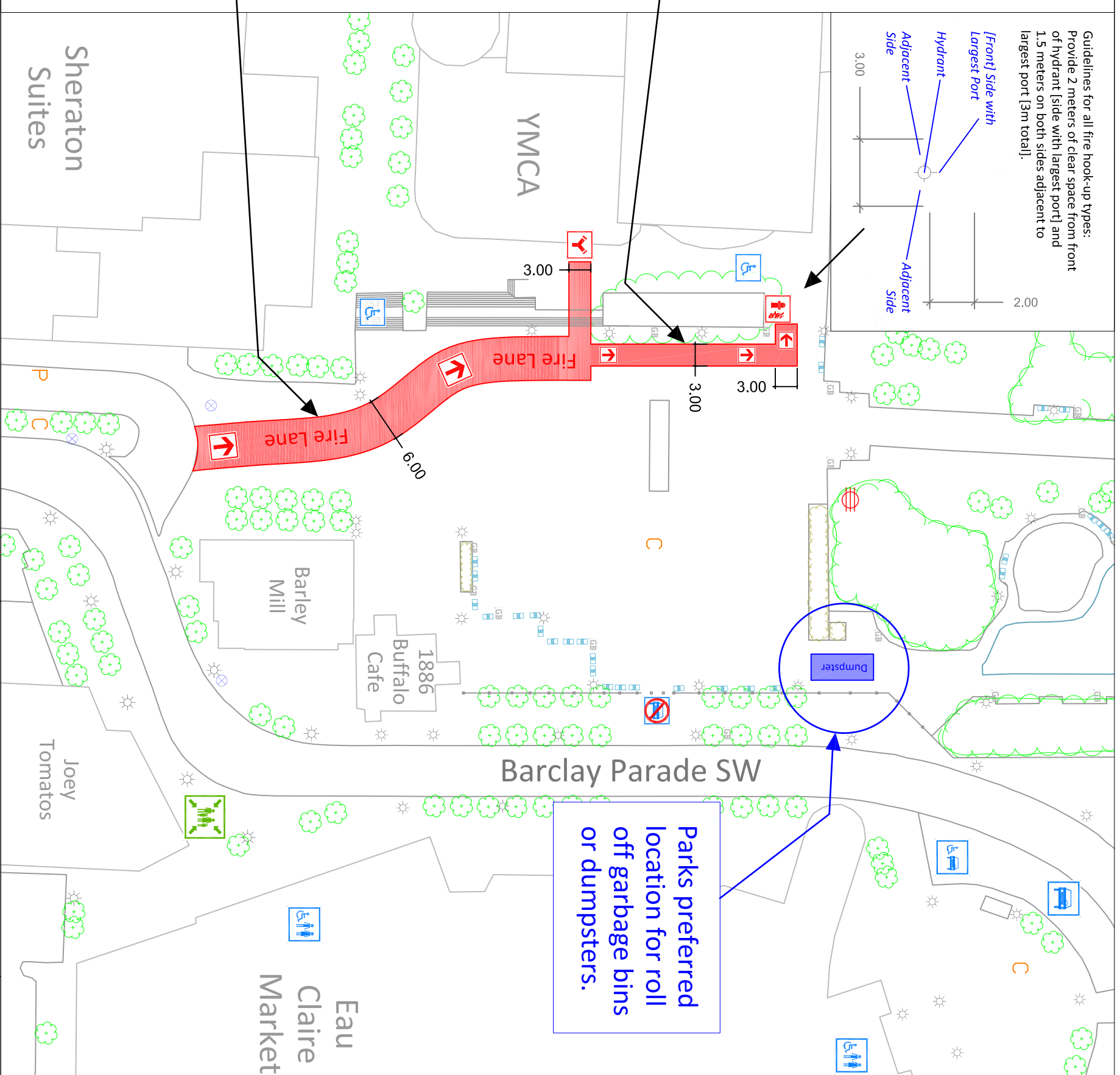

Legend

- Tree
- P Paved Area
- C Concrete Area
- G Gravel Area
- Storm Sewer
- Manhole
- Electrical Cabinet
- Power Pole
- Misc. Pole
- Pedestal
- Street Light Pole
- Traffic Light Pole
- GB Garbage Bin
- Benches
- Power Service
- Hydrant Point
- Siamese Connection Point
- Water Main Point
- Fire Extinguisher Point
- Supplimentary Directions [can be used in labeling fire lane]
- Muster Point
- Accessible Parking Point
- Parking Point
- Restricted Parking Point
- Accessible Washroom Point
- Accessible Point

Map Name: CFD Fire Lane Guidelines
+ Parks Garbage Bin & Power Notes
Site Name: Festival Market
Address: 139 Barclay Parade SW

Map Scale = 1:16
All dimensions displayed in meters rounded to nearest cm.
Metric: 0 1.2 2.4 4 8 14 20m
Imperial: 0 4 8 16 32 56'

THIS MAP WAS PRODUCED BY THE CITY OF CALGARY/REGISTRATION | CULTURE, RECREATION AND PARKS DEPARTMENT | THE CITY OF CALGARY
ALL RIGHTS RESERVED. THIS MAP MAY BE NOT BE REPRODUCED IN ANY FORM OR BY ANY MEANS WITHOUT THE WRITTEN CONSENT OF THE CITY OF CALGARY AND THE CITY OF CALGARY PROVIDES THIS INFORMATION IN GOOD FAITH, BUT PROVIDES NO WARRANTY OR ACCEPTS ANY LIABILITY ARISING FROM INCOMPLETE, INCOMPLETE OR MISLEADING INFORMATION OR ITS IMPROPER USE.