



114 Avenue and Barlow Trail Piling and Road Realignment

Notice Date: August 20, 2025

As early as August 24, roadwork will shift to its next phase. Some preparatory work is already underway to support lane adjustments to create space for piling activities. The adjustments include installation of a temporary turn lane from northbound Barlow Trail to eastbound 114 Avenue and the removal of the eastbound-to-southbound turn lane from 114 Avenue to Barlow Trail.

What

Lane alterations, median removal, pedestrian detours

When

August 18 – September 18

Where

114 Avenue and Barlow Trail S.E.

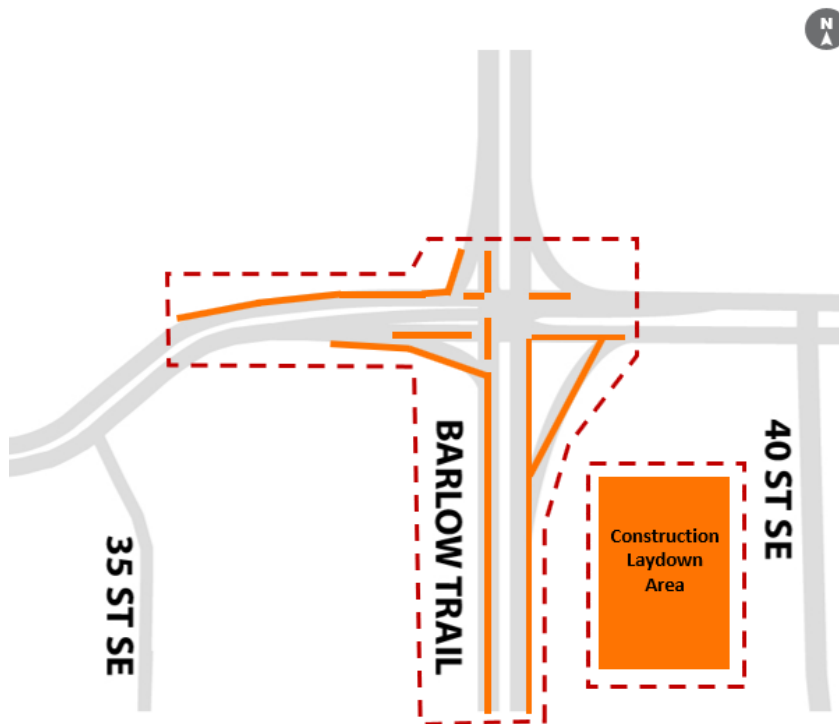

Impacts



Pedestrian detours



Lane closures



Lane removal and installation



Construction noises

Legend



Impacted Area



Active Construction



Temporary Access



Entrance/Exit Closed

For more information and additional impacts see below or visit [Calgary.ca/greenline](https://calgary.ca/greenline).



Green Line LRT

What is the work? [Work description from the What and Where sections](#)

This is a phased project that will proceed until late-fall 2025, with work both scheduled to resume and be completed in late-spring 2026. The work at 114 Avenue and Barlow Trail during this phase includes roadworks and piling activities. This staged approach minimizes impacts to the public, surrounding businesses and drivers, while maintaining pedestrian safety.

For more information or if you have any questions, please call 311 or email the project team at greenline@calgary.ca

About [Green Line LRT – SE Project](#)

The SE Segment, from Shepard in the southeast to the Event Centre/Grand Central Station in the Beltline, will build the first 16 kilometres of an overall 46-kilometre vision, before connecting with the future Downtown Segment and into the existing Red and Blue LRT Lines. Including the Downtown Segment, Phase 1 will build, 17.2 kilometres of twin-track LRT infrastructure, 12 new stations, a maintenance and storage facility, three Park and Ride lots, and 28 new modern low-floor light rail vehicles.