



## Green Line LRT: **Road Closures at 11 Avenue S.E. and Olympic Way**

**Notice Date:** March 10, 2023 (Update)

**Construction Start:** March 15, 2023

**Duration:** Approximately 3 months

**Beginning March 15, the intersection of Olympic Way S.E. and 11 Avenue will be partially closed, with movement limited to west-to-north and south-to-east only. Olympic Way S.E. will also be closed between 11 and 12 Avenue.**

Both 11 and 12 Avenue S.E. will be configured to fully maintain localized access to buildings and businesses.

Some area crosswalks and sidewalks will be closed or restricted. Please follow detour signage.

The cycle track detour remains in place at 3 Street S.E., facilitating movement between 12 Avenue and Olympic Way S.E. via 10 Avenue.

Approximately two hours prior to and following major events in the area, an alternative traffic configuration will be in place, facilitating access and egress. Please follow detours and traffic controls.

Additional utility construction remains active further east on 12 Avenue between 5 and 6 Street S.E.

### **What is the work?**

New and upgraded water, stormwater, and sanitary infrastructure will be installed to make way for the eventual Green Line LRT tunnel on 11 Avenue.

Additional third-party utility work will remain active along 5 Street S.E. as required from 9:00 AM to 3:00 PM throughout March 2023.

If you have any questions about work along 5 Street S.E., please reach out to the ENMAX Customer Relations Team: 403-514-3990 - [powercustomerrelations@enmax.com](mailto:powercustomerrelations@enmax.com) [www.enmax.com/projects/greenline](http://www.enmax.com/projects/greenline)

### **What can you expect?**

- Full closure of Olympic Way S.E. between 11 and 12 Avenue
- Full closure on 12 Avenue between 5 and 6 Street S.E.
- Tree removals along Olympic Way between 11 and 12 Avenue S.E.
- Detour in place for cycle track at 3 Street S.E. for duration of Beltline Downtown Utility Relocation Project
- Reduced pedestrian access

For more information on the comprehensive impacts to this area, please see the map below.



## **G** Green Line LRT

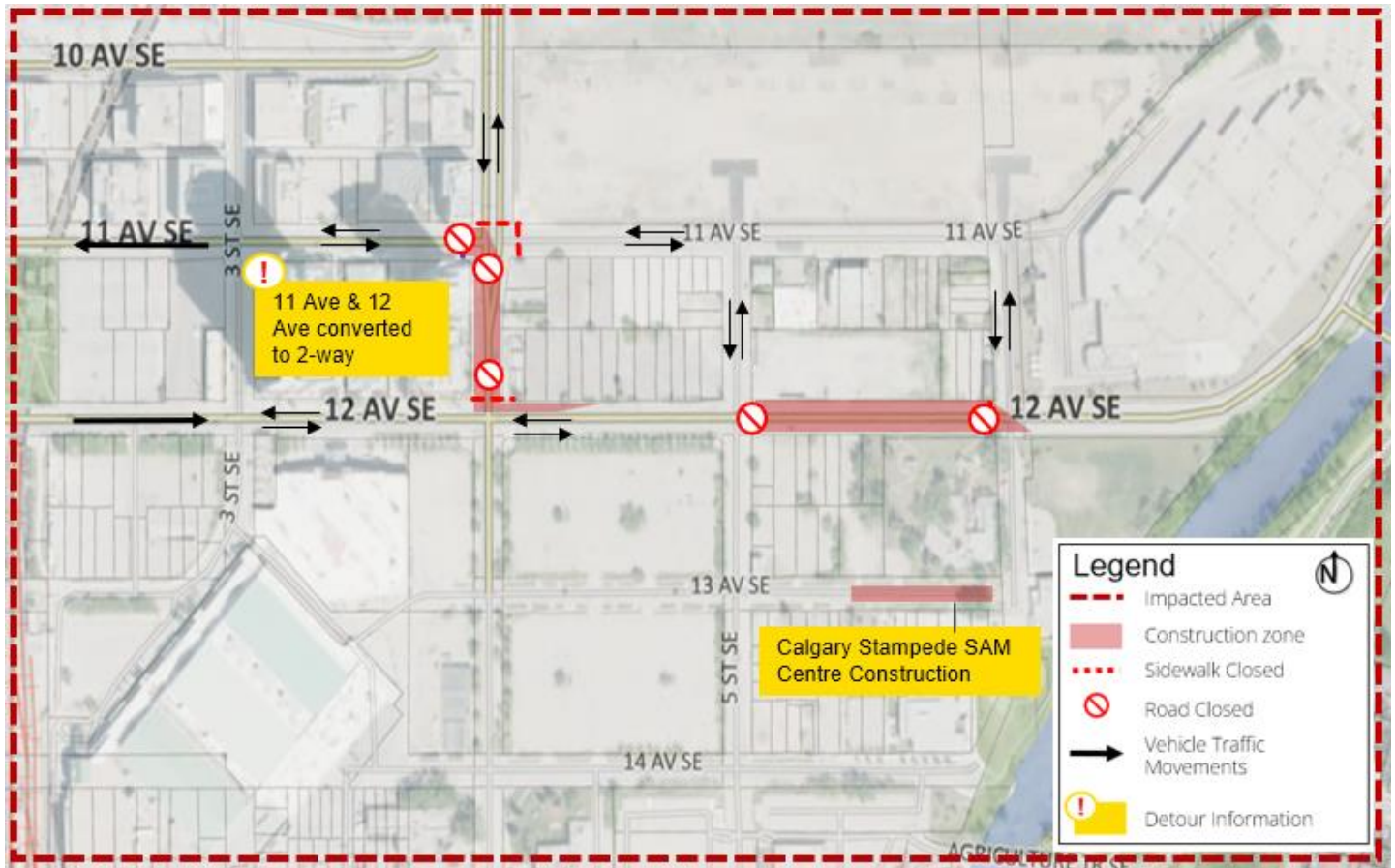

### **Contact Information**

For more information about this project or if you have any questions about the Green Line LRT project, please contact 311 or email [greenline@calgary.ca](mailto:greenline@calgary.ca)

### **About Green Line LRT**

The Green Line is Calgary's next light rail transit (LRT) line. With \$4.9 billion in commitments from the Government of Canada, Government of Alberta and City of Calgary, it is the largest infrastructure investment in our city's history.

The current work in Beltline and Downtown is part of the utility relocation program required to make way for Phase 1 construction from Shepard to Eau Claire.

Accessibility is a priority for Green Line. If you have concerns with accessing information or navigating around construction, please contact [greenline@calgary.ca](mailto:greenline@calgary.ca)