



Green Line LRT Road Closures for Utility Work

START DATE: APRIL 11, 2022

Notice: April 25, 2022

As part of the Beltline Downtown Utility Relocation Project, there are multiple utility activities taking place, impacting 12 Avenue S.E. between 3 Street S.E. and 6 Street S.E. This phase of work will require multiple lane closures, including one full block closure between 5 Street S.E. and 6 Street S.E. Two lanes of 12 Avenue between 5 Street S.E. and 6 Street S.E. will be re-opened to facilitate traffic movement for major events. The cycle track between 3 Street S.E. and Olympic Way S.E. will also be closed. Detour signage will be in place. There will be a lane reduction along 12 Avenue S.E. between Olympic Way and 5 Street S.E.

All area parking lots remain open during construction.

What is the work?

Utility Casing and Deep Utilities (Water, Sanitary, Storm Water) Activities

Utility casing installation and deep utility construction are scheduled to begin April 11 and will be underway for 10-11 weeks. This upgraded utility infrastructure will make way for Green Line LRT construction and support the future build out of Calgary's Culture and Entertainment (C+E) District. Access to the Macdonald Avenue Bridge will remain throughout construction. Please follow detour signage when traveling in the area.

ENMAX Activities

ENMAX Power is required to relocate underground electrical infrastructure to accommodate future construction of The City of Calgary's Green Line project. ENMAX work will occur in two phases, including electrical and construction, with varying impacts. ENMAX understands that this work may create some inconveniences, and thanks you for your understanding and cooperation as ENMAX delivers on its commitment to provide reliable power to all Calgarians.



G Green Line LRT

What can you expect?

Utility Casing and Deep Utilities Activity

- Closure of two southernmost lanes on 12 Avenue S.E. between Olympic Way S.E. and 5 Street S.E.
- Full block closure on 12 Avenue S.E. between 5 Street S.E. and 6 Street S.E. Two lanes will be re-opened to accommodate east-west travel for major events.
- Closure of southern sidewalk on 12 Avenue between Olympic Way S.E. and 6 Street S.E.
- On-street parking removed.
- Removal of trees on south side of 12 Avenue S.E.
- There will be general construction noise and increased construction traffic in the area.
- Work will occur between 7:00 a.m. and 7:00 p.m. daily and may extend beyond 7:00 p.m. if necessary to complete certain portions of work.
- Construction duration of this phase is approximately 10-11 weeks.

ENMAX Activity

- Cycle track along 12 Avenue S.E. will be closed with detour routes available; please follow signage.
- Lane closures along 12 Avenue S.E. at Olympic Way S.E.; please follow traffic signage.
- Sidewalk access will be maintained.
- ENMAX and contractor vehicles and associated utility equipment will be onsite.
- Construction barricades and/or safety fencing.
- Project and/or road signage.
- Noise and/or minor vibrations during construction.
- A power outage is not required to facilitate this work.

If you have any questions about this specific project, please reach out to ENMAX Customer Relations Team:

403-514-3990

powercustomerrelations@enmax.com

www.enmax.com/projects/greenline

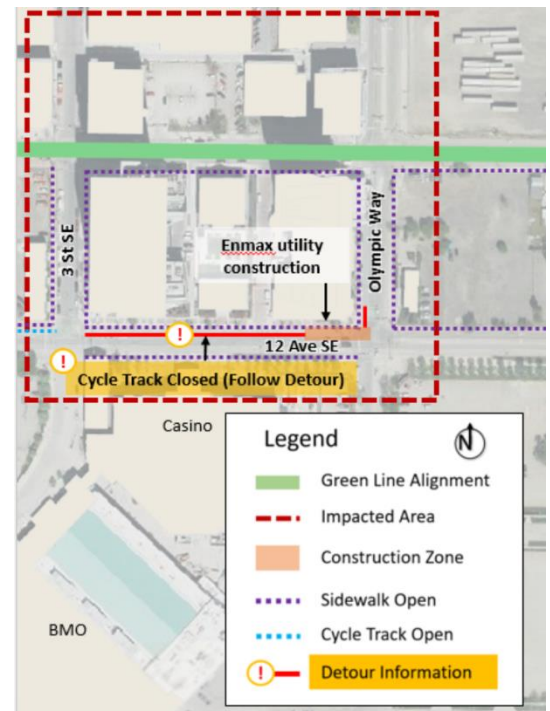

Please see map on Page 3 for location and description of comprehensive impacts related to these construction activities.



Comprehensive Utility Construction Impacts (12 Avenue S.E.) – Anticipated start date: April 11

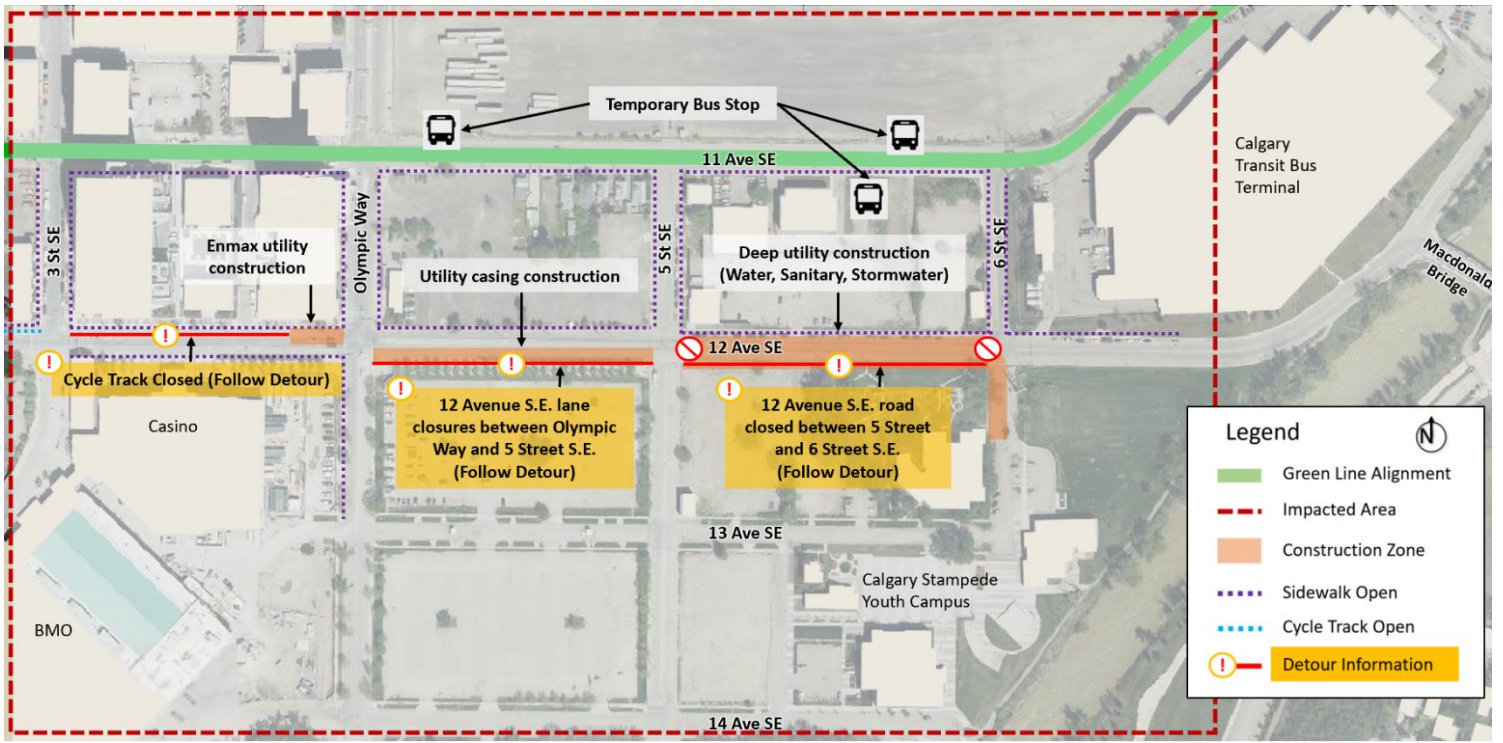

***NOTE:** Two traffic lanes to be re-opened on 12 Avenue S.E. between 5 Street and 6 Street S.E. for major events.

CONTACT INFORMATION

For more information about the Utility Casings and Deep Utilities activities or if you have any questions about the Green Line LRT project, please contact Adam Noble-Johnson at adam.noble-johnson@calgary.ca or 403-899-0139.

About Green Line LRT

The Green Line is Calgary's next light rail transit (LRT) line. It is also the largest infrastructure investment in our city's history. It comes with \$4.9 billion in commitments from the Government of Canada, Government of Alberta and City of Calgary.

Stage 1 will be built in 2 phases aligning with Council direction to build the Green Line in a stage-gate project approach. Phase 1 will build 18km of the LRT from Shepard to Eau Claire allowing for easier expansion both North and South. The current work in the Beltline and Downtown areas is part of the utility relocation program required to make way for Phase 1 construction.

Green Line is an important part of Calgary's economic recovery creating 20,000 jobs in Stage 1 alone and serves as a platform for long-term city building that will encourage redevelopment and investment opportunities in Calgary.

For more information about the Green Line project, please visit www.calgary.ca/greenline.