



## Green Line LRT

# Upcoming Road Closures for Utility Work

IMPACTS ANTICIPATED TO BEGIN: July 20, 2022

**Update: July 21, 2022**

As part of the Beltline Downtown Utility Relocation Project, multiple utility projects will be in active construction in the Beltline East area. This phase of work will require an intersection closure and lane closures along 12 Avenue S.E. The cycle track between 3 Street S.E. and Olympic Way S.E. will be rerouted via 3 Street S.E. to 10 Avenue S.E. for the duration of the project. Detour and wayfinding signage will be in place. Access to the Macdonald Avenue Bridge will remain open throughout construction.

**Beginning July 20, there will be partial lane closures in the area to accommodate third-party utility construction.**

**Beginning July 23, the intersection at Olympic Way S.E. and 12 Avenue S.E. will be completely closed to vehicle and cycling traffic. A detour will be installed, converting 11 Avenue S.E. to two-way travel between Olympic Way and 3 Street S.E.**

**NEW:** Beginning July 25, the two south lanes of 12 Avenue S.E. between 5 Street and 6 Street S.E. will be closed, bi-directional traffic will be maintained. One way traffic southbound on 6 Street S.E. will be maintained but shifted to the east side of the Street as part of this detour.

### What is the work?

#### Deep Utilities (Water, Sanitary, Storm Water) and Third-Party Utilities Project

New, enhanced City-owned deep utilities and third-party shallow utility infrastructure will be installed. This will include a full closure in the intersection of Olympic Way S.E. and 12 Avenue, which will remain in place until Fall 2022, additionally lane closures along 12 Avenue S.E. between 5 Street S.E. and 6 Street S.E. and along 6 Street S.E. south of 12 Avenue S.E. will be in place. Please follow detour signage.

Additional third-party utility work will also be active in this intersection. If you have any questions about this specific work, please reach out to ENMAX Customer Relations Team:

403-514-3990

[powercustomerrelations@enmax.com](mailto:powercustomerrelations@enmax.com)

[www.enmax.com/projects/greenline](http://www.enmax.com/projects/greenline)

### What can you expect?

Utility Casing and Deep Utilities Project



## **G** Green Line LRT

- **NEW:** Closure of two southernmost lanes on 12 Avenue S.E. between 5 Street S.E. and 6 Street S.E., and 6 Street S.E. south of 12 Avenue S.E. will be one-way traffic
- Closure of the intersection at Olympic Way S.E. and 12 Avenue S.E. to cyclists and vehicles
- Conversion of one block of 11 Avenue S.E. to two-way travel between Olympic Way S.E. and 3 Street S.E.
- Removal of on-street parking
- Some tree removal required near Olympic Way S.E. and 12 Avenue S.E.
- Access to local business will remain open throughout construction
- Local traffic eastbound will be maintained via a lane reversal along 11 Avenue, leading to 5 Street S.E. which will remain open for use.
- General construction noise and increased construction traffic in the area
- Intersection closure will continue into Fall 2022
- Pedestrian movements around the intersection will be maintained
- Cycle track will be closed between 3 Street and Olympic Wy. S.E. for the duration of the Beltline Downtown Utility Relocation Project. Alternate routing is provided via 3 Street and 10 Avenue S.E.

### Comprehensive Utility Construction Impacts (12 Avenue S.E.)

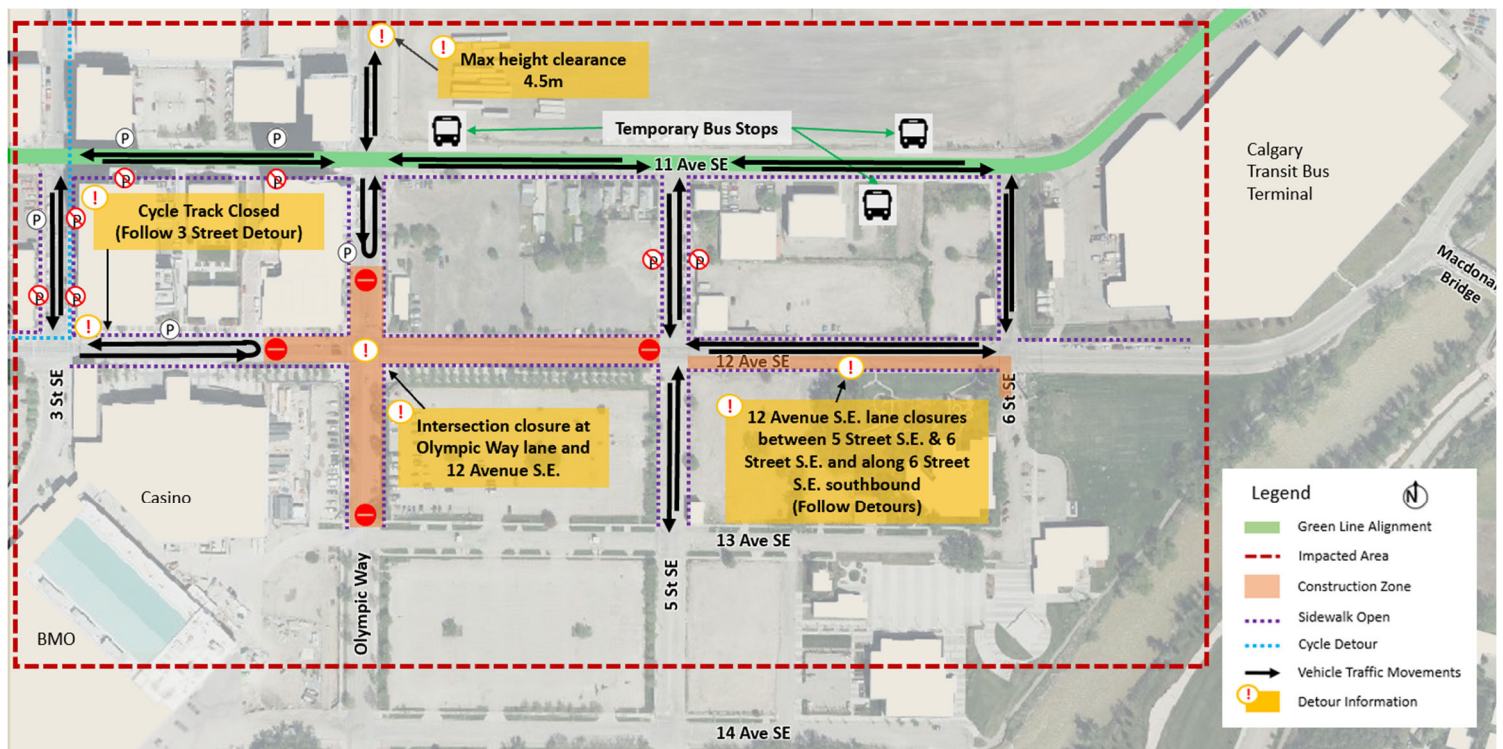



## Green Line LRT

---

### Contact Information

For more information about the Utility Casings and Deep Utilities Project or if you have any questions about the Green Line LRT project, please contact 311 or email [greenline@calgary.ca](mailto:greenline@calgary.ca).

### About Green Line LRT

The Green Line is Calgary's next light rail transit (LRT) line. It is also the largest infrastructure investment in our city's history. It comes with \$4.9 billion in commitments from the Government of Canada, Government of Alberta, and City of Calgary.

Stage 1 will be built in 2 phases aligning with Council direction to build the Green Line in a stage-gate project approach. Phase 1 will build 18km of the LRT from Shepard to Eau Claire allowing for easier expansion both North and South. The current work in the Beltline and Downtown areas is part of the utility relocation program required to make way for Phase 1 construction.

Green Line is an important part of Calgary's economic recovery creating 20,000 jobs in Stage 1 alone and serves as a platform for long-term city building that will encourage redevelopment and investment opportunities in Calgary.

For more information about the Green Line project, please visit [www.calgary.ca/greenline](http://www.calgary.ca/greenline)