

**CROSS - SECTIONS**

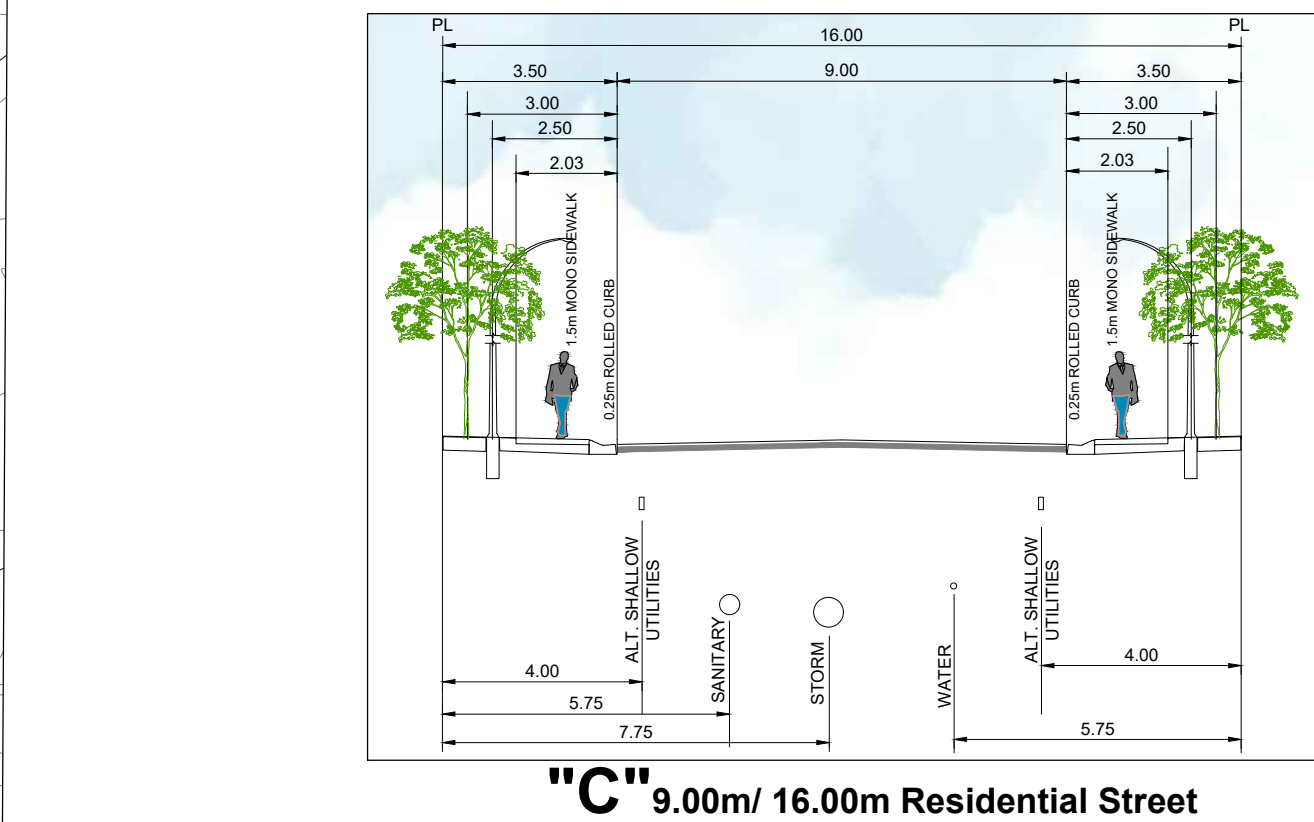

**PROPOSED LAND USE**

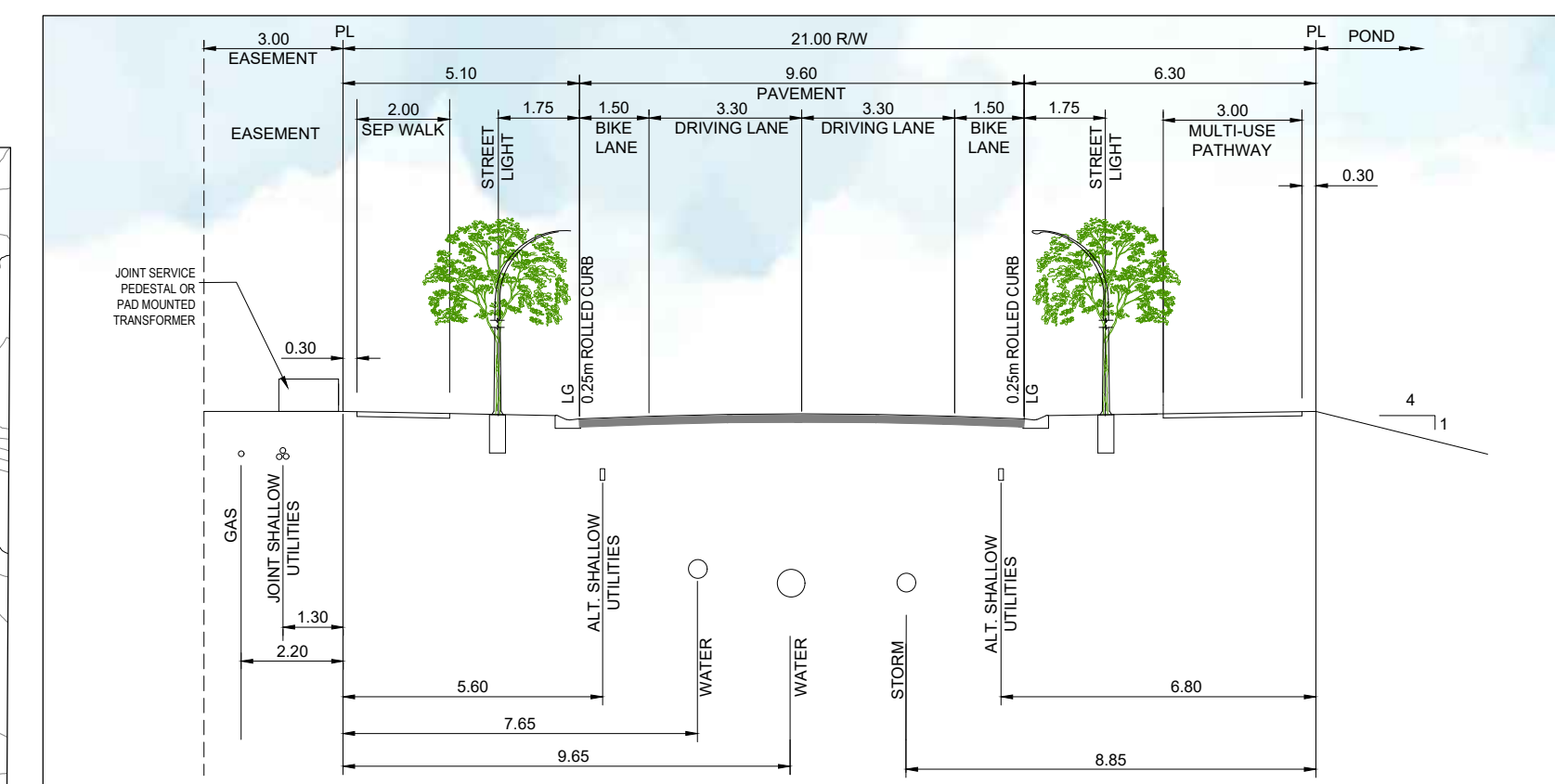
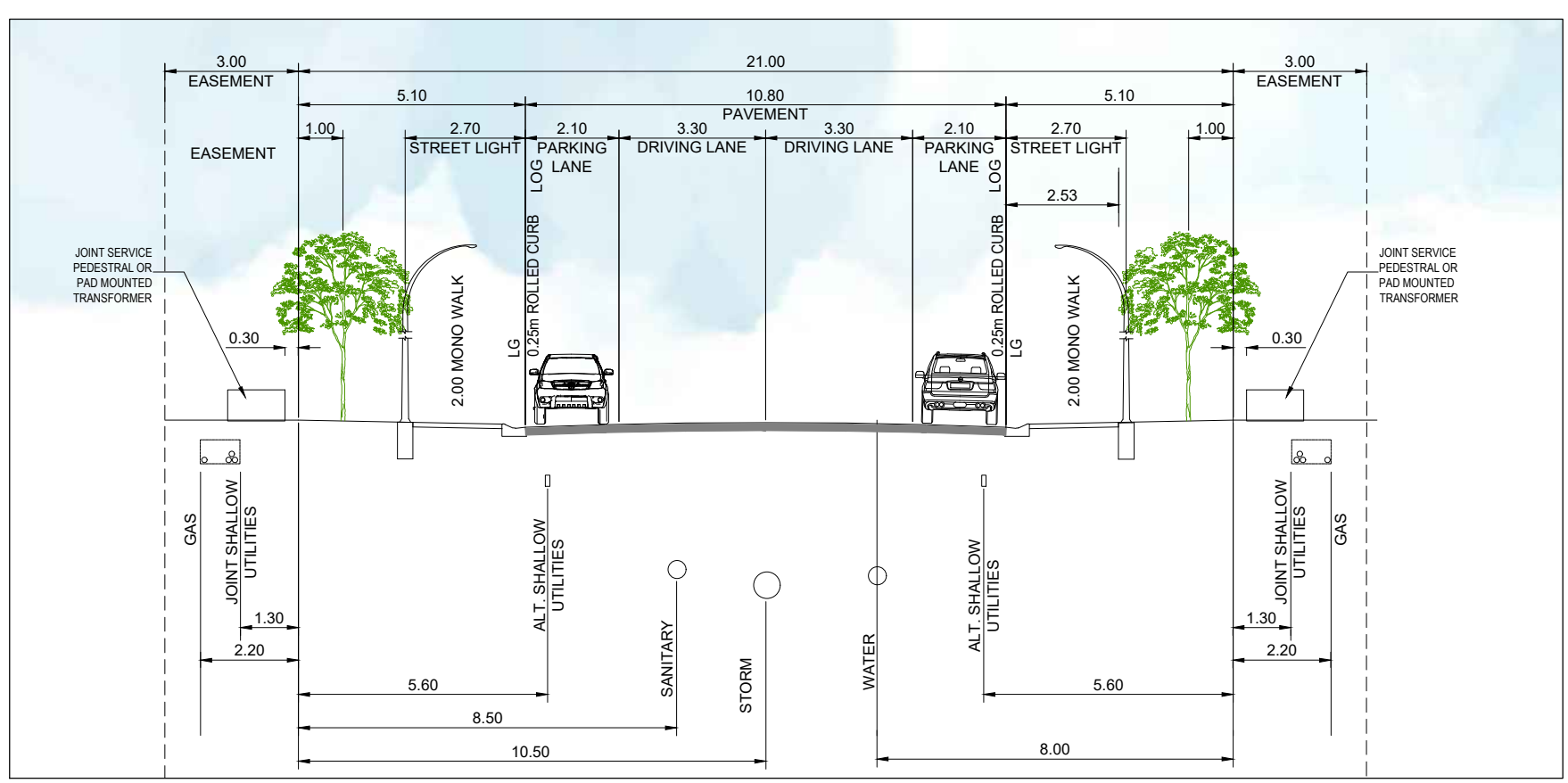
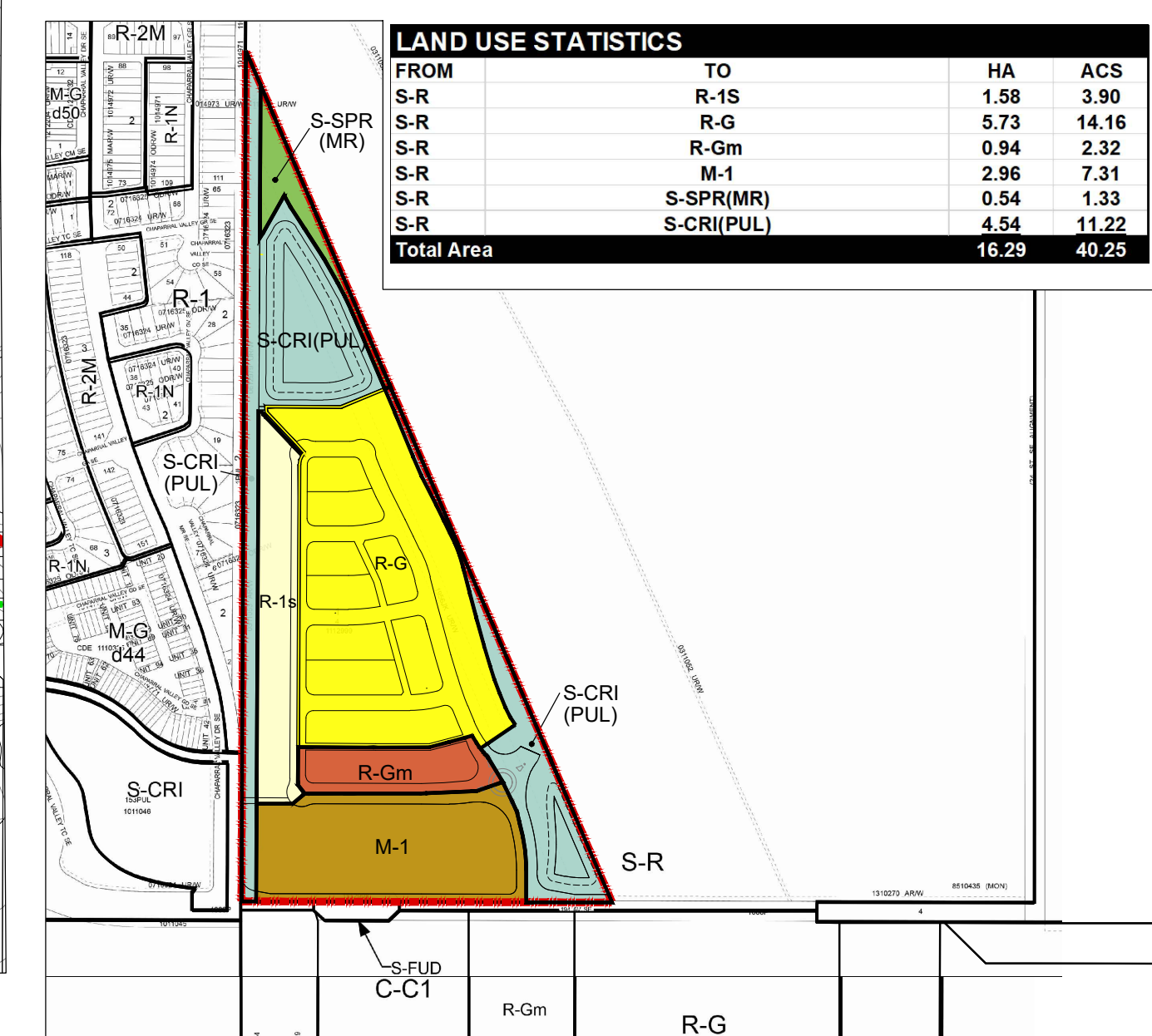

**prime consultant:**  
**B&A Planning Group**  
 600, 215 - 9th Ave SW  
 | Calgary, Alberta | T2P 1K3 | [bagp.ca](http://bagp.ca)  
 t: 403 269 4733 f: 403 262 4480

**copyright:**  
 Any reproduction or distribution for any purpose other than authorized by B&A Planning Group is forbidden. Written dimensions shall have precedence over scaled dimensions. Contractors shall verify and be responsible for all dimensions and conditions shown on the drawing.

**client:**  
**WESTCREEK DEVELOPMENTS**

**sub-consultant:**  
**Stantec**, **L.A. West**, **Lifeways**, **EARTHMASTER**

**revisions:**

no:	date:	description:
1	13-11-2018	Submission
2	19-07-2019	DTR#1 Resubmission
3		
4		
5		
6		
7		
8		
9		

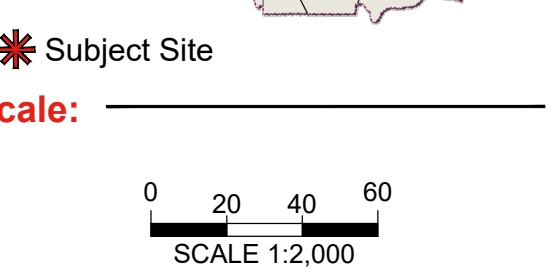
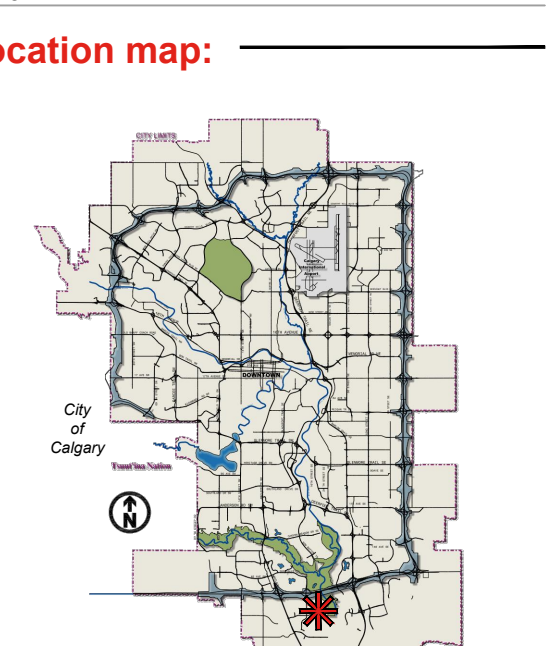

**municipal address:**  
 2100 194 Avenue SE

**legal description:**  
 Block 1; Lot 4; Plan 1112999

**file description:**  
 pre-app: --  
 LOC: LOC2018-0256  
 bylaw no.: --

**file info:**  
 project no.: C2172  
 drawn by: EB  
 start date: Sep 14, 2018  
 current date: Jul 18, 2019

**CHAPARRAL MEADOWS**

**sheet title:**  
**Outline Plan & Land Use Redesignation)**

**exhibit no.:**  
**1.0**

**legend:**

- Outline Plan Boundary
- Contour Interval 0.5m
- 1.5m Mono Sidewalk
- 2.0m Mono Sidewalk
- 2.0m Separate Sidewalk
- 3.0m Regional Pathway
- 3.0m Multi Use Pathway
- 3.0/4.0m Stormpond Maintenance Road
- Bus Pad Location

**Deep Services - Proposed**

- Sanitary Sewer/Manhole
- Storm Sewer/Manhole
- Water Main/Hydrant

**Notes:**  
 Residential roads are: lanless (8.5m/16.0m), laned (9.0m/16.0m) unless otherwise noted.  
 All lanes are 7.0m wide unless otherwise noted.