

Amendment No. 81/209
Bylaw No. 23Z82
Council Approval: 16 February 1982

SCHEDULE B

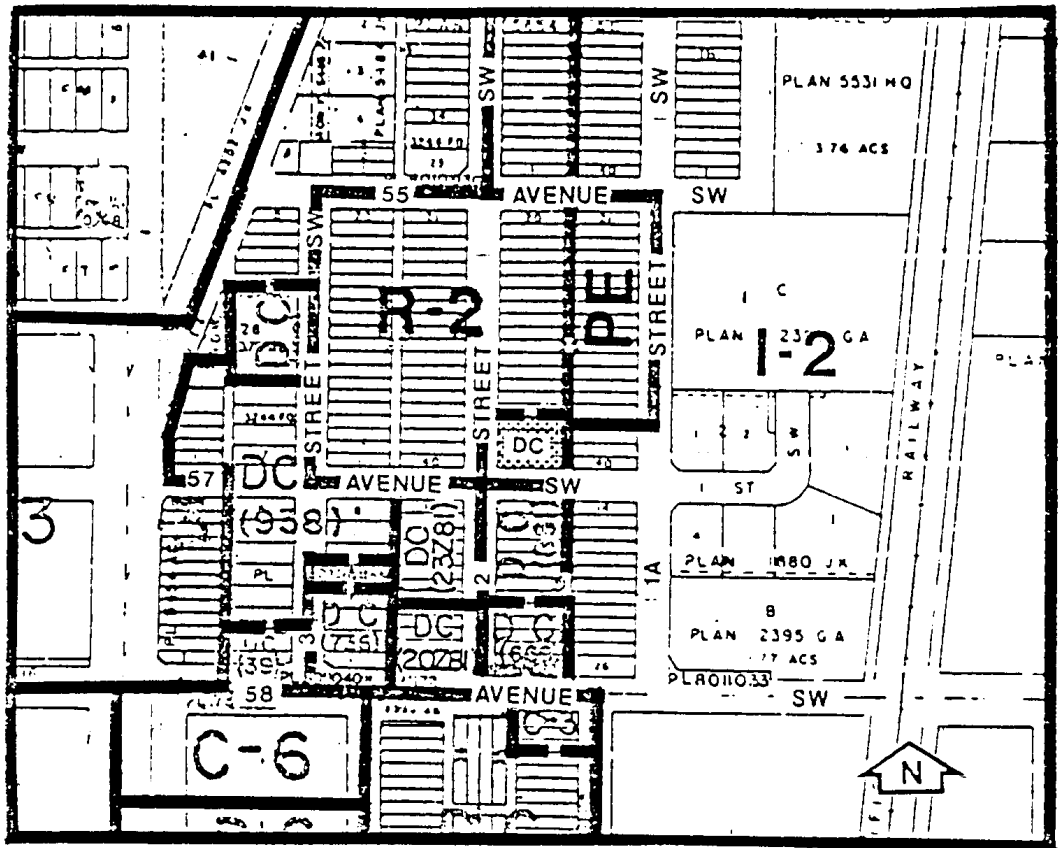

1. Land Use

The land uses shall be those contained in the C-2 (General Commercial District), Section 36 of By-law 2P80.

2. Development Guidelines

The General Rules for Commercial Districts contained in Section 33 of By-law 2P80 and the Permitted and Discretionary Use Rules of the C-2 (General Commercial District) shall apply unless otherwise noted below.

A. Density

- a) A maximum F.A.R. of 1.5:1 shall be allowed for a commercial only development.
- b) A maximum F.A.R. of 3.0:1, of which no more than 1.5:1 may be commercial, shall be allowed for a mixed residential/commercial development.

B. Development Plans

Approval of this application does not constitute approval of a development permit. Comprehensive plans, including building design, site layout, exterior finishes and colour, landscaping, parking and accesses shall subsequently be submitted to the Approving Authorities as part of a development permit application.