

**Amendment No. 82/151
Bylaw No. 16Z83
Council Approval: 14 February 1983**

SCHEDULE B

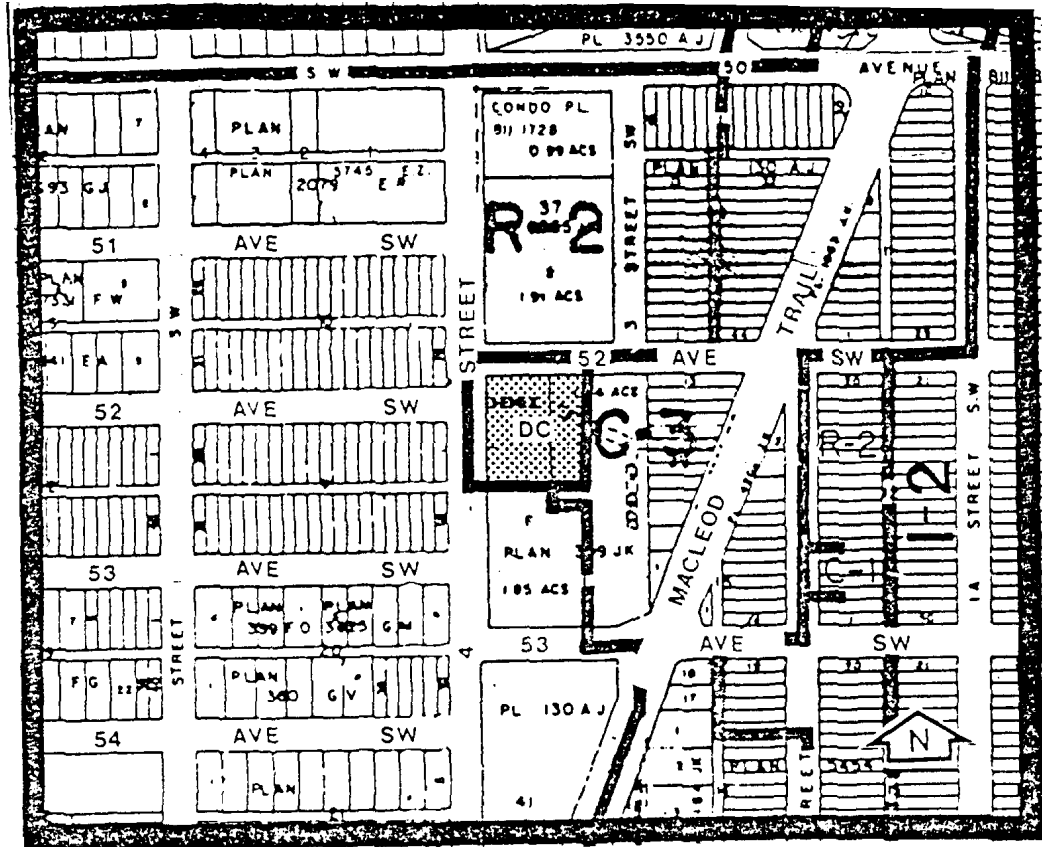

1. Land Use

The land use shall be for a 53 unit senior citizen housing development only.

2. Development Guidelines

The General Rules for Residential Districts contained in Section 20 of By-law 2P80 and the Permitted and Discretionary Use Rules of the RM-4 (Residential Medium Density Multi-Dwelling Districts) shall apply unless otherwise noted below.

a) Development Plans

Approval of this application does not constitute approval of a development permit. Comprehensive plans, including building design, site layout, exterior finishes and colour, landscaping, parking and accesses shall subsequently be submitted to the Approving Authorities as part of a development permit application.