

**Amendment No. 82/203
Bylaw No. 20Z83
Council Approval: 14 February 1983**

SCHEDULE B

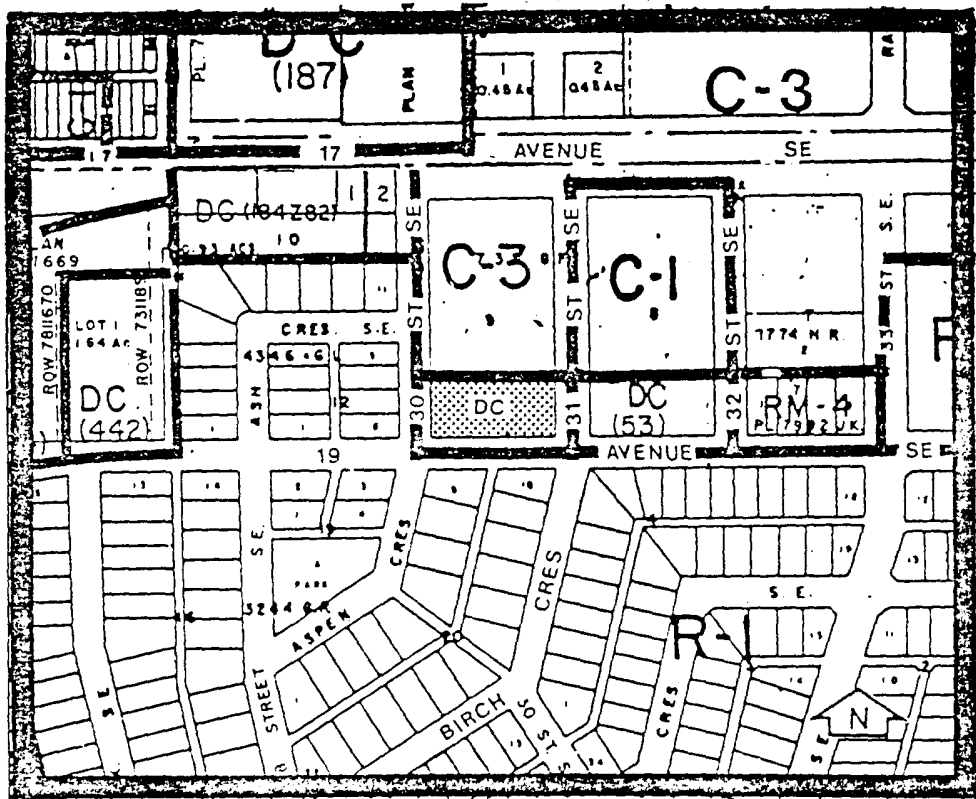

1. Land Use

The land use shall be those permitted and discretionary uses contained in the C-3 General Commercial District of By-law 2P80.

2. Development Guidelines

The General Rules for Commercial Districts contained in Section 33 of By-Law 2P80 and the Permitted and Discretionary Use Rules of Section 37 of By-law 2P80 shall apply unless otherwise noted below.

a) Height

Maximum building height shall be 10 metres.