

**Amendment No. 85/055**  
**Bylaw No. 61Z85**  
**Council Approval: 09 September 1985**

**SCHEDULE B**

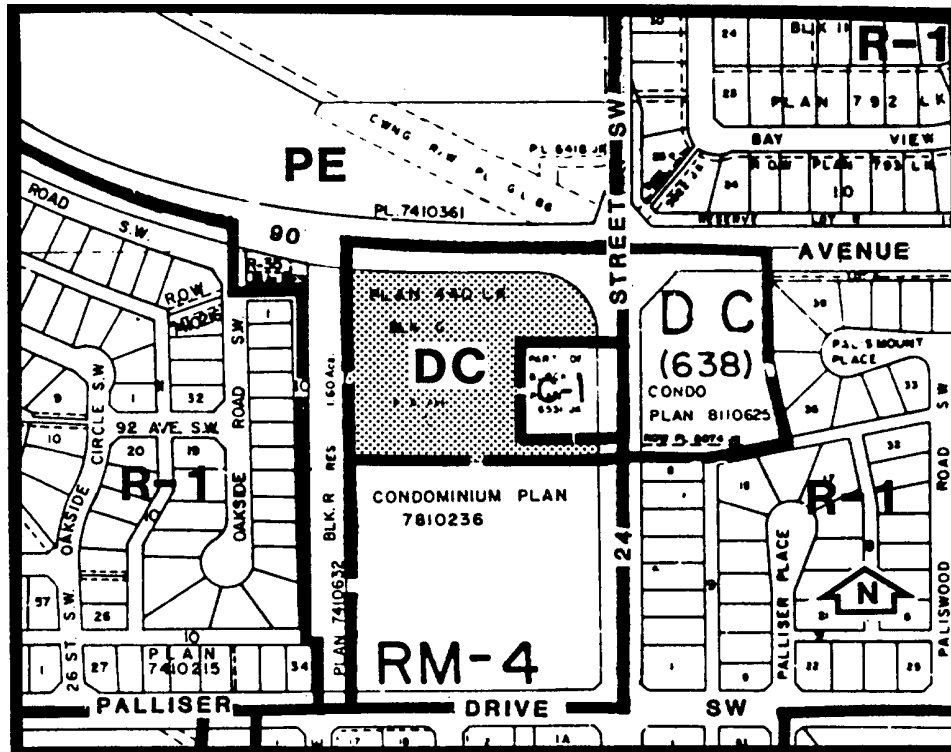

1. Land Use

The Permitted Uses of the C-1A District with the addition of a drinking establishment which is ancillary to a restaurant shall be permitted uses; and the Discretionary Uses of the C-1A District shall be discretionary uses.
2. Development Guidelines

The General Rules for Commercial Districts contained in Section 33 of By-law 2P80 and the Permitted and Discretionary Use Rules of the C-1A (Local Commercial District) shall apply unless otherwise noted below.

  - a) Drinking Establishment Seating

The seating capacity of a drinking establishment in the form of a lounge which is ancillary to a restaurant shall not exceed the seating capacity of the restaurant portion.
  - b) Development Plans

Approval of this application does not constitute approval of a development permit. Comprehensive plans, including building design, site layout, exterior finishes and colour, landscaping, parking and accesses shall subsequently be submitted to the Approving Authorities as part of a development permit application.