

**Amendment No. 86/001
Bylaw No. 38Z86
Council Approval: 10 March 1986**

SCHEDULE B

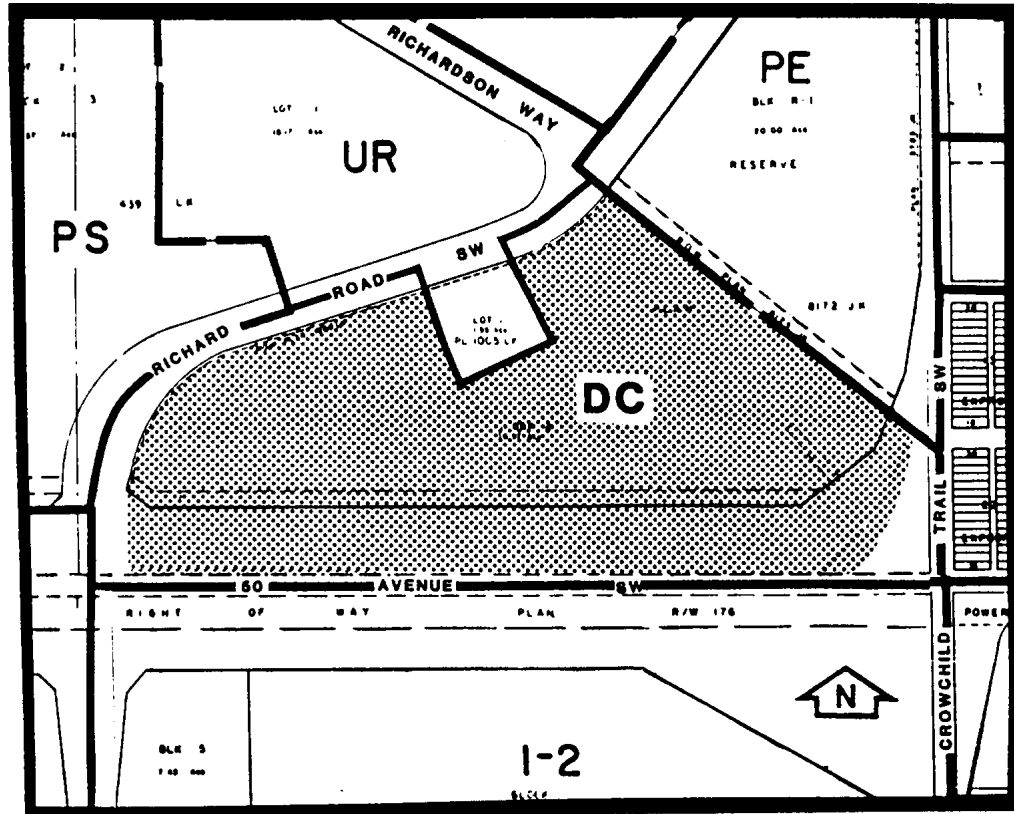

1. Land Use
The land use shall be temporary removal housing for the 1988 Olympic Winter Games only.
2. Development Guidelines
 - a) Density
Maximum density shall be in the order of 811 units and 3250 beds.
 - b) Height
Maximum building height shall be 3 storeys not exceeding 15 metres at any eaveline (not including mechanical penthouse).

- c) **Parking**
Parking arrangements shall be determined at the time of application for a development permit to the satisfaction of the Approving Authority.

- d)
 - i) **Access**

Access and egress shall be determined at the time of application for a development permit to the satisfaction of the Approving Authority.

 - ii) **Access**

No direct vehicular access or egress shall be permitted from or to Crowchild Trail and 50 Avenue S.W. Access from 50 Avenue S.W. from the ATCO site to this site shall be permitted for delivery of units only.

- e) **Restoration**

Details for the progressive restoration of the site following the removal of the structures shall be submitted at the time of application for a development permit to the satisfaction of the Approving Authority.

- f) **Landscaping**

Details of the landscaping treatment and the internal pathway system shall be submitted at the time of application for a Development Permit to the satisfaction of the Approving Authority.