

**Amendment No. 87/045  
Bylaw No. 66Z87  
Council Approval: 15 June 1987**

**SCHEDULE B**

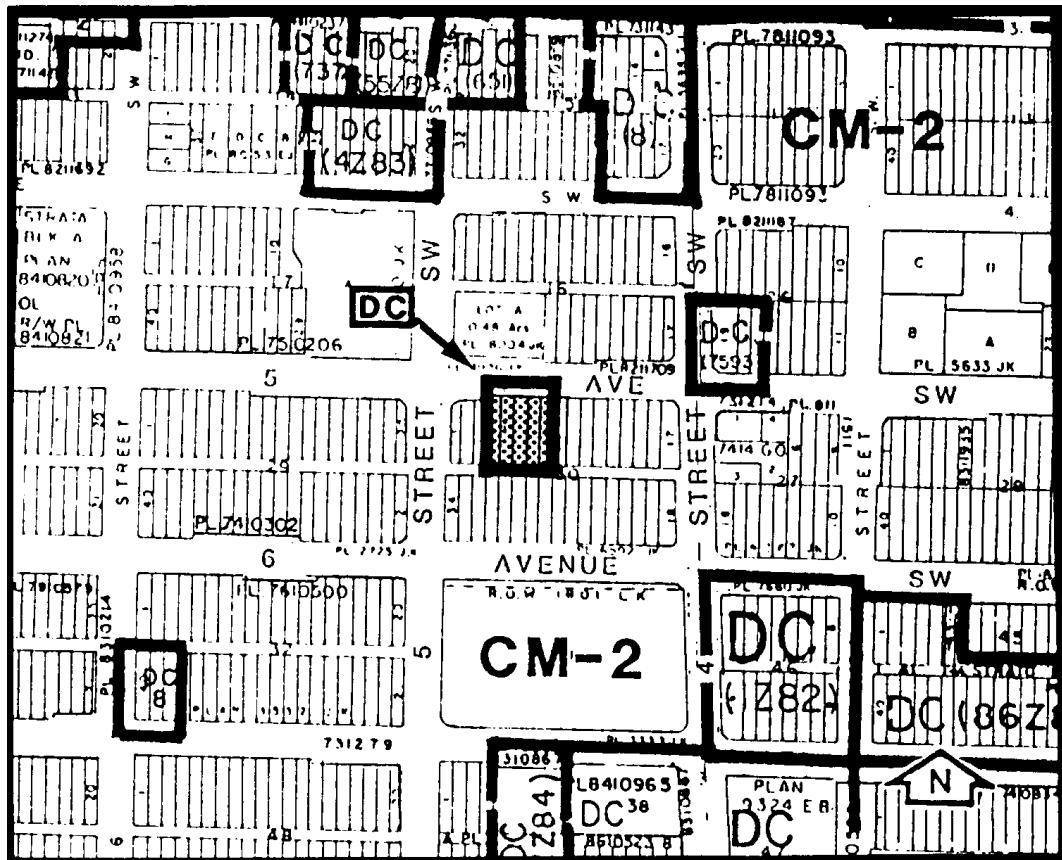

1. LAND USE GUIDELINES

To accommodate a 24-storey office building. Surface parking and signs may also be temporary discretionary uses.
2. DEVELOPMENT GUIDELINES
  - a) The development will be built to form part of the integrated elevated pedestrian walkways and public open spaces set out in the proposed development guidelines for the downtown area.

b) Temporary Surface Parking Areas

As an interim use, the temporary surface parking area shall be designed and developed in conformity with the relevant Council policies and standards to the satisfaction of the Approving Authority.

c) Signage

Any signage on the subject site shall conform with the Sign Appendix (Section 59 of By-law 2P80), with the Approving Authority considering the appropriateness of the signage relative to existing and future uses in this area.