

Amendment No. 88/100
Bylaw No. 1Z89
Council Approval: 16 January 1989

SCHEDULE B

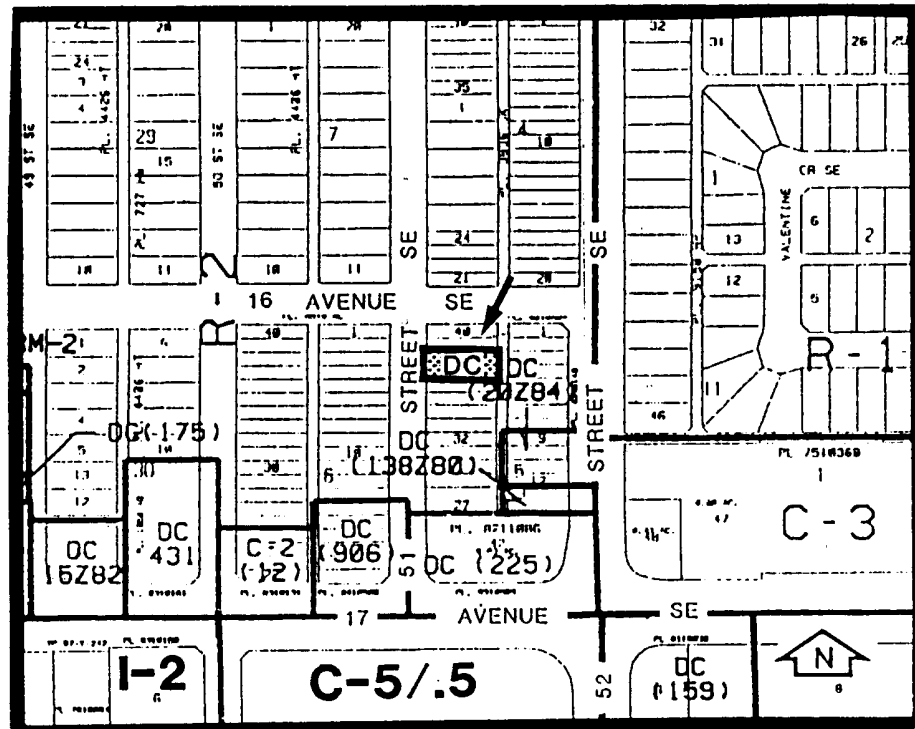

1. Land Use

The permitted and discretionary uses of the R-2 Residential Low Density District shall be permitted and discretionary uses respectively with the additional discretionary use of a fourplex dwelling.

2. Development Guidelines

The General Rules for residential districts contained in Section 20 of By-law 2P80 and the Permitted and Discretionary Use Rules of the R-2 District shall apply unless otherwise noted below.

a) Development Plans

Approval of this application does not constitute approval of a development permit. Comprehensive plans, including building design, site layout, exterior finishes and colour, landscaping, parking and accesses shall subsequently be submitted to the Approving Authorities as part of a development permit application.