

Amendment No. 89/015
Bylaw No. 51Z89
Council Approval: 19 June 1989

SCHEDULE B

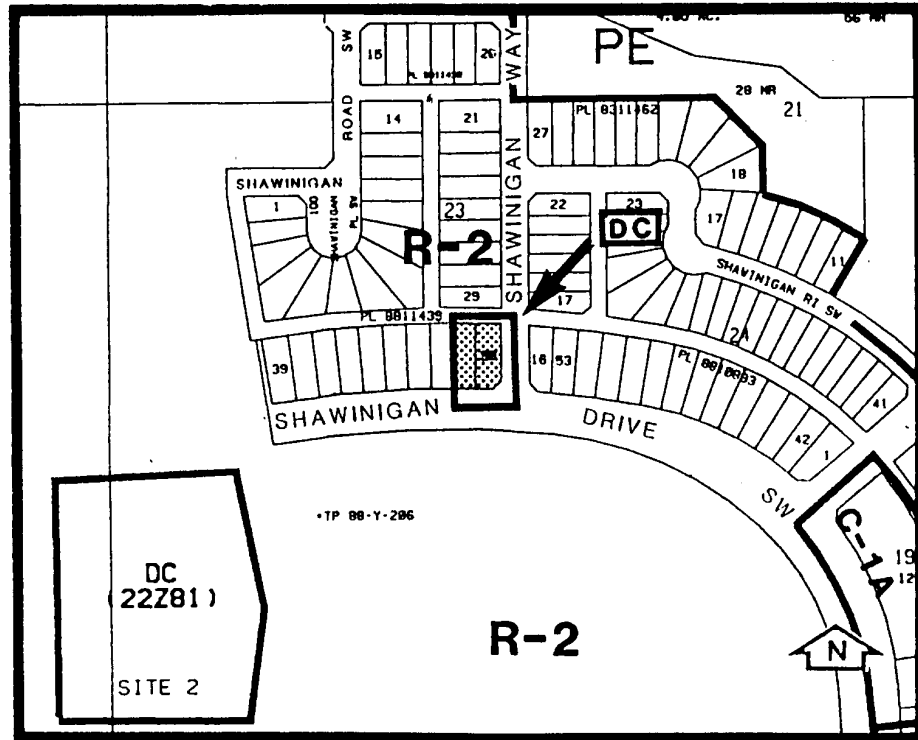

1. Land Use

The land use shall be for a child care facility.

2. Development Guidelines

The General Rules for Residential Districts contained in Section 20 of By-law 2P80 and the Permitted and Discretionary Use Rules of the R-2 District shall apply unless otherwise noted below:

a) Density

The number of children which may be approved for the facility shall be determined by the Approving Authority and is dependent upon net floor area, outdoor play space, staff parking requirements and drop-off area in accordance with the following development guidelines for up to a maximum of 80 children.

b) Staff Parking

Staff parking shall be provided at a ratio of 1 parking space per 2 employees to be located on-site to the satisfaction of the Approving Authority.

c) Fencing, Landscaping and Signage, Garbage Storage

Fencing, landscaping, signage and garbage storage shall be to the satisfaction of the Approving Authority.

d) Outdoor Play Space

Outdoor play space shall be provided in the rear yard at a minimum of 2.25 m² per child.

e) Drop-Off Area

This area shall be curbside in front of the property, on-site or a combination of the two, to the satisfaction of the Approving Authority. Drop-off area with lane access shall not be allowed.

f) Development Plans

Approval of this application does not constitute approval of a development permit. Comprehensive plans, including building design, site layout, exterior finishes and colour, landscaping, parking and access shall subsequently be submitted to the Approving Authority as part of a development permit application.