

**Amendment No. 89/017**  
**Bylaw No. 58Z89**  
**Council Approval: 19 June 1989**

**SCHEDULE B**

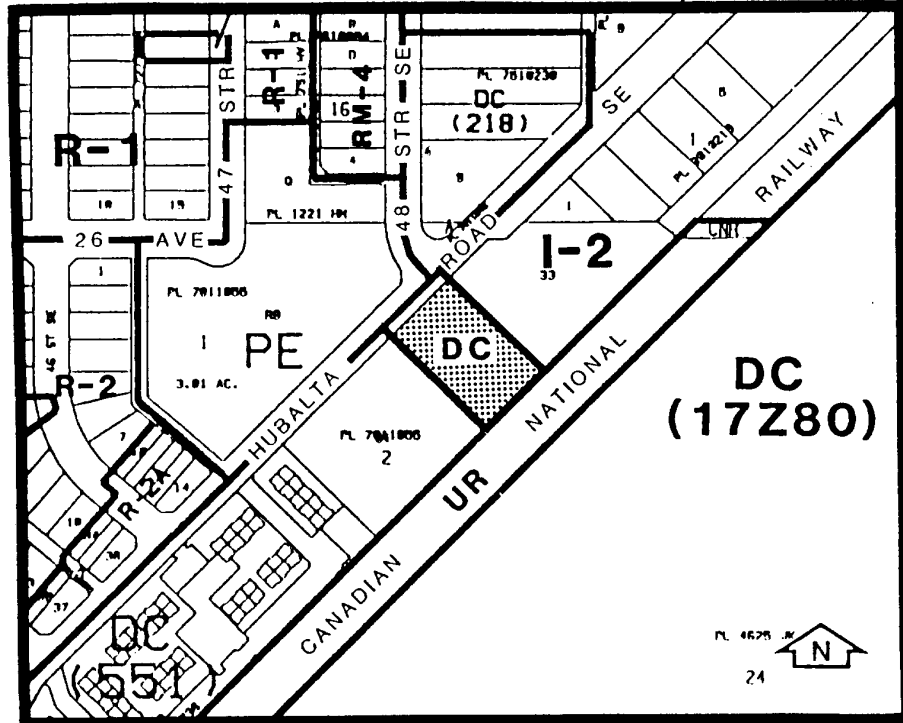

1. Land Use

The permitted and discretionary uses of the I-2 General Light Industrial District shall be permitted and discretionary uses respectively with the additional discretionary use of a church and associated uses.

2. Development Guidelines

The General Rules for Industrial Districts contained in Section 43 of By-law 2P80 and the permitted and Discretionary Use Rules of the I-2 General Light Industrial District shall apply unless otherwise noted below:

a) Development Plans

Approval of this application does not constitute approval of a development permit. Comprehensive plans, including building design, site layout, exterior finishes, color, landscaping, parking and access shall subsequently be submitted to the Approving Authorities as part of a development permit application.