

**Amendment No. 89/053**  
**Bylaw No. 95Z89**  
**Council Approval: 11 September 1989**

**SCHEDULE B**

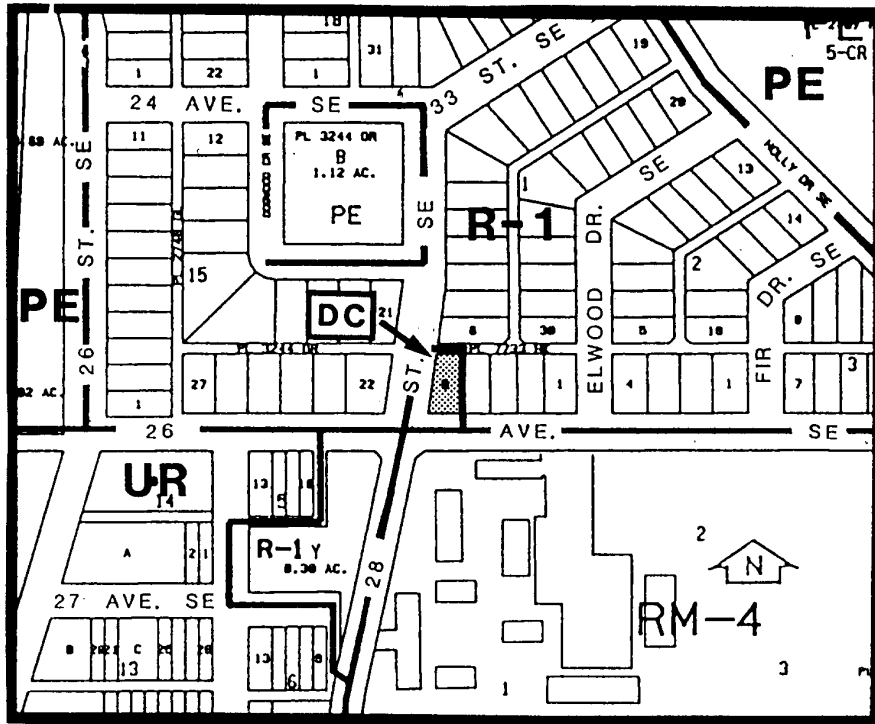

1. Land Use

The land use shall be for the semi-detached structure existing on-site on the date of approval of this by-law.

2. Development Guidelines

The General Rules for Residential Districts contained in Section 20 of By-law 2P80 and the Permitted and Discretionary Use Rules of the R-2 District shall apply unless otherwise noted below:

a) Yard Setbacks

The following yard measurement shall apply:

north	5.75 metres
east	1.39 metres
south	3.8 metres
west	4.55 metres to 7.69 metres.

b) Lot Depth

The minimum lot depth shall be 14.9 metres.

c) Development Plans

Approval of this application does not constitute approval of a development permit. Comprehensive plans, including building design, site layout, exterior finishes, color, landscaping, parking and accesses shall subsequently be submitted to the Approving Authority as part of a development permit application.