

Amendment No. 91/038
Bylaw No. 67Z91
Council Approval: 27 January 1992

SCHEDULE B

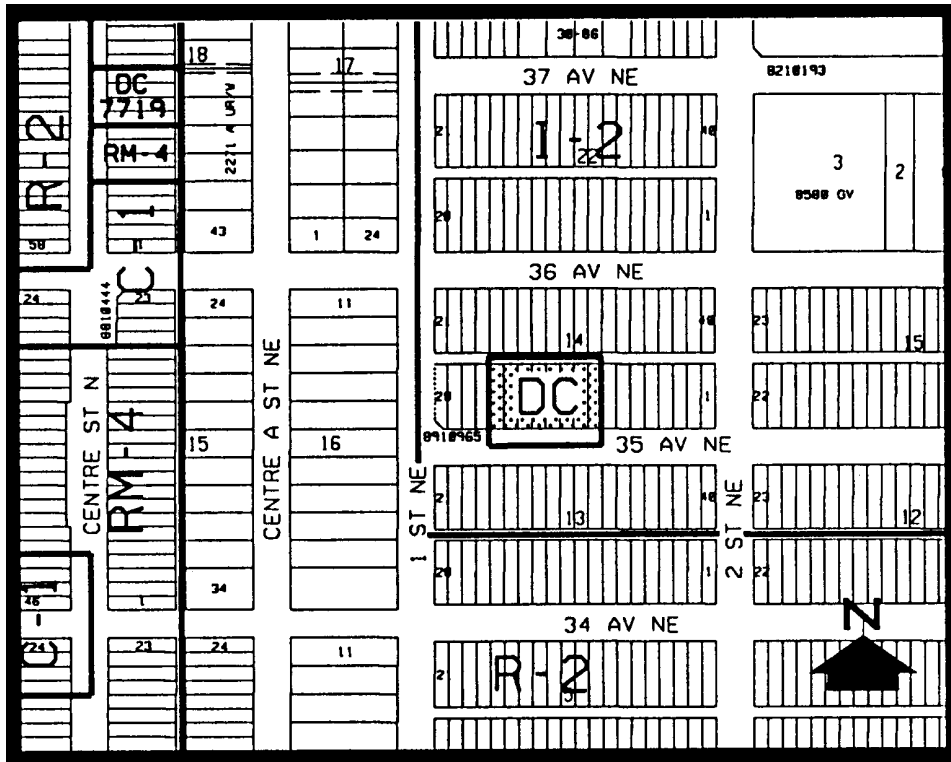

1. Land Use

The Permitted and Discretionary Uses of the I-2 General Light Industrial District of By-law 2P80 shall be the permitted and discretionary uses respectively with the additional Discretionary Use of one dwelling unit accessory to a food warehouse facility only.

2. Development Guidelines

The General Rules for Industrial Districts contained in Section 43 of By-law 2P80 and the Permitted and Discretionary Use Rules of the I-2 General Light Industrial District shall apply unless otherwise noted below.

a) Development Plans

Approval of this application does not constitute approval of a development permit. Comprehensive plans shall be submitted to the Approving Authority as part of a development permit application. In considering such an application, the Approving Authority shall ensure the building design and site layout are consistent with the plans and renderings submitted to City Council during their consideration of this By-law.