

Amendment No. 91/040
Bylaw No. 78Z91
Council Approval: 04 November 1991

SCHEDULE B

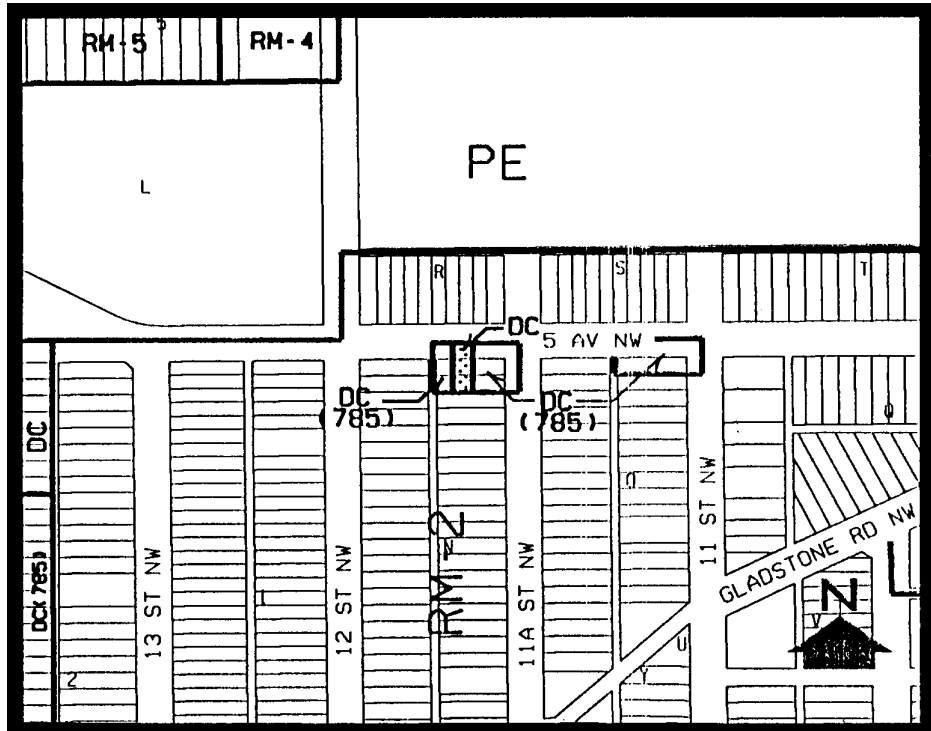

1. Land Use

The land use shall be for an art gallery which, for the purpose of this by-law, means a store for the display and sale of artwork to be located in the building existing on site on the date of approval of this by-law. Other retail uses shall not be allowed.

2. Development Guidelines

The General Rules for Commercial Districts contained in Section 33 of By-law 2P80 and the Permitted and Discretionary Use Rules of the C-1 Local Commercial District shall apply unless otherwise noted below.

a) Gross Floor Area

The maximum gross floor area shall be 68 square metres.

b) Parking

A minimum of 2 on-site tandem parking stalls shall be provided.

c) Development Plans

Approval of this application does not constitute approval of a development permit. Comprehensive plans shall be submitted to the Approving Authority as part of a development permit application. In considering such an application, the Approving Authority shall ensure the site development is consistent with the plans submitted to City Council during their consideration of this By-law.

d) Signage

Signage shall be limited in size, design and location and must be compatible with the residential neighbourhood to the satisfaction of the Approving Authority.