

**Amendment No. 91/096**  
**Bylaw No. 58Z92**  
**Council Approval: 15 June 1992**

**SCHEDULE B**

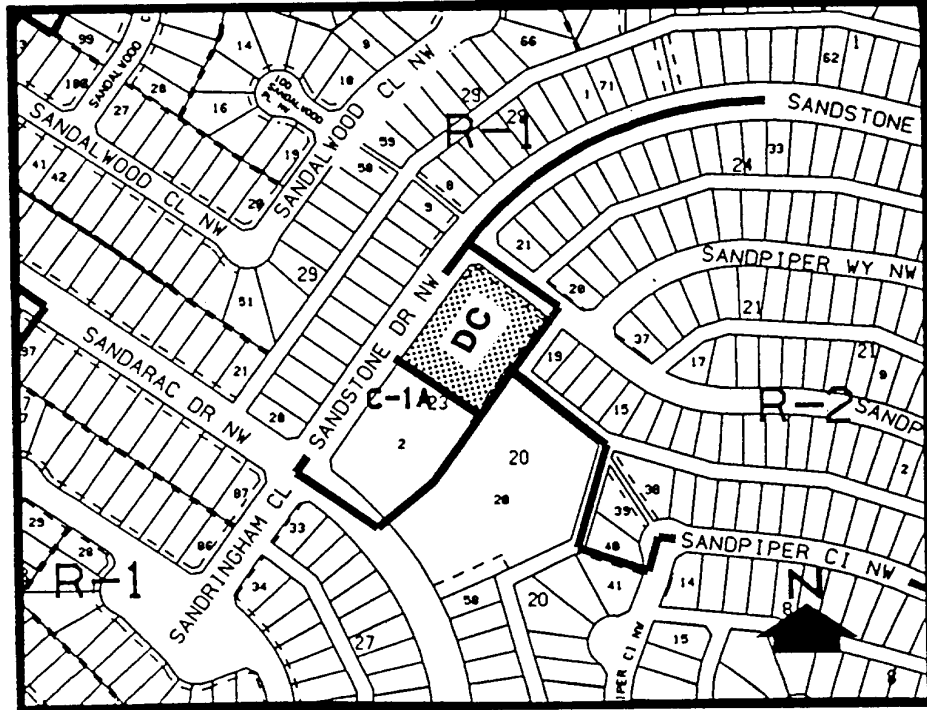

1. Land Use

The Permitted and Discretionary Uses of the RM-1 Residential Low Density Multi-Dwelling District of By-law 2P80 shall be the permitted and discretionary uses respectively.

2. Development Guidelines

The General Rules for Residential Districts contained in Section 20 of By-law 2P80 and the Permitted and Discretionary Use Rules of the RM-1 Residential Low Density Multi-Dwelling District shall apply unless otherwise noted below.

a. Dwelling Units

The maximum number of dwelling units shall be 16.

b. Vehicular Access and Egress

No direct vehicular access or egress shall be permitted from or to the lane other than for garbage collection.

c. Building Height

The maximum building height shall be 2 storeys not exceeding 5 metres at the eaveline.

d. Garbage Storage

The garbage enclosures shall be integrated within the site and visually screened from all adjacent sites and public thoroughfares.

e. Development Plans

Approval of this application does not constitute approval of a development permit. Comprehensive plans shall be submitted to the Approving Authority as part of a development permit application. In considering such an application, the Approving Authority shall ensure the building design and site layout are consistent with the plans and renderings submitted to City Council during their consideration of this By-law.