

Amendment No. 92/059
Bylaw No. 90Z92
Council Approval: 05 October 1992

SCHEDULE B

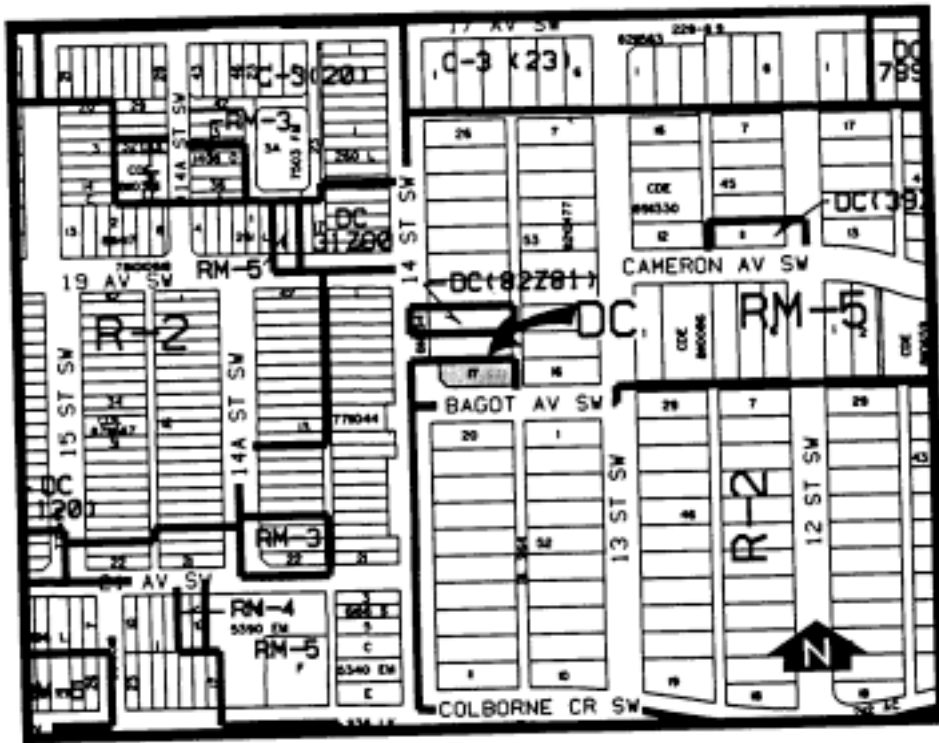

1. Land Use

The land use shall be for a business management office and a residence located in the building existing on site on the date of approval of this by-law only.

2. Development Guidelines

The General rules for Commercial Districts contained in Section 33 of By-law 2P80 and the Permitted and Discretionary Use Rules of the C-1 District shall apply unless otherwise noted below.

a. Parking

Parking shall be provided on site to the satisfaction of the Approving Authority.

b. Development Plans

Approval of this application does not constitute approval of a development permit. Comprehensive plans shall be submitted to the Approving Authority as part of a development permit application.