

Amendment No. 93/009
Bylaw No. 35Z93
Council Approval: 03 May 1993

SCHEDULE B

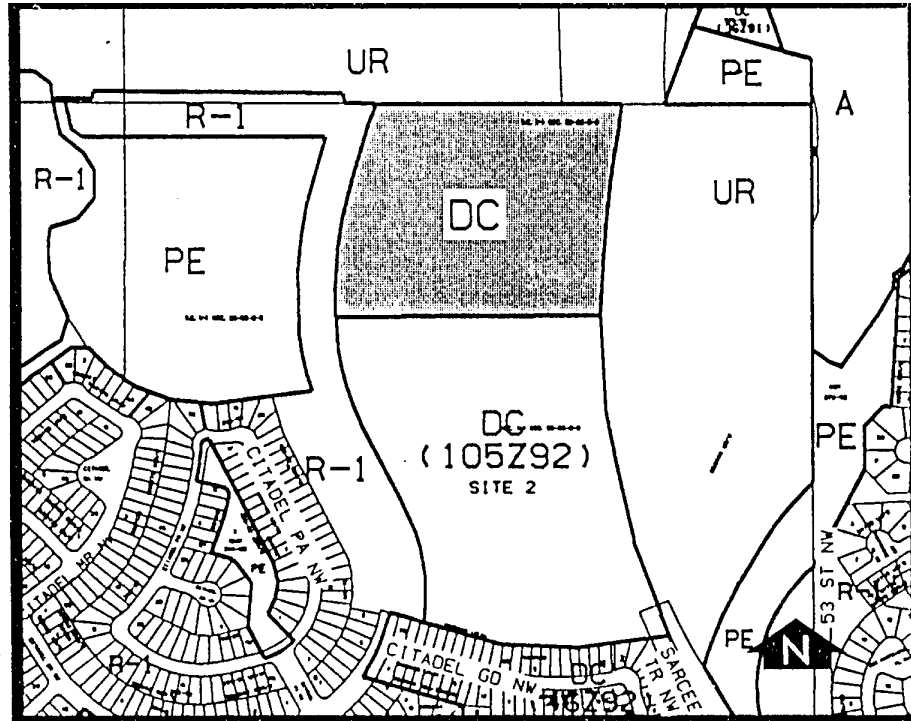

1. Land Use

The Permitted and Discretionary Uses of the R-1 Residential Single Detached District of By-law 2P80 shall be the Permitted and Discretionary Uses respectively.

2. Development Guidelines

The general rules for Residential Districts contained in Section 20 of By-law 2P80 and the Permitted and Discretionary Use Rules of the R-1 Residential Single Detached District shall apply unless otherwise noted below:

a. Lot Width

The minimum lot width shall be 8 metres and the average lot width shall not be less than 9 metres.

b. Lot Depth

The minimum lot depth shall be 33.5 metres.

c. Lot Area

The minimum lot area shall be 270 square metres.

d. Development Permit Requirements

Development permit requirements for the Permitted and Discretionary Uses of this district shall be subject to Section 8 of By-law 2P80.