

Amendment No. 92/085
Bylaw No. 68Z93
Council Approval: 19 July 1993

SCHEDULE B

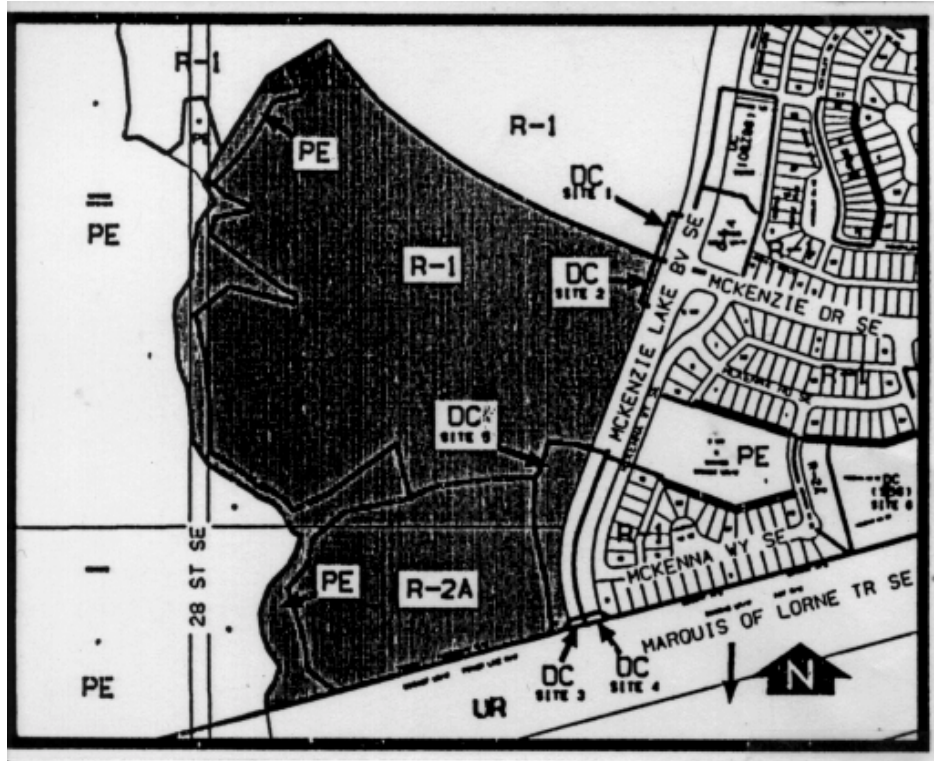

Sites 1, 2, 3 and 4 0.08 ha± (0.2 ac±)

1. Land Use

The land use shall be for privately-owned and maintained ornamental entrance parks and associated community identification signage only.

2. Development Guidelines

- a. The ornamental entrance parks and associated community identification signage shall be developed to the satisfaction of the Approving Authority in consultation with the Director of Parks & Recreation.
- b. Approval of this application does not constitute approval of a Development Permit. Comprehensive plans, including site layout, landscaping and signage shall subsequently be submitted to the Approving Authority as part of a Development Permit application.

Site 5 0.77 ha± (1.9 ac±)

1. Land Use

The land use shall be for a privately-owned road, ornamental entrance park and associated signage only.

2. Development Guidelines

- a. The site shall be developed on a comprehensively designed basis in a manner compatible with the surrounding residential area to the satisfaction of the Approving Authority.
- b. Approval of this application does not constitute approval of a Development Permit. Comprehensive plans, including site layout, landscaping, access and signage shall subsequently be submitted to the Approving Authority as part of a Development Permit application.