

Amendment No. 93/046
Bylaw No. 85Z93
Council Approval: 27 September 1993

SCHEDULE B

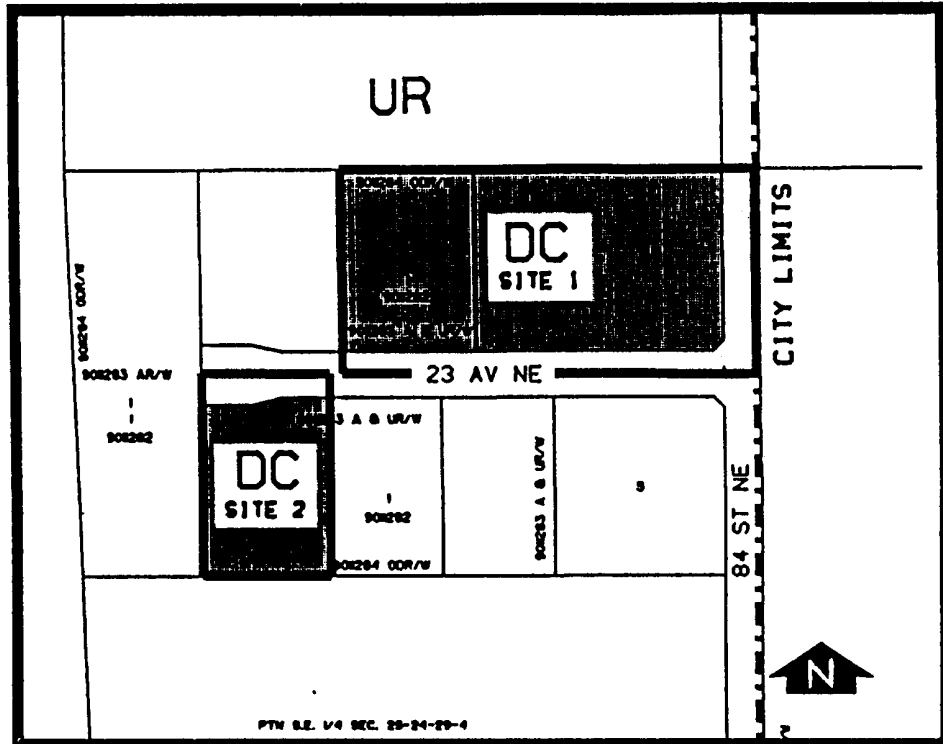

1. Land Use

The Permitted uses of the I-4 Limited-Serviced Industrial District shall be permitted, and the discretionary uses shall be as follows:

- Business offices accessory to any use (C.U.)
- Farm implement dealerships
- Light industrial uses related to agriculture
- Light industrial uses related to oil and gas production
- Outside storage (C.U.)

- Repair, service, storage, sales and rental of recreational vehicles, boats and associated recreational equipment.
- Retail sales as an accessory use to an approved use
- Signs (except for freestanding identification)

2. Development Guidelines

- a. The General Rules for Industrial Districts contained in Section 43 of By-law 2P80 and the Permitted and Discretionary Use Rules of the I-4 Limited-Serviced Industrial District shall apply unless otherwise noted below.

i. Lot Area

Site 1 - a minimum of 2.07 hectares.

Site 2 - a minimum of 0.7 hectares.

ii. Net Floor Area

Site 1 - the total net floor area for all buildings located on site 1 shall not exceed 13.5 percent of the site area (2790 square metres±) plus a maximum 1,000 square metres storage shed.

Site 2 - the total net floor area for all buildings located on site 2 shall not exceed 20 percent of the site area (1400 square metres±).

- b. Development Plans

Approval of this application does not constitute approval of a development permit. Comprehensive plans shall be submitted to the Approving Authority as part of a development permit application.

- c. Screening

Screening shall be provided around the perimeter of the outside storage area for materials and vehicles, excluding product display areas, to the satisfaction of the Approving Authority.