

Amendment No. 95/104
Bylaw No. 38Z96
Council Approval: 13 May 1996

SCHEDULE B

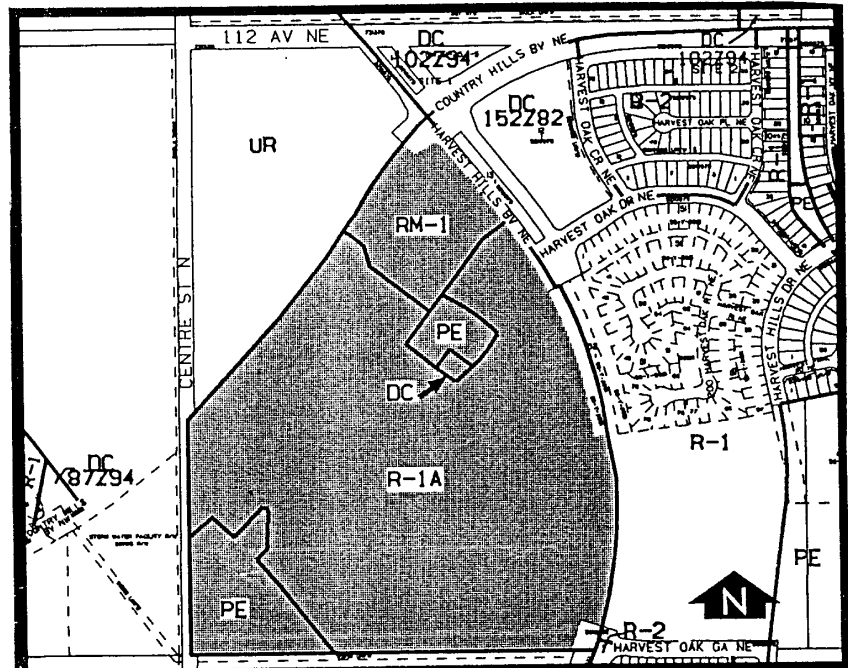

1. Land Use

The land use shall be for a child care facility only.

2. Development Guidelines

The General Rules for residential districts contained in Section 20 of Bylaw 2P80 and the permitted and discretionary use rules of the R-1A Narrow Lot Single-detached District shall apply unless otherwise noted below:

a. Development Plans

Approval of this application does not constitute an approval of a development permit. A development permit application shall be submitted to the Development Authority.