

Amendment No. 95/107
Bylaw No. 59Z96
Council Approval: 22 July 1996

SCHEDULE B

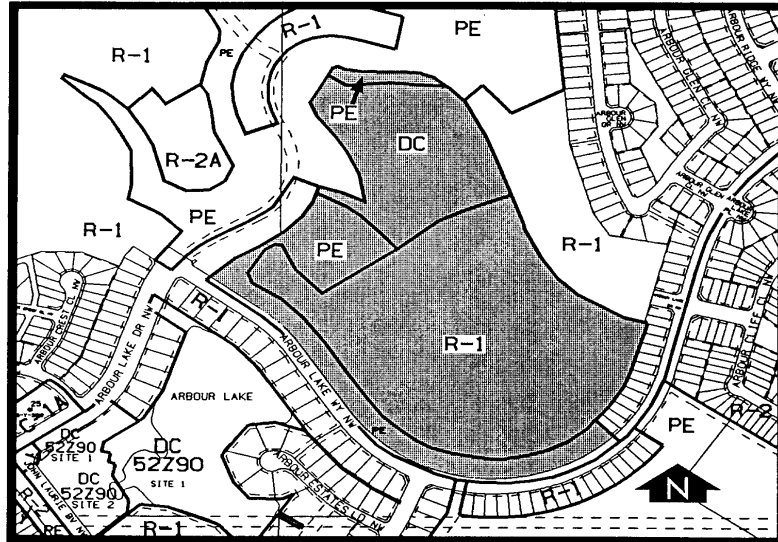

1) Land Use

The land use shall consist of single-detached and semi-detached units and accessory buildings only.

2) Development Guidelines

The General Rules for Residential Districts contained in Section 20 of Bylaw 2P80 and the Permitted and Discretionary Use Rules of the RM-1 District shall apply unless otherwise noted below:

a) Density

The maximum number of dwelling units shall be 89.

b) Building Height

Where the unit form is semi-detached the height of the unit shall be restricted to one storey.

c) Development Plans

Approval of this application does not constitute approval of a development permit. Comprehensive plans shall be submitted to the Approving Authority as part of a development permit application.