

**Amendment No. 97/039**  
**Bylaw No. 50Z97**  
Council Approval: 24 June 1997

**SCHEDULE B**

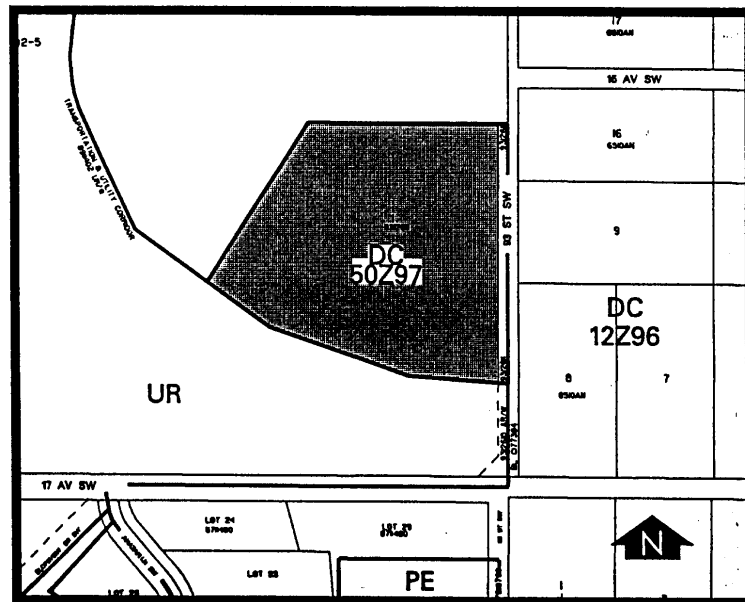

(1) LAND USE

The Permitted and Discretionary Uses of the PE Public Park, School and Recreation District shall be Permitted and Discretionary Uses respectively with Private Schools being a Permitted rather than a Discretionary Use.

(2) DEVELOPMENT GUIDELINES

The General Rules for Special Districts contained in Section 48 of Bylaw 2P80 and the Permitted and Discretionary Use Rules of the PE Public Park, School and Recreation District shall apply unless otherwise noted below:

(a) Building Height

A maximum of 10 metres.

(b) Development Plans

Approval of this application does not constitute approval of a development permit. Comprehensive plans shall subsequently be submitted to the Approving Authority as part of a development permit application.

