

Amendment No. 98/009
Bylaw No. 42Z98
Council Approval: 11 May 1998

SCHEDULE B

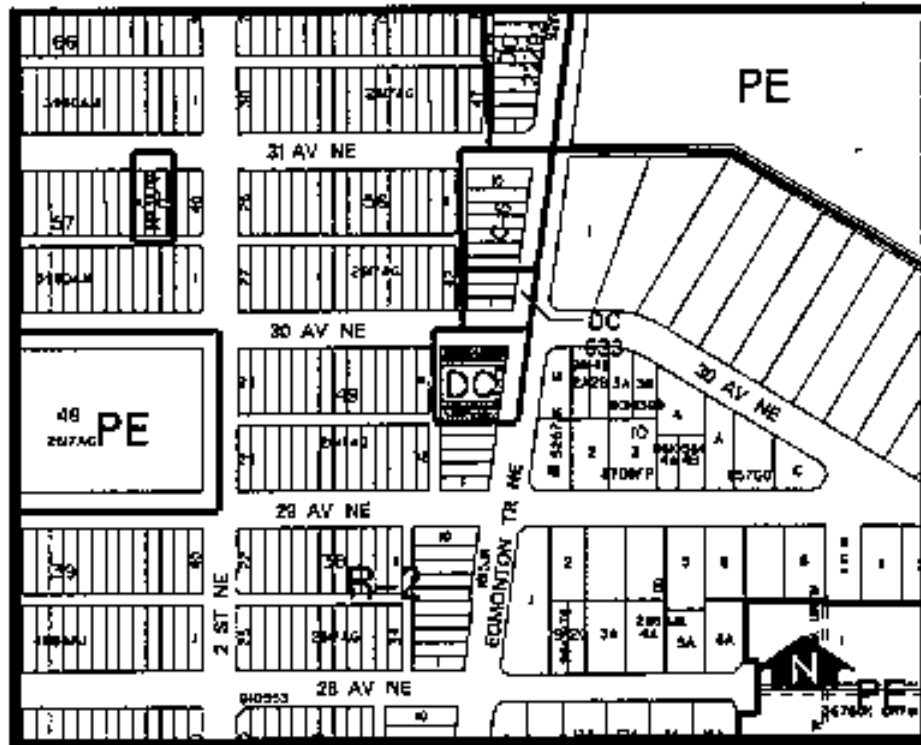

1. LAND USE

The land use shall be a two six-plex apartment comprehensive development.

2. DEVELOPMENT GUIDELINES

The General Rules for Residential Districts contained in Section 20 of Bylaw 2P80 and the Permitted and Discretionary Use Rules of the RM-4 Residential Multi-Dwelling District shall apply, unless otherwise noted below.

1. Dwelling Density

A maximum of 12 dwelling units.

a. Built Form

- The built form shall be two six-plex style apartments.
2. Development Plans

Approval of this application does not constitute approval of a development permit. Comprehensive plans shall be submitted to the Approving Authority as part of a development permit application.