

**Amendment No. 99/004**  
**Bylaw No. 28Z99**  
**Council Approval: 19 April 1999**

**SCHEDULE B**

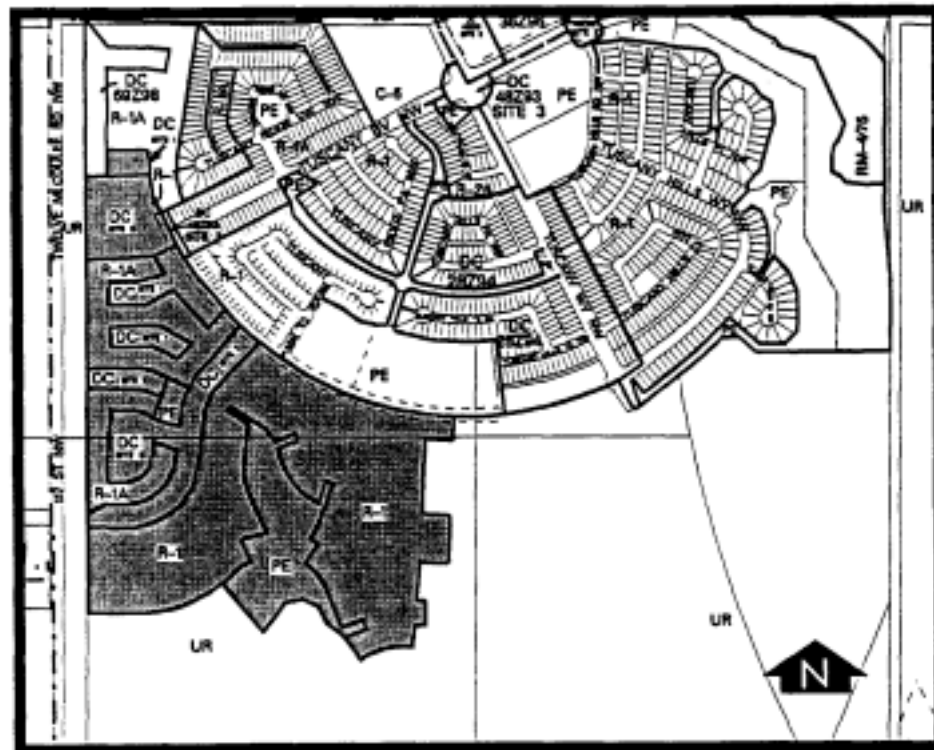

Site 1 - 7.09 ha± (17.5 ac±)

(1) Land Use

The Permitted and Discretionary Uses of the R-1A Residential Narrow Lot Single-Detached District shall be the Permitted and Discretionary Uses respectively.

(2) Development Guidelines

The General Rules for Residential Districts of Section 20 of Bylaw 2P80 and the Permitted and Discretionary Use Rules of the R-1A Residential Narrow Lot Single-Detached District shall apply unless otherwise noted below:

(a) Building Height

A maximum of 10 metres.

(b) Development Plans

Approval of this application does not constitute approval of a development permit. Comprehensive plans shall subsequently be submitted to the satisfaction of the Development Authority as part of a development permit application.

Site 2 - 2.13 ha± (5.26 ac±)

(1) Land Use

The Permitted and Discretionary Uses of the RM-4/75 Residential Medium Density Multi-Dwelling District shall be the Permitted and Discretionary Uses respectively.

(2) Development Guidelines

The General Rules for Residential Districts of Section 20 of Bylaw 2P80 and the Permitted and Discretionary Use Rules of the RM-4/75 Residential Medium Density Multi-Dwelling District shall apply unless otherwise noted below:

(a) Building Height

- (i) A maximum of three storeys not exceeding 10 metres at any eaveline.
- (ii) For the purpose of this district, height shall be measured from grade at all points adjacent to a building and from an approved landscaped deck where such deck is adjacent to the rear wall of a building.

(b) Development Plans

Approval of this application does not constitute approval of a development permit. Comprehensive plans shall subsequently be submitted to the satisfaction of the Development Authority as part of a development permit application.