

**Amendment No. 98/146**  
**Bylaw No. 30Z99**  
**Council Approval: 1999 March 15**

**SCHEDULE B**

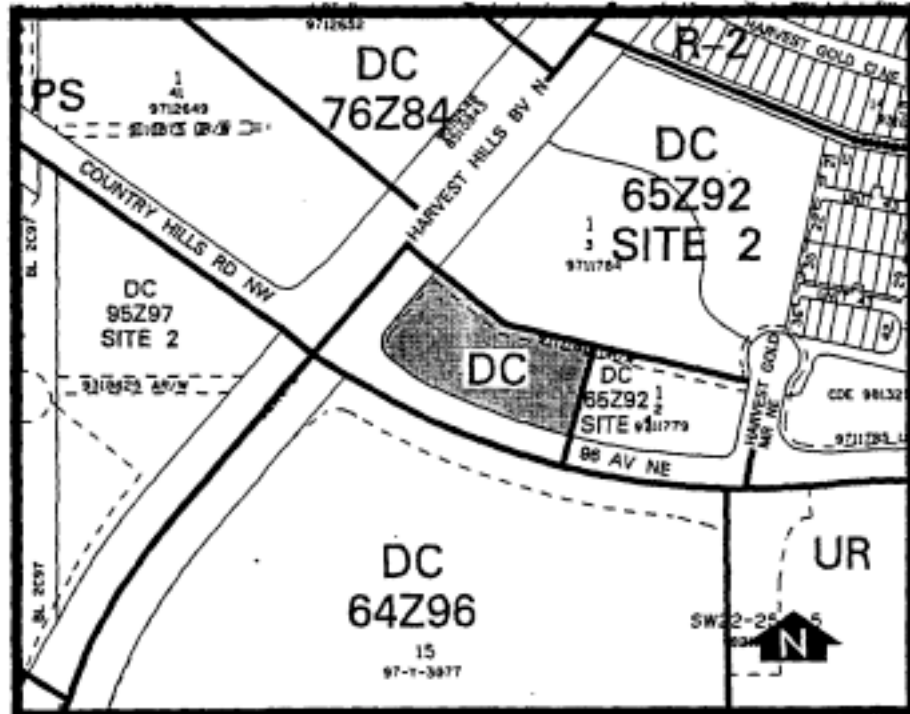

**1. Land Use**

The permitted uses of the C-1A Local Commercial District shall be the permitted uses. The discretionary uses shall be the discretionary uses of the C-1A District excluding restaurant/drinking establishments.

**2. Development Guidelines**

The General Rules for Commercial Districts contained in Section 33 of Bylaw 2P80 and the Permitted and Discretionary Use Rules of the C-1A Local Commercial District shall apply unless otherwise noted below:

**a. Development Plans**

Approval of this application does not constitute approval of a development permit; comprehensive plans, including building design, site layout, exterior finishes and

colour, landscaping, parking and access shall subsequently be submitted to the Development Authority as part of a development permit application.

b. Size of Grocery Store

Where a grocery store is provided as part of an automotive service use the gross floor area of the portion of the building used for the grocery store shall not exceed 350 square metres.