

**Amendment No. 98/147**  
**Bylaw No. 57Z99**  
**Council Approval: 22 June 1999**

**SCHEDULE B**

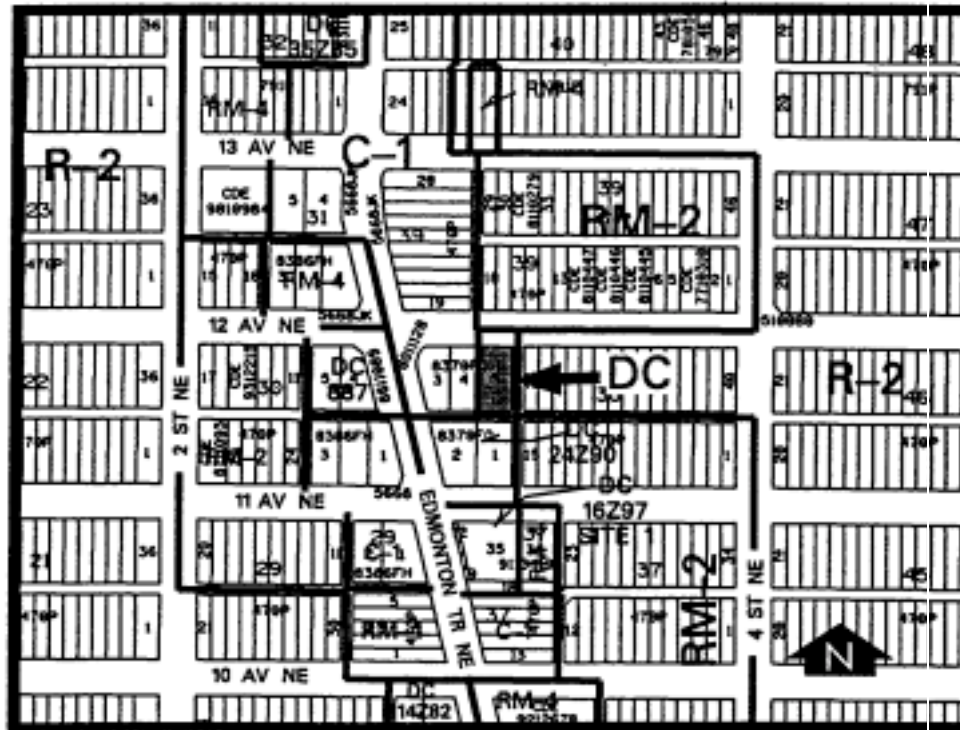

(1) Land Use

The Permitted and Discretionary Uses of the R-2 Residential Low Density District shall be the Permitted and Discretionary Uses respectively with the additional discretionary use of an office within the building existing on the site at the time of an approval of this Bylaw.

(2) Development Guidelines

The General Rules for Residential Districts contained in Section 20 of the Bylaw 2P80 and the Permitted and Discretionary Use Rules of the R-2 Residential Low Density District shall apply unless otherwise noted below:

(a) Parking

All required parking shall be provided onsite to the satisfaction of the Development Authority.

(b) Signage

Any commercial signage proposed for the site shall be compatible with the residential use of the building and will require a development permit application to the satisfaction of the Development Authority.

(c) Development Plans

Approval of this application does not constitute approval of a development permit. Comprehensive plans shall subsequently be submitted as part of a development permit application to the satisfaction of the Development Authority.