

Amendment No. 2000/006
Bylaw No. 114Z2000
Council Approval: 02 October 2000

SCHEDULE B

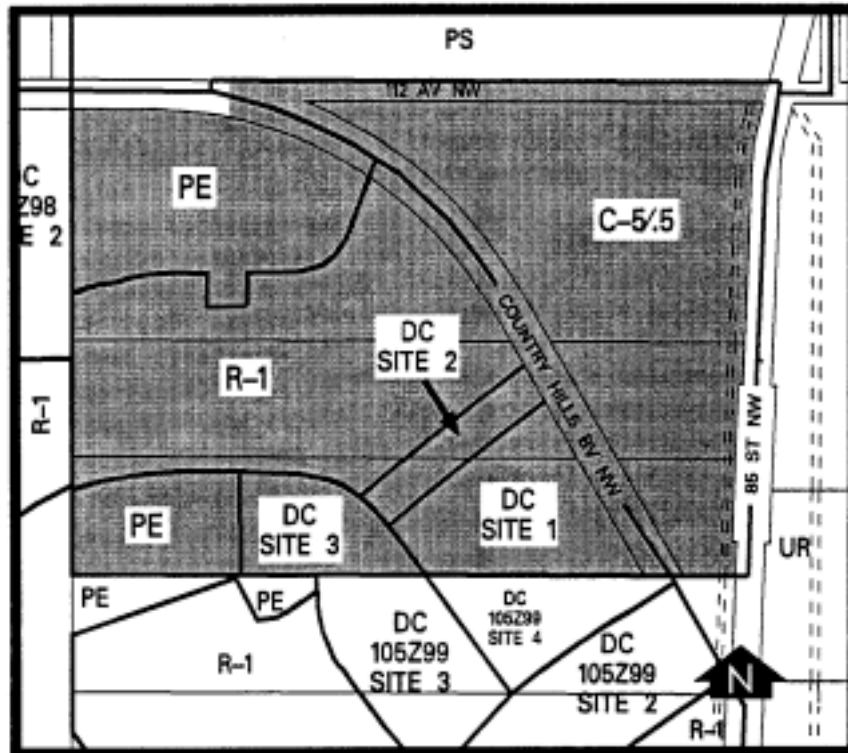

Site 1 2.6 ha± (6.5 ac±)

1. Land Use

The Permitted and Discretionary Uses of the RM-5 Residential Medium Density Multi-Dwelling District of Bylaw 2P80 shall be the Permitted and Discretionary Uses respectively.

2. Development Guidelines

The General Rules for Residential Districts contained in Section 20 of Bylaw 2P80 and the Permitted and Discretionary Use Rules of the RM-5 Residential Medium Density Multi-Dwelling District shall apply unless otherwise noted below.

- (a) Density
A maximum of 185 units per hectare (75 units per acre).
- (b) Development Plans

Approval of this application does not constitute approval of a development permit. Comprehensive plans shall subsequently be submitted to the Approving Authorities as part of a development permit application.

Site 2 0.9 ha± (2.3 ac±)

1. Land Use

The Permitted and Discretionary Uses of the R-2A Residential Low Density District of Bylaw 2P80 shall be the Permitted and Discretionary Uses respectively.

2. Development Guidelines

The General Rules for Residential Districts contained in Section 20 of Bylaw 2P80 and the Permitted and Discretionary Use Rules of the R-2A Residential Low District shall apply unless otherwise noted below:

(a) Density

A maximum of 26 units per hectare (10 units per acre).

(b) Development Plans

Approval of this application does not constitute approval of a development permit. Comprehensive plans shall subsequently be submitted to the Approving Authorities as part of a development permit application.

Site 3 1.3 ha± (3.3 ac±)

1. Land Use

The Permitted and Discretionary Uses of the RM-1 Residential Low Density Multi-Dwelling District of Bylaw 2P80 shall be the Permitted and Discretionary Uses respectively.

2. Development Guidelines

The General Rules for Residential Districts contained in Section 20 of Bylaw 2P80 and the Permitted and Discretionary Use Rules of the RM-1 Residential Low Density Multi-Dwelling District shall apply unless otherwise noted below:

(a) Density

A maximum of 35 units per hectare (14 units per acre).

(b) Development Plans

Approval of this application does not constitute approval of a development permit. Comprehensive plans shall subsequently be submitted to the Approving Authorities as part of a development permit application.