

Amendment # 2000/042
Bylaw # 68Z2000
Council Approval: 2000 June 28

SCHEDULE B

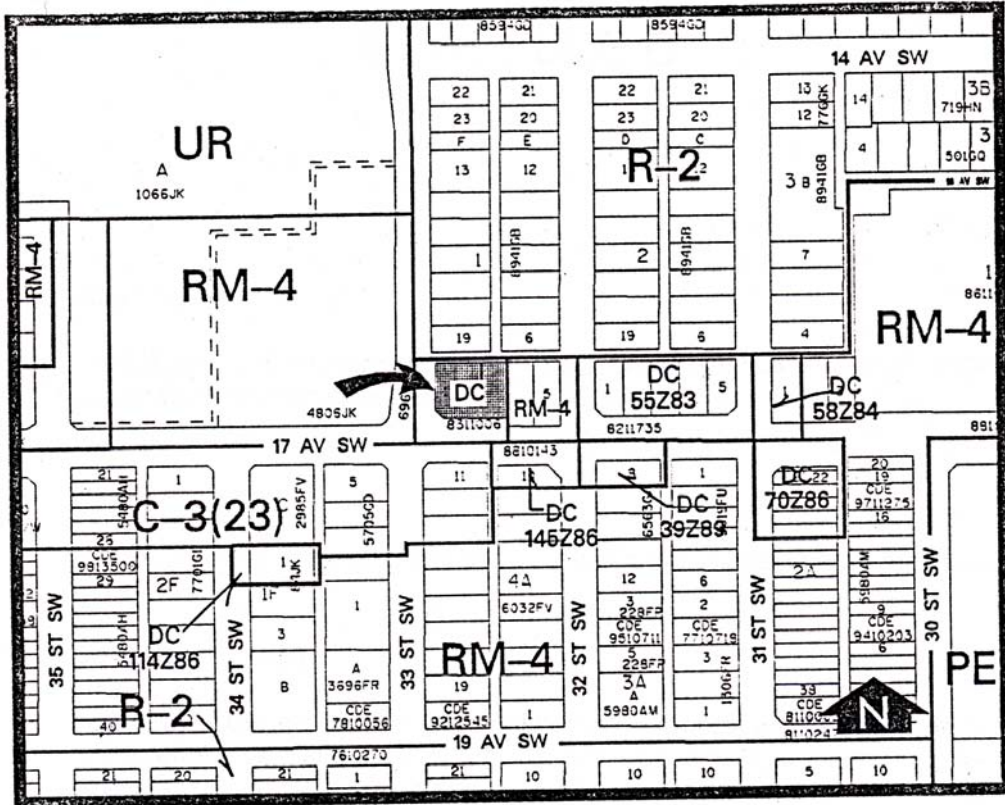

DC DIRECT CONTROL DISTRICT

1. The Permitted and Discretionary Uses of C-2 General Commercial District of Bylaw 2P80 shall be Discretionary Uses, excluding athletic and recreational facilities, autobody and paint shops, automotive sales and rentals, automotive services, automotive specialties, and hotels and motels.

Essential public services, parks and playgrounds and utilities shall be Permitted Uses.

2. Development Guidelines

The General Rules for Commercial Districts contained in Section 33 of Bylaw 2P80 and the Permitted and Discretionary Use Rules of the C-2 General Commercial District shall apply unless otherwise noted below.

a. Height

Maximum building height shall be two storeys not exceeding 6.5 metres at any eaveline.

b. Development Plans

Approval of this application does not constitute approval of a development permit. Comprehensive plans, including building design, site layout, exterior finishes and colour, landscaping, parking and accesses shall subsequently be submitted to the Approving Authorities as part of a development permit application.