

Amendment No. 2000/032
Bylaw No. 92Z2000
Council Approval: 24 July 2000

SCHEDULE B

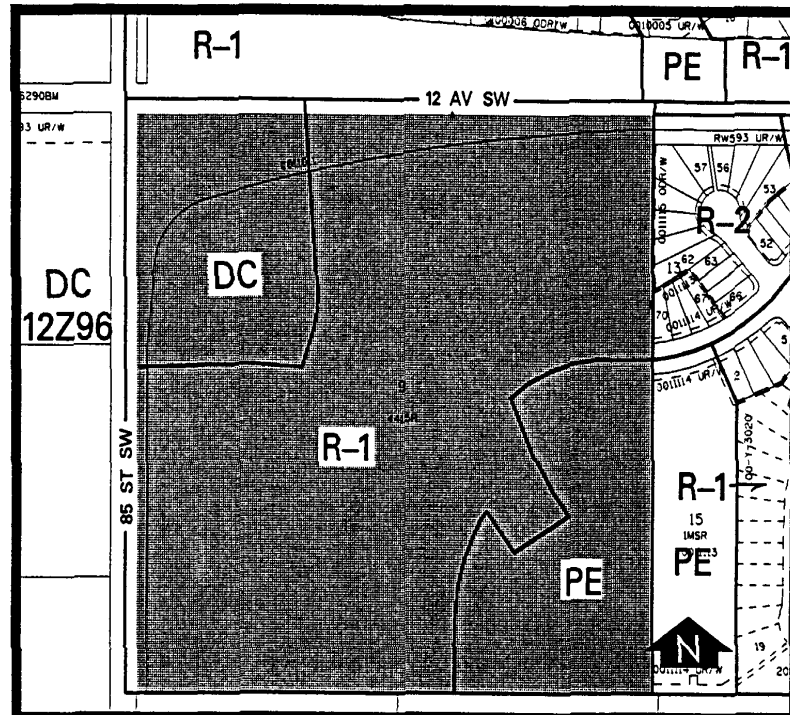

1. Land Use

The Permitted and Discretionary Uses of the R-2A Residential Low Density District of Bylaw 2P80 shall be the Permitted and Discretionary Uses respectively.

2. Development Guidelines

The General Rules for Residential Districts contained in Section 20 of Bylaw 2P80 and the Permitted and Discretionary Use Rules of the R-2A Residential Low Density Residential District shall apply unless otherwise noted.

(a) Density

A maximum of 30 units per hectare (12 units per acre) for a comprehensively designed townhouse project.

(b) Building Design

- (i) The design, character and appearance of the buildings shall be compatible with and complementary to the surrounding area.
- (ii) Where units back onto low density residential units the rear elevations of the units shall be compatible with the rear elevations of the low density residential units.
- (iii) The site plan and building design shall address massing, articulation, height, orientation and coverage.

(c) Amenity Spaces and Landscaping

A common amenity space shall be provided on site as part of the landscaping provision.

(d) Development Plans

Approval of this application does not constitute approval of a development permit. Comprehensive plans shall be submitted to the Approving Authority as part of a development permit application.