

Amendment # 2001/088
Bylaw # 113Z2001
Council Approval: 2001 October 01

SCHEDULE B

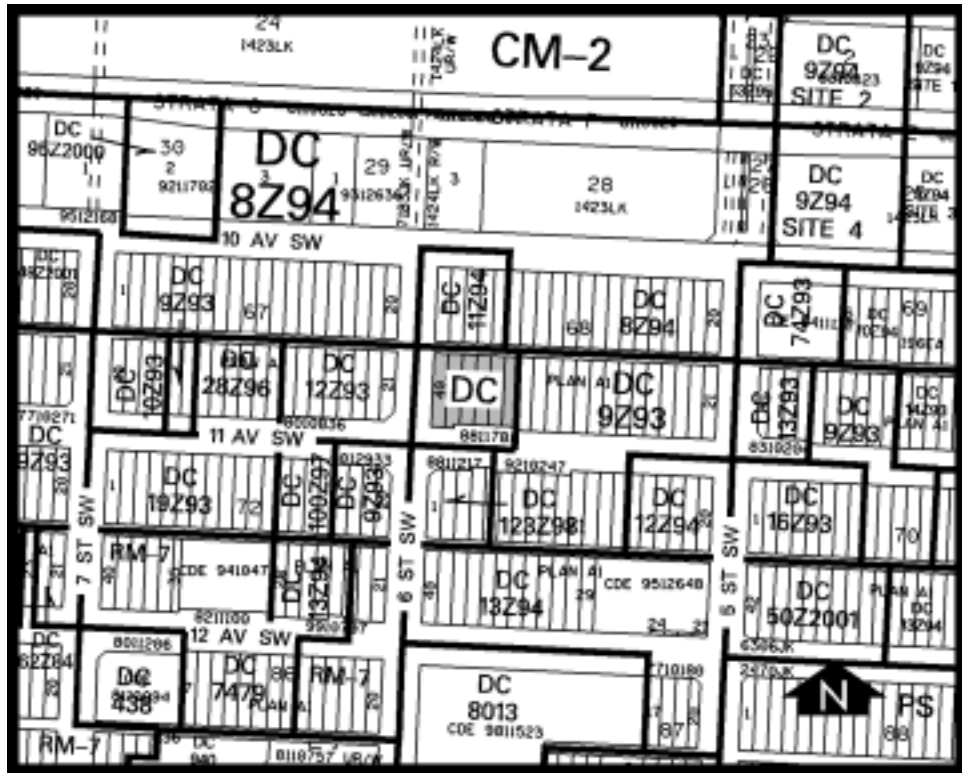

DC DIRECT CONTROL DISTRICT

1. Land Use

The Permitted and Discretionary Uses of the C-3 General Commercial District of Bylaw 2P80 shall be the Permitted and Discretionary Uses respectively.

2. Development Guidelines

The General Rules for Commercial Districts contained in Section 33 of Bylaw 2P80 and the Permitted and Discretionary Use Rules of the C-3 General Commercial District shall apply unless otherwise noted below:

(a) Dwelling Units

Where a comprehensive development plan proposes the integration of commercial and residential uses within a unit, Sections 37(5)(b)(i) and (ii) shall not apply.

(b) Landscaped Area and Amenity Space

The amount and location of landscaping and private amenity space shall be to the satisfaction of the Development Authority.

(c) Gross Floor Area

A maximum of 3.2 times the site area.